



High Park Road

Richmond, TW9

Asking Price £1,295,000

Beautifully presented, Period apartment with a 90ft private garden and outbuilding, moments from Kew Gardens station.

CHESTERTONS



High Park Road

Richmond, TW9

- Refurbished period conversion,
- Offering over 1,500 sq ft
- Versatile living space
- Moments from Kew Gardens station.



This immaculately presented home seamlessly blends character and contemporary design, with a wealth of period features complemented by a high-spec finish throughout. The first floor offers excellent entertaining space with a bright reception room, a separate dining room, and a well-appointed kitchen. The additional reception room provides flexibility and could easily serve as a third bedroom, home office, or snug.

Upstairs, there are two generous double bedrooms, both well-proportioned and filled with natural light, alongside stylish bathroom facilities. The master bedroom benefits from a large Juliet balcony with bi-fold windows overlooking the garden.

A standout feature of the property is the exceptional 90ft+ private garden — a rare find in this location — complete with a substantial outbuilding currently used as a gym, ideal for those seeking additional workspace or lifestyle space.

Further benefits include a share of freehold and a superb position within easy reach of Kew Village, the Royal Botanic Gardens, and excellent transport links via Kew Gardens Underground and Overground station.

Tenure: Share of Freehold 927 years 11 months
Service Charge: £1800
Ground Rent: £10
Local Authority: London Borough of Richmond upon Thames
Council Tax Band: D

Score	Energy rating	Current	Potential
92+	A		
81-91	B		
69-80	C		77 C
55-68	D	63 D	
39-54	E		
21-38	F		
1-20	G		

Chestertons Kew Sales

1 Royal Parade
 Kew
 Richmond
 TW9 3QD
 kew@chestertons.co.uk
 020 8104 0340
 chestertons.co.uk

High Park Road, Richmond, TW9

Approximate Area = 1416 sq ft / 131.5 sq m

Limited Use Area(s) = 232 sq ft / 21.5 sq m

Outbuilding = 188 sq ft / 17.4 sq m

Total = 1836 sq ft / 170.4 sq m

For identification only - Not to scale

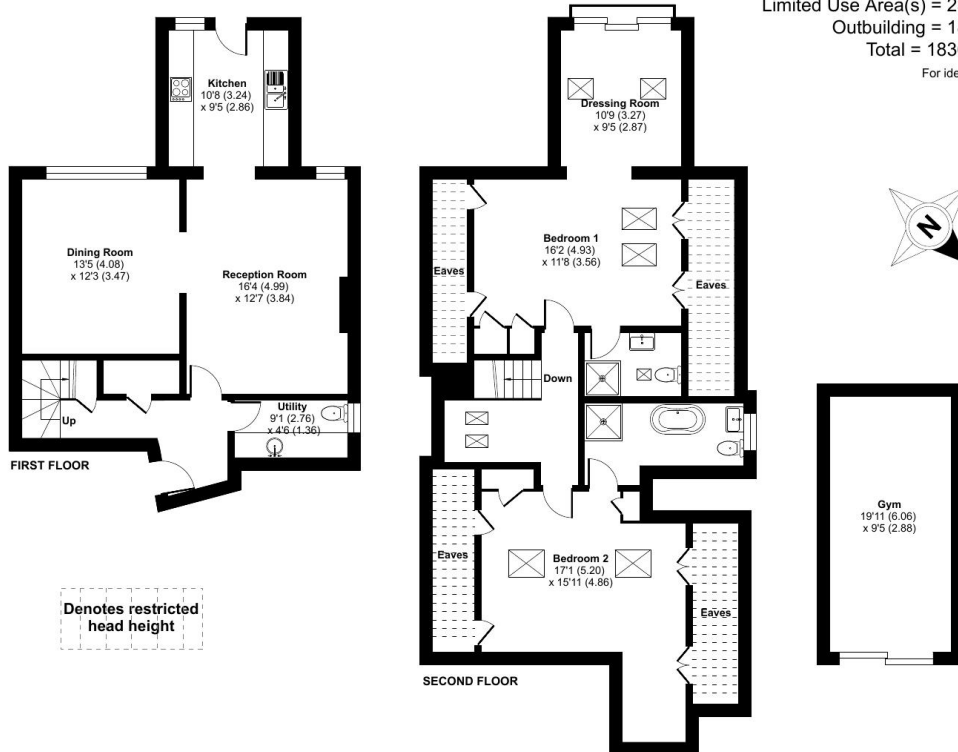

Floor plan produced in accordance with RICS Property Measurement 2nd Edition, Incorporating International Property Measurement Standards (IPMS2 Residential). © n1che.com 2026. Produced for Chestertons REF: 1440279

