

Bartholomews Square

HORFIELD

APPROXIMATE FLOOR AREA
39 SQM / 420 SQFT

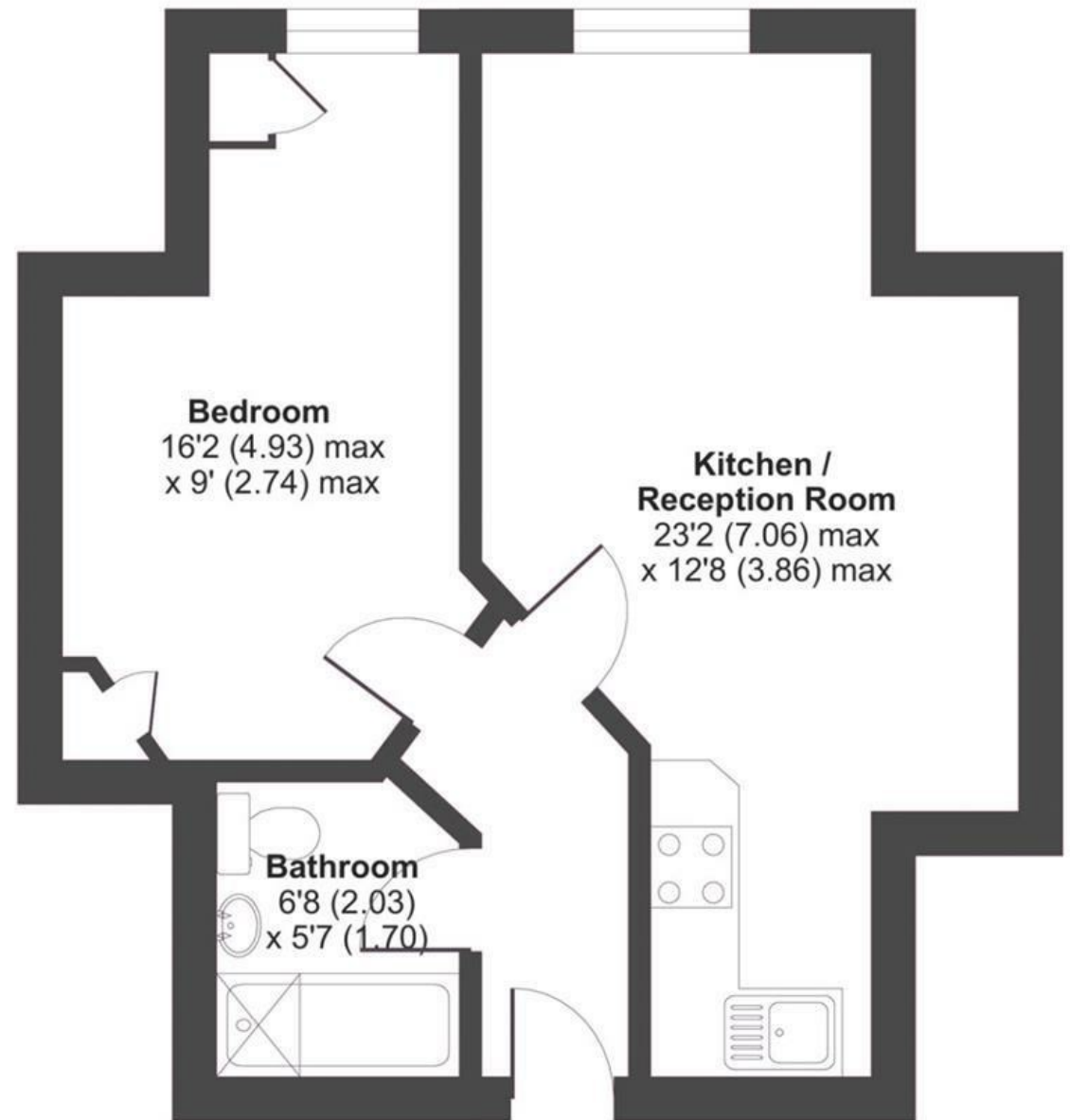

SECOND FLOOR

Bedroom
16'2 (4.93) max
x 9' (2.74) max

**Kitchen /
Reception Room**
23'2 (7.06) max
x 12'8 (3.86) max

Bathroom
6'8 (2.03)
x 5'7 (1.70)

~~Boardwalk~~

Bartholomews

HORFIELD, BRISTOL

£

£210,000



BS7 0QB

ZZZ

1 Bedrooms



1 Bathrooms

"Our favourite way to spend a Saturday morning is pottering down Gloucester Road for the best coffee in the city (MØD!), poking around in the incredible array of local shops before getting some brunch at Fed or Lonely Mouth. It's lovely and quiet, but we're also a stone's throw from some amazing pubs, like Inn on the Green and Draper's Arms, and eateries, such as Jean's Bistro, Nepali Chulo and Jinzu. On Sundays we take a walk up to the Ardagh Community Centre for a coffee and a sausage roll."

