



# Upper Street, Defford

Offers in the region of: £360,000

- Three double bedroom detached grade II listed character cottage
- Lounge with feature inglenook fireplace
- Separate dining room with French doors into the garden
- Kitchen with ample worktop space
- Utility room leading into the downstairs wet room
- Idyllic rural location with far reaching rear views to Bredon Hill
- Driveway and garage providing off road parking
- Generous South Easterly facing mature planted rear garden
- This property is in need of updating
- No onward chain

**Nigel Poole  
& Partners**

# Upper Street, Defford

Offers in the region of: £360,000

**\*\*OPPORTUNITY TO ACQUIRE A LOVELY GRADE II LISTED CHARACTER COTTAGE IN A QUIET VILLAGE LOCATION\*\*** Entrance door into the lounge greeted by feature inglenook and exposed beams through out the cottage; dining room with French doors into the rear garden. There is a utility room that leads into the wet room; kitchen with access to the garden. Three double bedrooms with the first bedroom having access into the second. The south easterly facing garden is a very generous size with a feature pond and mature planting benefitting from far reaching views to Bredon Hill. There is also access to the cellar from the garden. Drive with off road parking. Defford is an idyllic rural village surrounded by farmland with lovely country walks. It has a good primary school, public houses and St James Church. The village hall has become the focal point of the village being well used by local clubs and societies. The Millennium Green park is located close to the property and is owned by the village parish council.

## Front garden

Gated front with patio path leading to the side door. Laid to lawn; mature planted borders; access to brick built shed; gated side access; wall light.

## Lounge 14' 3" x 15' 1" (4.34m x 4.59m)

Window to the front aspect. Inglenook stone feature fireplace housing gas coal effect fire. Exposed beams; spot light fittings. Obscured door to the side aspect; doors leading to the utility room; dining room and kitchen.



## Dining Room 12' 0" x 12' 1" (3.65m x 3.68m)

French doors to the garden. Exposed beams; wall lights. Door to the lounge.

## Utility Room 2' 8" x 5' 8" (0.81m x 1.73m)

Window to the side aspect. Space and plumbing for stackable appliances. Pendant light fitting; doors to the lounge and shower room.

## Wet Room 7' 3" x 5' 8" (2.21m x 1.73m)

Window to the side aspect. Wall hung hand wash basin with mixer taps; vanity cabinet; low level w.c.; electric over head shower with extractor fan; part tiled walls. Door to utility.

## Kitchen 13' 4" x 10' 5" (4.06m x 3.17m)

Windows to the front and rear aspect. A range of wall and base units surmounted with laminate worktop; stainless steel sink with drainer and mixer taps; part tiled walls. Exposed beams; spot light fittings; linoleum flooring. Double glazed door to the garden; stairs rising to the first floor.



## Landing

Pendant light fitting; door to bedroom one and bedroom three.

## Bedroom One 14' 4" x 15' 1" (4.37m x 4.59m)

Window to the side aspect. Pendant light fitting; integrated wardrobe. Doors leading to bedroom two and the landing.

## Bedroom Two 12' 0" x 12' 0" (3.65m x 3.65m)

Window to the rear aspect. Pendant light fitting. Obscure glazed door to bedroom one.

## Bedroom Three 13' 5" x 7' 4" (4.09m x 2.23m)

Window to the rear aspect. Pendant light fitting.

## South Easterly Rear Garden

Secluded rear garden with far reaching views to Bredon hill. Predominately laid to lawn with feature pond with mature planting; patio seating area; raised planting beds. Access to cellar via out building and wooden shed. Gated side access to the front; tap; wall light.



## Workshop

13' 6" x 6' 8" (4.11m x 2.03m)

Window to the rear aspect. Door leading to the garden and garage.

## Garage

19' 5" x 17' 0" (5.91m x 5.18m)

Doors leading to the drive and workshop.

## Cellar

Tenure: Freehold

Council Tax Band: D

## Broadband and Mobile Information:

To check broadband speeds and mobile coverage for this property please visit: <https://www.ofcom.org.uk/phones-telecoms-and-internet/advice-for-consumers/advice/ofcom-checker> and enter postcode WR8 9BG



## Disclaimer

All measurements are approximate and for general guidance only. Whilst every attempt has been made to ensure accuracy, they must not be relied on. The fixtures, fittings and appliances referred to have not been tested and therefore no guarantee can be given and that they are in working order. Internal photographs are reproduced for general information and it must not be inferred that any item shown is included with the property. Whilst we carry out due diligence before launching a property to the market and endeavour to provide accurate information, buyers are advised to conduct their own due diligence. Our information is presented to the best of our knowledge and should not solely be relied upon when making purchasing decisions. The responsibility for verifying aspects such as flood risk, easements, covenants and other property related details rests with the buyer.

## Identity Checks

Estate Agents are required by law to conduct anti-money laundering checks on all those buying a property. We have partnered with a third part supplier to undertake these to ensure checks are HMRC compliant. The cost of these checks is £60 including VAT and is non-refundable. The charge covers the cost of obtaining relevant data, any manual checks and monitoring which may be required. This fee will need to be paid, and checks completed in advance of the issuing of a memorandum of sale.

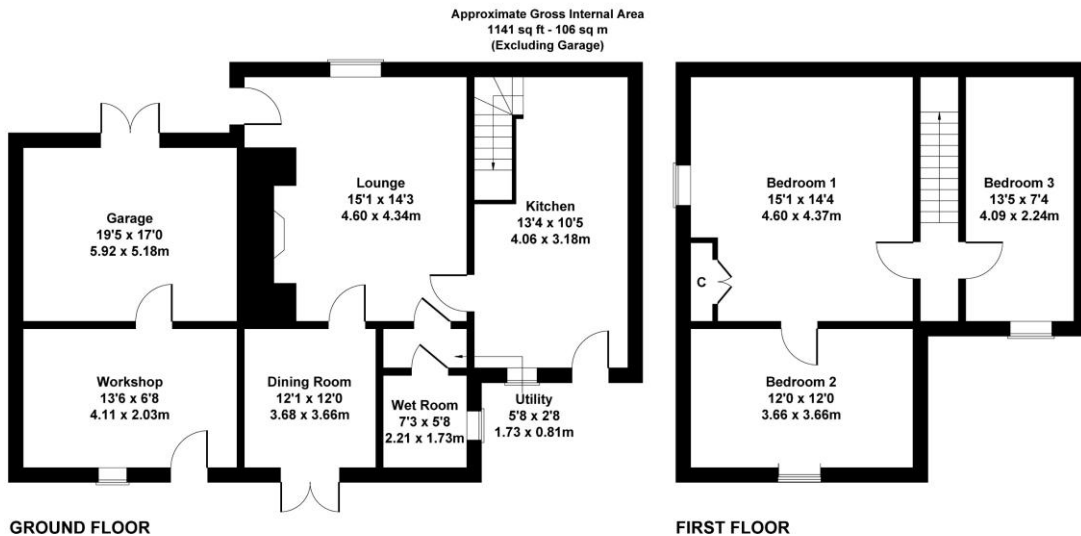

Not to Scale. Produced by The Plan Portal 2026  
For Illustrative Purposes Only.

Score	Energy rating	Current	Potential
92+	A		
81-91	B		
69-80	C		
55-68	D		62 D
39-54	E		
21-38	F	34 F	
1-20	G		

### MISREPRESENTATION ACT 1991

These particulars do not constitute, nor constitute part of, an offer or contract. Whilst every care is taken to ensure accuracy, no responsibility for errors or misdescription is accepted. Any intending purchaser must satisfy himself by inspection or otherwise as to the correctness of each of the statements contained in these particulars. The vendor does not make or give to Nigel Poole and Hancox as Agents, nor any employees of the Agents any authority to make or give representation or warranty whatever in relation to the property.



N446 Ravensworth 01670 713330