



**HENDERSON
CONNELLAN**
ESTATE AGENTS

Fox Street, Rothwell NN14

"A Stone's Throw Away..."

3 1 1



"A Stone's Throw Away..."

.....the heart of Rothwell is a moment away, this generous town house enjoys an ultra-convenient location close to local amenities, the A14 adding convenience. The interior is deceptively spacious and comprises entrance hall, living/dining room and fitted kitchen. There is a principal bathroom and three double bedrooms. Gas central heating and UPVC double glazing complete the inside. The private gardens are well kept and an excellent size. Call us to view today!

Living/Dining Room - 7.44m x 3.78m (24'5" x 12'5")

Kitchen - 3m x 2.39m (9'10" x 7'10")

Bathroom - 2.11m x 1.98m (6'11" x 6'6")

Bedroom One - 3.96m x 3.66m (13'0" x 12'0")

Bedroom Two - 3.61m x 2.62m (11'10" x 8'7")

Bedroom Three - 3.02m x 2.41m (9'11" x 7'11")



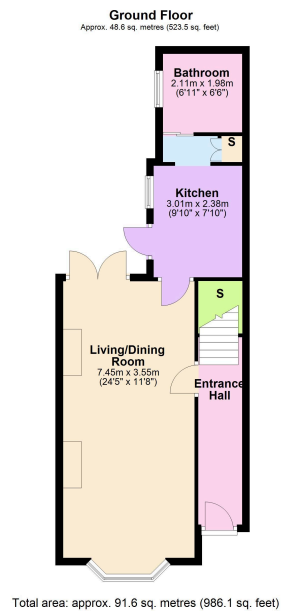

- Three Double Bedrooms
- Ultra-Convenient Location
- UPVC Double Glazed Windows
- EPC RATING: D
- Excellent Size
- Lovely Gardens
- Gas Central Heating
- COUNCIL TAX: A

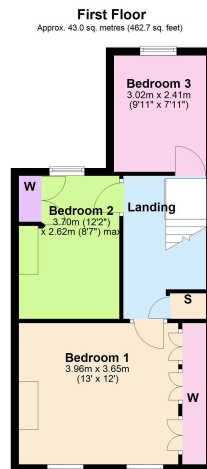

15-16 Market Place, Kettering,
Northamptonshire, NN16 0AJ

Disclaimer: These particulars do not form part of any offer or contract and should not be relied upon as statements or representations of fact. Any areas, measurements of distances are approximate. The text, photographs and plans are for guidance only and are not necessarily comprehensive.

