



SLOANE AVENUE, SW3

£475,000

- Share of Freehold
- Lift
- 24-Hour Porter
- Prime Chelsea
- Fabulous condition
- Fantastic Rental Investment

@marshandparsons
marshandparsons.co.uk

MARSH &
PARSONS



ABOUT THE PROPERTY

A lovely studio apartment presented in excellent condition within a portered building. Apartments such as this make ideal commercial ventures for either short term or long term rental strategies as well as being a perfect home or pied-à-terre. Residents of Nell Gwynn House benefit from a 24 hour porter service and close proximity to all the high end boutique shops and restaurants of Sloane Square, South Kensington and the King's Road. It is also located within walking distance of the Natural History Museum, the V&A, and the Science Museum, the property is ideally situated for culture lovers and professionals alike.



STEP INSIDE SLOANE AVENUE

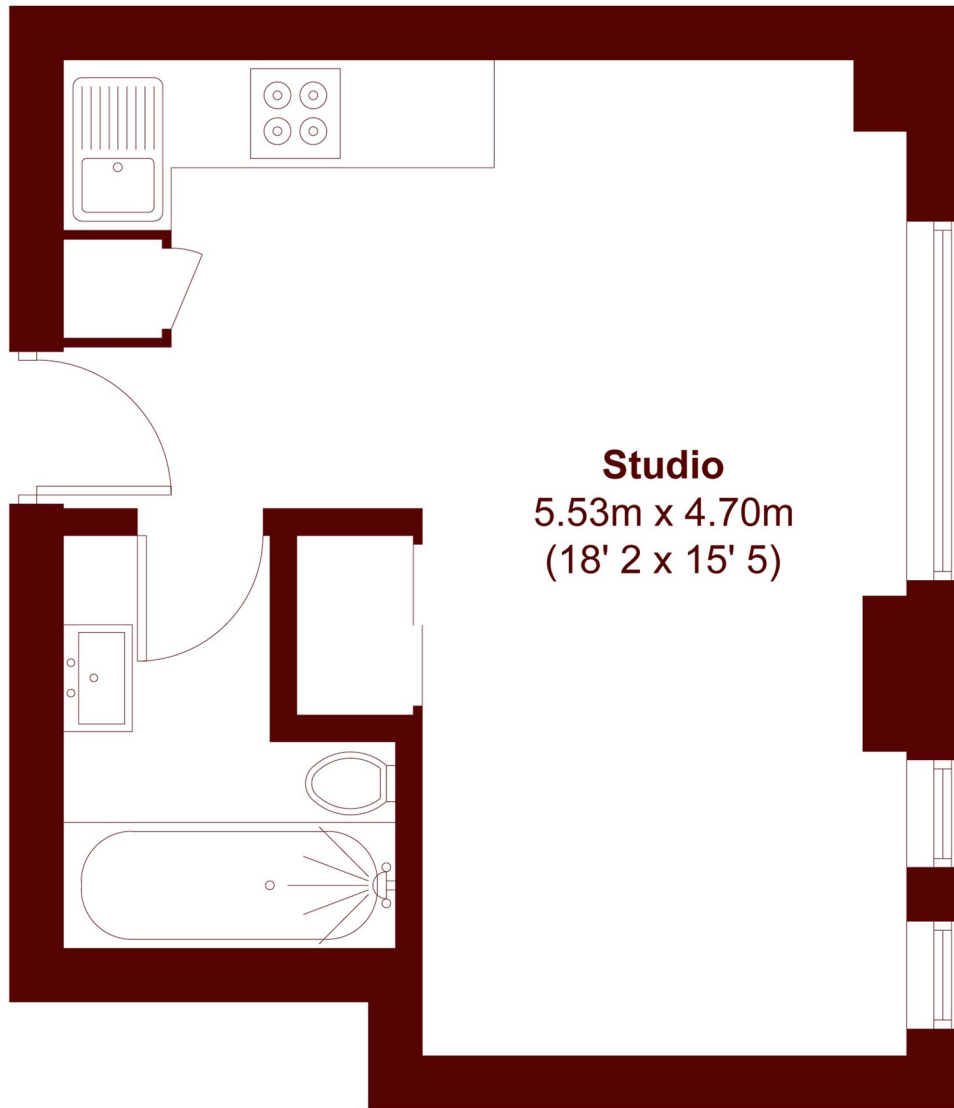

Studio
5.53m x 4.70m
(18' 2 x 15' 5)

Ground Floor

APPROX. GROSS INTERNAL FLOOR AREA
269 SQFT / 25 SQM

Chelsea
020 7591 5580

Energy Rating: We aim to make our particulars both accurate and reliable. However, they are not guaranteed; nor do they form part of an offer or contract. If you require clarification on any points then please contact us, especially if you're traveling some distance to view. Please note that appliances and heating systems have not been tested and therefore no warranties can be given as to their good working order

MARSH &
PARSONS