



22 Beaconsfield Street

, Bedford, MK41 7SD

£285,000



Floor Plan

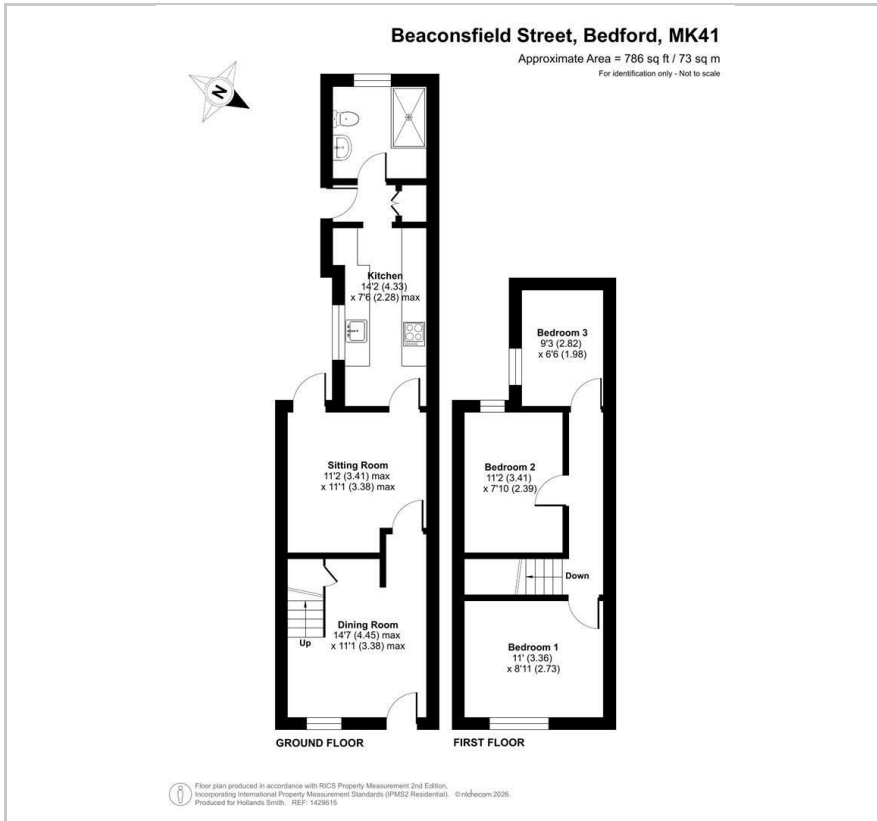

Area Map



Energy Efficiency Graph

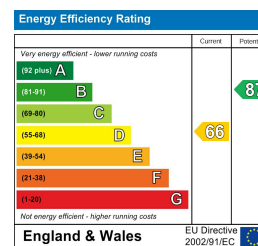

Viewing

Please contact our Bedford Office on 01234 216612 if you wish to arrange a viewing appointment for this property or require further information.

- Improved, Updated Terraced Home
- Extended Kitchen
- Enclosed, West Facing Garden
- uPVC Double GLazing
- Close to Bedford Park
- Three Bedrooms
- Ground Floor Shower Room
- Gas Radiator Heating
- No Onward Chain
- Walking Distance of Town & Rail Station



Recently improved and updated, this period terraced cottage is conveniently located for the town centre and within a short walk of Bedford Park, swimming pool and leisure complex. The accommodation provides three bedrooms and two separate living rooms. The kitchen has been extended and refitted with modern units, natural wooden worktops and a built-in oven and hob. The shower room includes a large shower cubicle and contemporary fittings. There is gas radiator heating and replaced uPVC double glazing throughout. Outside, the paved, courtyard garden enjoys a sunny, west facing aspect.

Council Tax Band: B EPC Rating: D

Available with no onward chain, this period home is conveniently located for the town centre and is within comfortable walking distance of the rail station. - there is a fast link into London's St Pancras. The popular 'Prime Ministers' area of the town features two convenience stores, popular pubs and a coffee house/bakery.



163 Castle Road, MK40 3RT

Tel: 01234 216612

www.hollandsmith.co.uk