



FISHER
ESTATES

Quayside Drive, Colchester, CO2 8GT

£1,100PCM (Deposit: £1,269)

🛏️ 2 🚿 2 🛋️ 1



- Two Bedrooms
- Close To The University of Essex
- Large Balcony
- Modern Fitted Kitchen
- Two Bathrooms
- Close to Hythe Station

Tax Band: C Furnished: Unfurnished

Beautifully presented two-bedroom apartment situated in the sought-after Quayside Drive development, offering spacious accommodation and excellent access to Hythe station, Colchester town centre, and the University of Essex.

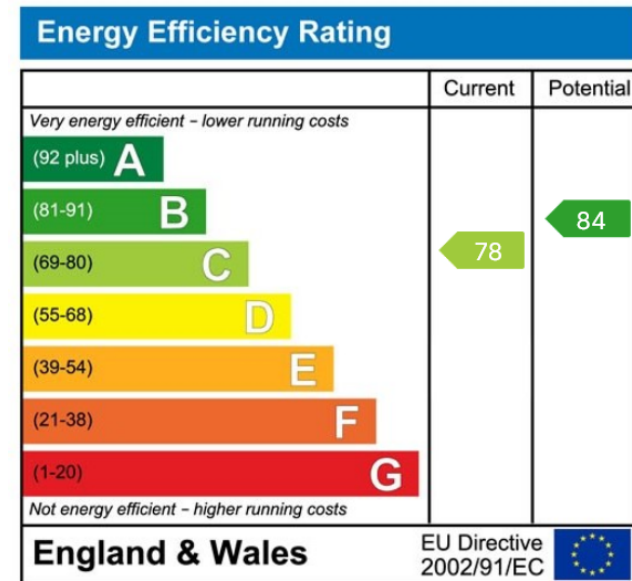
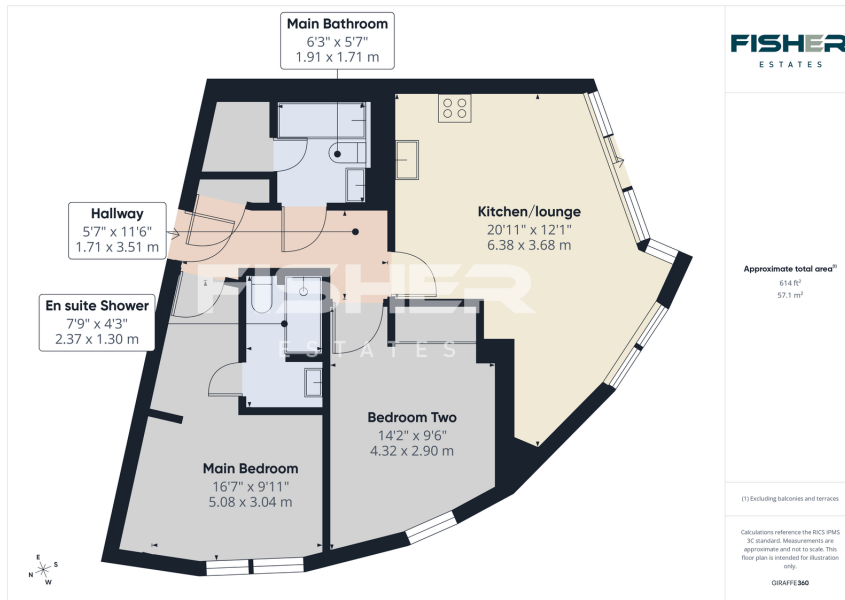

COLCHESTER 01206 480008 | BRAINTREE 01376 343777 | TAKELEY 01279 808707 | BISHOP STORTFORD 01279 808708

ENQUIRES@FISHERESTATES.CO.UK | LETTINGS@FISHERESTATES.CO.UK

WWW.FISHERESTATES.CO.UK