



4 Carlton Court
Castor PE5 7DB
£1,245 Per month



4 Carlton Court

Castor PE5 7DB

Located within the highly desirable location of Castor, is this brilliant two bedroom semi detached bungalow in Carlton Court. In brief, the accommodation comprises, entrance hallway with two built in storage cupboards and doors to all rooms, re-carpeted lounge/diner and access to conservatory. Re-fitted shower room with double walk in shower tray, re-fitted kitchen area with eye level cooker, induction hob and plumbing for washing machine. Both bedrooms have been re-carpeted and there is built in storage to the main bedroom and double glazed window to the rear garden and field behind. Outside; the garden is mainly laid to lawn with patio area and side access back around to the front of the bungalow which itself provides a low level wrap around bush and continues towards the garage. Properties in Castor are not available everyday and a viewing is highly recommended on this lovely bungalow.





Entrance Hallway

Lounge/Diner - 3.75m x 4.17m (12'3" x 13'8")

Re-Fitted Kitchen - 3.51m x 2.26m (11'6" x 7'4")

Re-Fitted Shower Room



Bedroom One - 3.75m x 3.02m (12'3" x 9'10")

Bedroom Two - 2.77m x 2.01m (9'1" x 6'7")

Conservatory - 1.75m x 3.07m (5'8" x 10'0")

Outside

Garden

Garage



Floor Plan

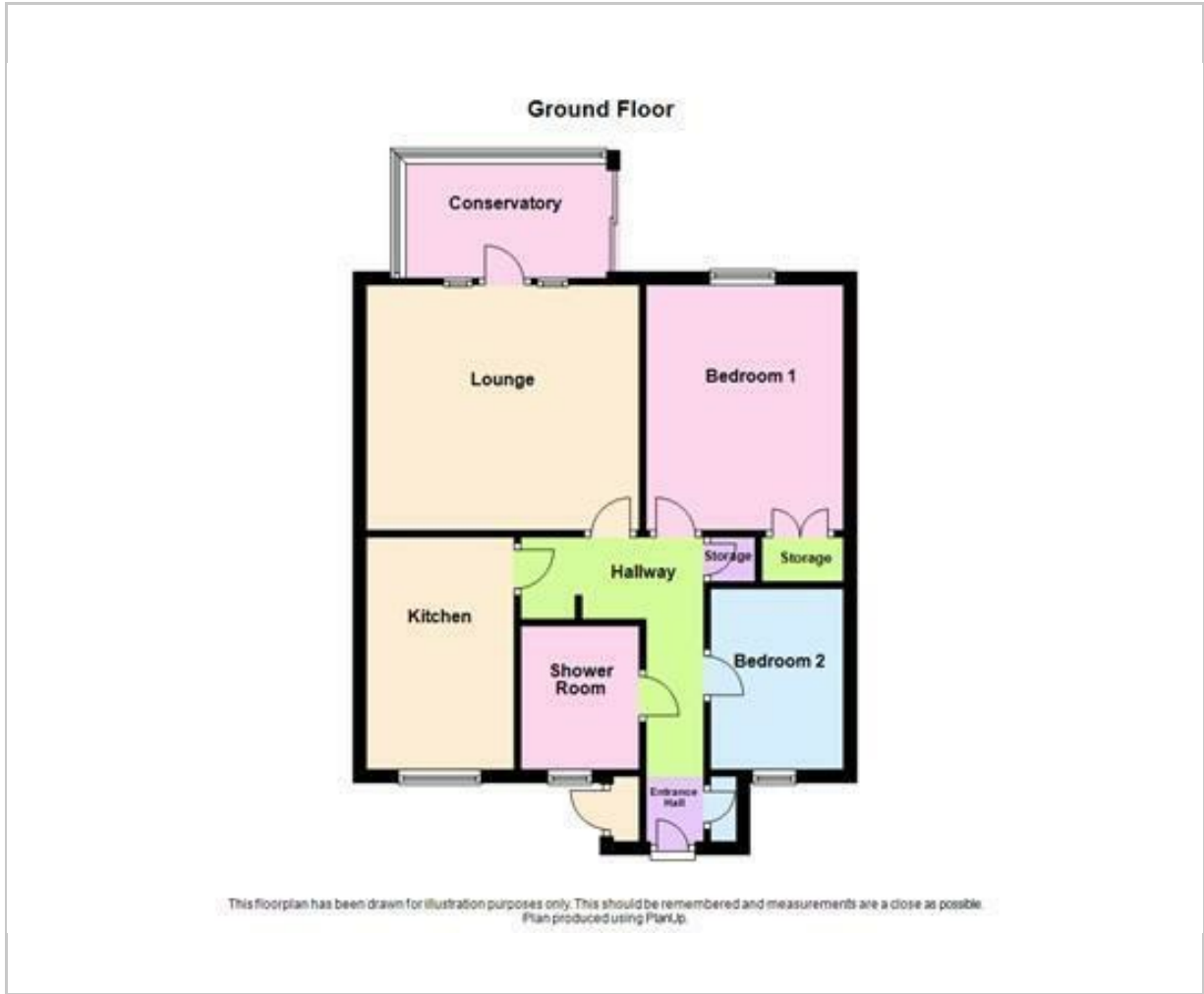

Viewing

Please contact our Lettings Office on 01733 973673 if you wish to arrange a viewing appointment for this property or require further information.

These particulars, whilst believed to be accurate are set out as a general outline only for guidance and do not constitute any part of an offer or contract. Intending purchasers should not rely on them as statements of representation of fact, but must satisfy themselves by inspection or otherwise as to their accuracy. No person in this firms employment has the authority to make or give any representation or warranty in respect of the property.



381 Eastfield Road,
Peterborough, PE1 4RA
T: 01733 973673
E: lettings@firminandco.co.uk

Area Map



Energy Efficiency Graph

