

Jeymer Drive

Approximate Gross Internal Area
Ground Floor = 59.54 sq m / 641 sq ft
First Floor = 40.52 sq m / 436 sq ft
Total = 100.06 sq m / 1077 sq ft

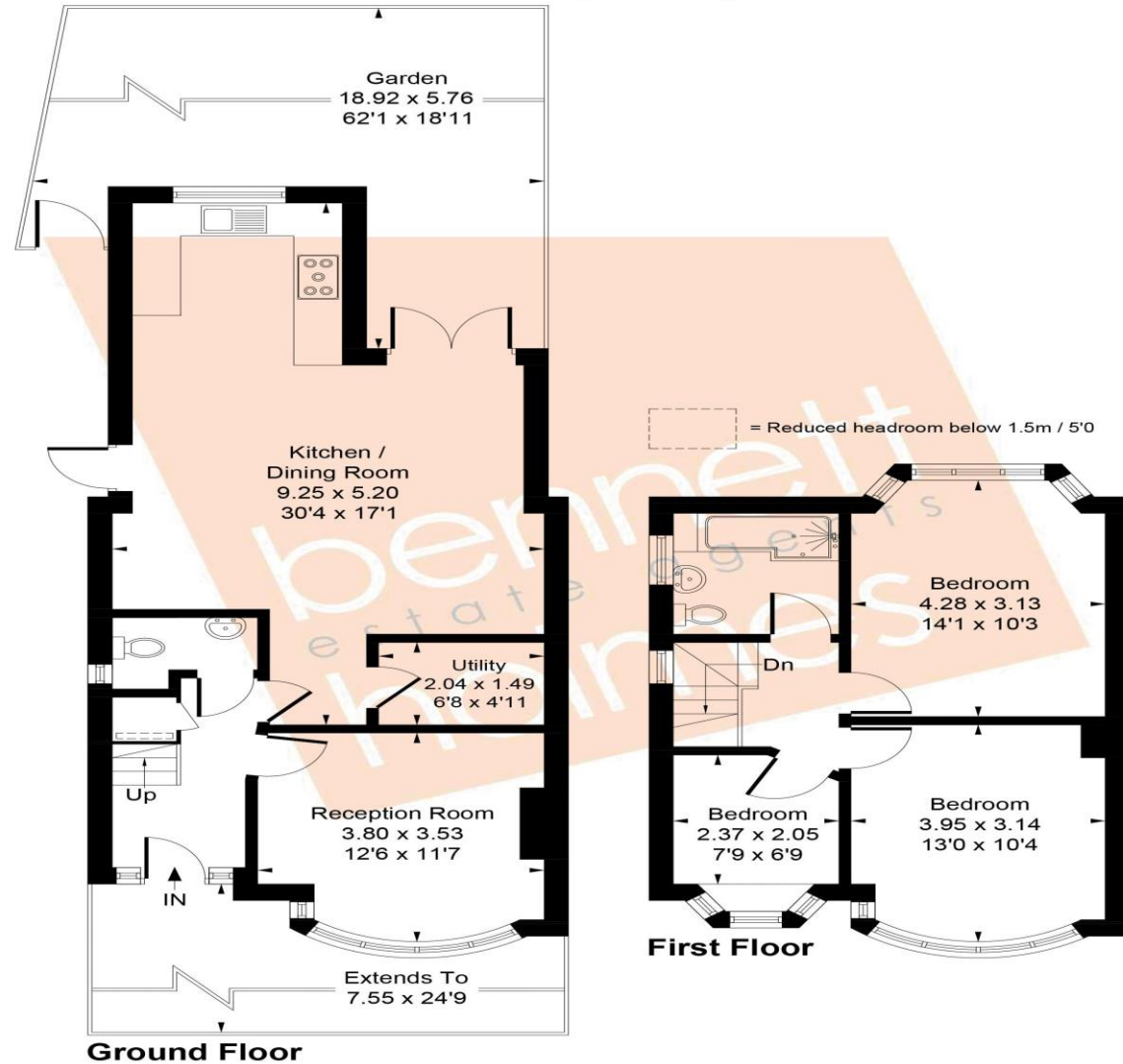

Whilst every attempt has been made to ensure the accuracy of the floor plan contained here, measurements of doors, windows, rooms and any other items are approximate and no responsibility is taken for any error, omission, or mis-statement. This plan is for illustrative purposes only and should be used as such by any prospective purchaser.
© Vizion Property Marketing Produced for Bennett Holmes Estate Agents.

Freehold
Borough of Ealing
Council Tax Band D- £2,138.53
EPC- C

NORTHOLT OFFICE

83 Oldfields Circus Northolt, Middlesex UB5 4RU

sales: 020 8423 2222 lettings: 020 8423 0222

northolt@bennetholmes.com

IMPORTANT Bennett Holmes would inform prospective purchasers that these sales particulars have been prepared as a general guide only. A detailed survey has not been carried out, nor the services, appliances and fittings tested. Room sizes should not be relied upon for furnishing purposes and are approximate. If floor plans are included, they are for guidance only and illustration purposes only and may not be to scale. If there are any important matters likely to affect your decision to buy, please contact us before viewing the property.

Jeymer Drive Greenford UB6 8NS

Price Guide: £650,000



Bennett Holmes are pleased to offer this extended, three bedroom semi detached house situated on a residential road in Greenford. The property is located within 0.4 miles to Greenford's Central line tube station and shopping facilities. Local bus routes, local schools and the A40 are also close by. Other benefits include a rear extension, modern kitchen and bathroom, a downstairs WC, utility room, two reception rooms, gas central heating and double glazing. There is scope to extend the property STPP.



- THREE BEDROOMS
- SEMI DETACHED
- EXTENDED
- TWO RECEPTION ROOMS
- OPEN PLAN KITCHEN/ DINER
- POTENTIAL TO EXTEND THE PROPERTY FURTHER STPP.
- OFF STREET PARKING
- 0.4 MILES TO GREENFORD TUBE STATION

**Jeymer Drive
Greenford
UB6 8NS**

Price Guide: £650,000



Accommodation

The accommodation briefly comprises a front door opening to the entrance hall with doors to the front reception room, downstairs WC and the rear reception room. The extended rear reception room has a door to a utility room, double glazed patio doors to the rear garden, a side door to the side of the property and is open plan with the extended kitchen/ diner. The modern kitchen is fitted with wall and base level units, a gas range cooker point with an overhead extractor hood, plumbing for a dishwasher and space for a fridge/ freezer. Stairs lead up to the first floor landing with doors to three bedrooms and the modern bathroom. There are two double bedrooms and one single bedroom.

Outside the property are front and rear gardens. The rear garden measures approx. 62 ft and is mainly laid to lawn with a patio area.

