



6 Jubilee Place, Clevedon, BS21 5EA

£385,000

Steven
Smith



Imagine a life where morning strolls along the scenic Land Yeo riverbank paths or afternoons exploring Clevedon's iconic Victorian pier and vibrant independent cafés are just part of your daily routine. Perfectly placed, this beautifully presented semi detached home offers the ultimate blend of coastal town charm and modern family convenience. You are just moments away from highly regarded local primary schools, bustling supermarkets, and the relaxed, community focused lifestyle that makes Clevedon so special. Step inside to discover a deceptively spacious, light filled haven designed for effortless living and entertaining. The ground floor welcomes you with a cozy sitting room, alongside a highly versatile fourth bedroom or study, complete with its own luxury en suite, making it ideal for guests or working from home. The true heart of the house is the spectacular, high quality kitchen diner, where large windows create a bright, airy atmosphere perfect for family meals and hosting friends. Upstairs, three further well proportioned bedrooms and a contemporary family bathroom provide a peaceful retreat for everyone. The lifestyle seamless extends outdoors. The secure, enclosed rear garden is a low maintenance oasis, thoughtfully designed with a mix of artificial lawn, a sun soaked patio and decking, perfect for alfresco dining, weekend barbecues, or safe children's

play. Out front, a driveway provides ample off street parking. Whether you are taking your first step onto the property ladder or looking for that perfect upgrade for your growing family, this exceptional Clevedon home promises a lifestyle you will love.

Accommodation (all measurements approximate)

GROUND FLOOR Front door opens to porch, door opens to:

Sitting Room 16'4" max 12'8" min x 14'9"

Measurements include stairs to first floor. Window to front, wood effect floor, with underfloor heating. Opening to:

Bedroom 4/Study 15' 8" x 7' 8" (4.77m x 2.34m)

Window to front, wood effect floor, with underfloor heating, door opens to:

En suite

Simply stunning! 3 piece suite of wc, wash hand basin and shower cubicle. All with modern fittings, fulling tiled walls and floor, obscure window.

Kitchen Diner 18' 1" max 16'6" min x 14' 4" (5.51m x 4.37m)

An absolute outstanding room. Fitted with a range of high gloss wall and base units with working surfaces, sink with mixer tap, integrated appliances to include washing machine and dishwasher, electric oven with microwave above, five ring gas hob

and extractor hood. Space for fridge/freezer. Lovely centre island also used as a breakfast bar. Access to a storage cupboard/pantry, further access to the gas boiler. Tiled splashbacks, wood effect floor, window to rear garden. Spotlights and skylight. Double doors open to the garden.

FIRST FLOOR

Landing. Access to loft space.

Bedroom 1 14' 11" x 8' 0" (4.54m x 2.44m)

Two windows to front.

Bedroom 2 8' 11" x 6' 8" (2.72m x 2.03m)

Window overlooking the rear garden.

Bedroom 3 7' 10" x 7' 4" (2.39m x 2.23m)

Window to rear.

Bathroom

White suite of WC, washhand basin, bath with shower over, partially tiled walls.

OUTSIDE

From Jubilee Place a driveway provides off road parking and to the front of the house a stone shingle area provides further parking. There is then access to the front door.

Rear Garden

Is laid to lawn with two patio areas and access to a garden shed, there is also an outside water tap.







GROUND FLOOR

1ST FLOOR

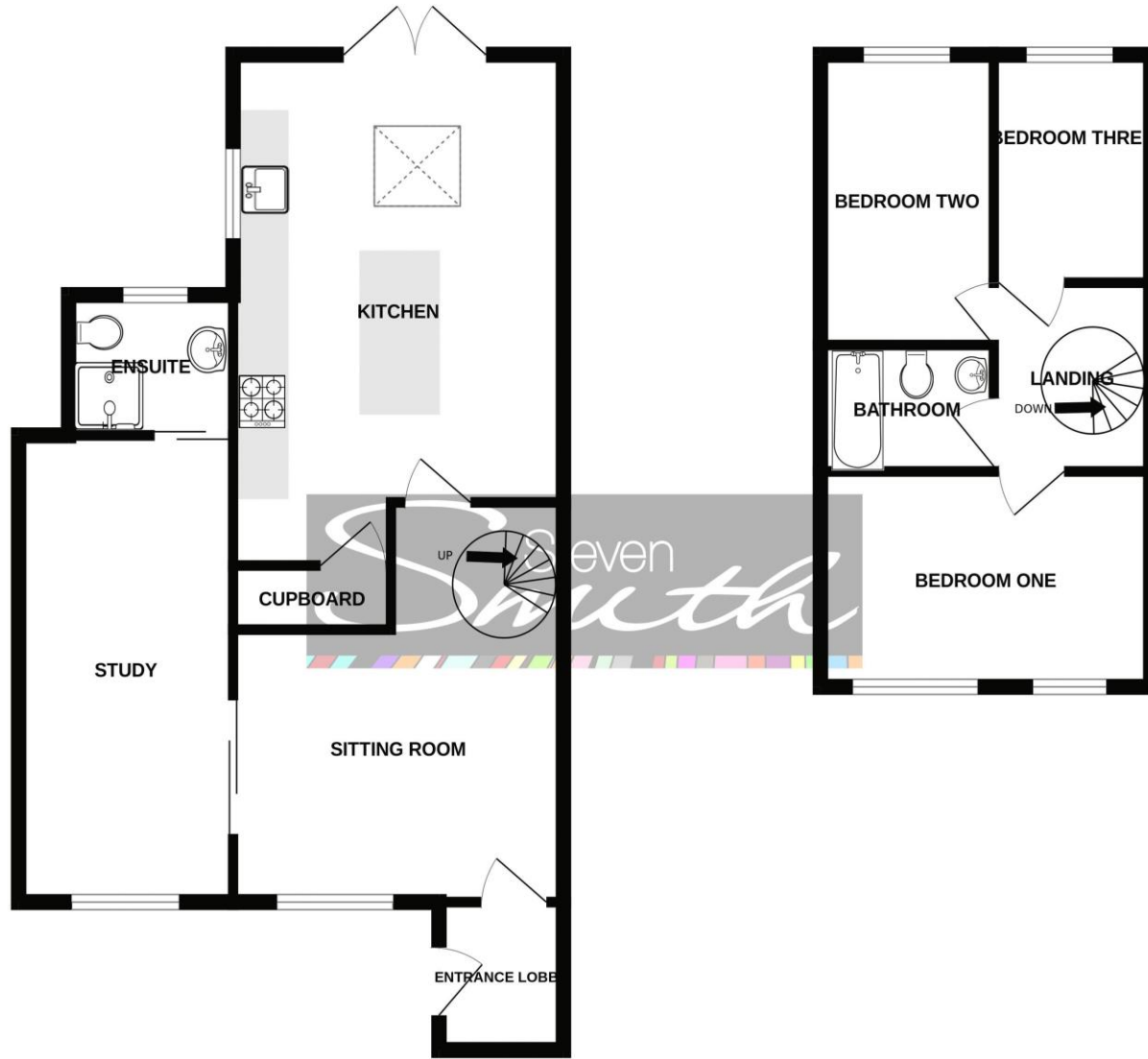

Semi Detached House



Freehold



4



Lovely Garden



2



C



1

EPC

C



Gas Central Heating



Off Street Parking

Whilst every attempt has been made to ensure the accuracy of the floorplan contained here, measurements of doors, windows, rooms and any other items are approximate and no responsibility is taken for any error, omission or mis-statement. This plan is for illustrative purposes only and should be used as such by any prospective purchaser. The services, systems and appliances shown have not been tested and no guarantee as to their operability or efficiency can be given.
Made with Metropix ©2026





Health & Safety Statement

We would like to bring to your attention the potential risks of viewing a property that you do not know. Please take care as we cannot be responsible for accidents that take place during a viewing.

Please Note

Items shown in photographs are not included unless specifically mentioned within the sales particulars, they may be available by separate negotiation. Any services, heating systems, appliances or installations referred to in these particulars have not been tested and no guarantee can be given that these are in working order. The photographs have been taken using a wide angle lens.

A: 12 The Triangle, Clevedon, North Somerset BS21 6NG
T: 01275 877771 W: stevensmithhomes.co.uk
E: steven@stevensmithhomes.co.uk FB: [@stevensmithhomes](https://www.facebook.com/stevensmithhomes)



Steven Smith Town & Country Estate Agents Ltd. Registered Address: 12 The Triangle, Clevedon, North Somerset BS21 6NG. Registration Number: 7177353. Registered in England & Wales

