



Disclaimer

These particulars, whilst believed to be accurate are set out as a general outline only for guidance and do not constitute any part of an offer or contract. Intending purchasers should not rely on them as statements or representation of fact, but must satisfy themselves by inspection or otherwise as to their accuracy. We have not carried out a detailed survey nor tested the services, appliances and specific fittings. Room sizes should not be relied upon for carpets

and furnishings. The measurements given are approximate. No person in this firms employment has the authority to make or give any representation or warranty in respect of the property.

Daniel Brewer

51 High Street  
Great Dunmow  
Essex, CM6 1AE

Telephone • 01371 856585  
Website • www.danielbrewer.co.uk  
E-mail • info@danielbrewer.co.uk

THE DOWNS, DUNMOW  
OFFERS OVER £780,000





THE DOWNS  
DUNMOW  
ESSEX  
CM6 1FX

\*\*\*No Onward Chain\*\*\* Located on a private road in the centre of the thriving market town of Great Dunmow is this substantial five bedroom detached family home. The ground floor accommodation comprises:- living room, kitchen/dining room, dining room, utility room, cloakroom and entrance hall. On the first floor are three double bedrooms with two en-suites and a family bathroom. The second floor boasts a further two bedrooms and store room. Externally the property boasts a single garage with driveway parking for multiple vehicles and an established rear garden.

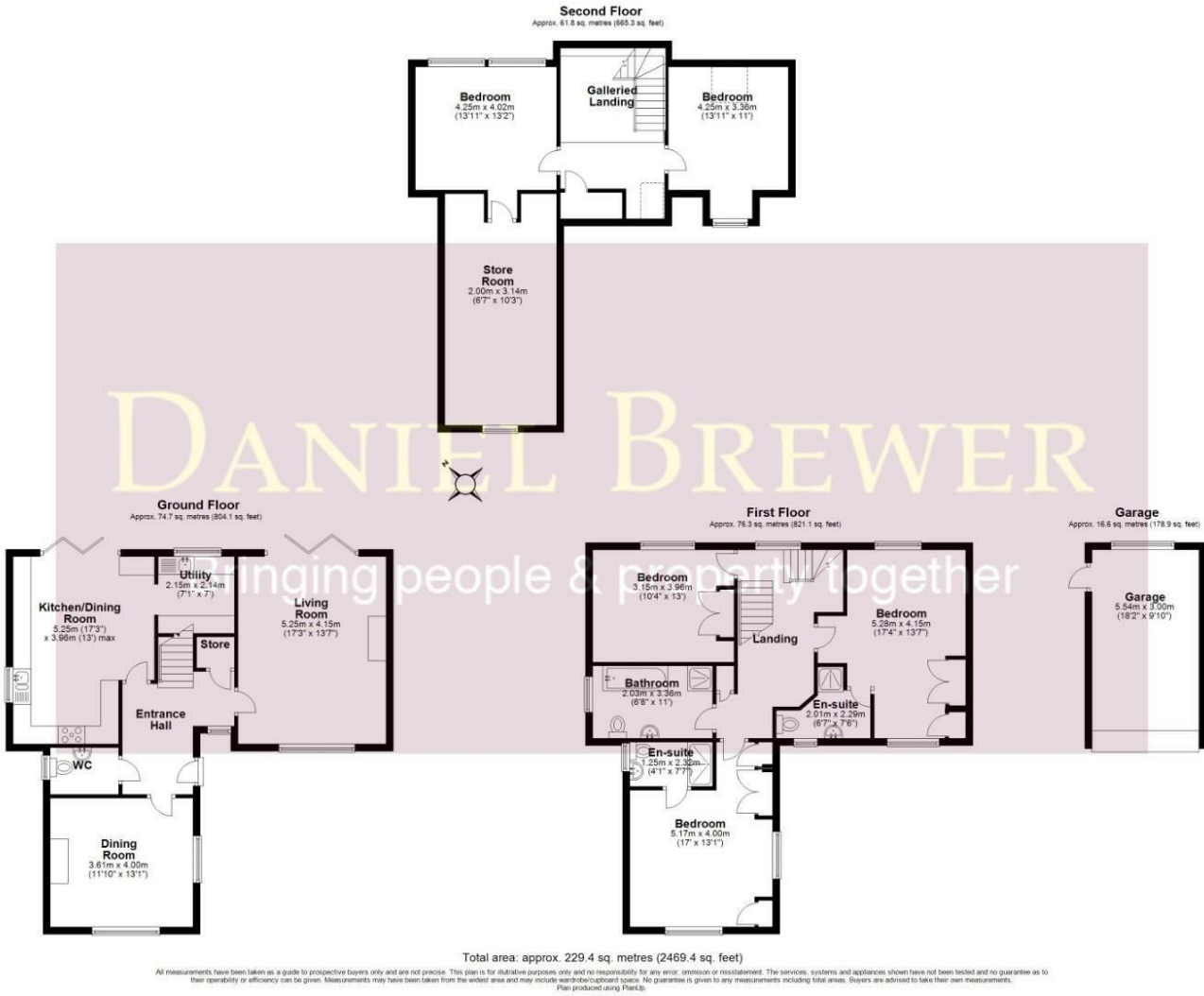





**Store Room**

UPVC double glazed window to front aspect, lighting, power points.

**Bedroom Five**

13'11" x 11' (4.24m x 3.35m)  
UPVC double glazed window to front aspect, Velux window to rear aspect, radiator, power points, exposed floorboards.

**Single Garage With Driveway Parking**

To the side of the property is a single garage with up & over door, UPVC double glazed window to rear aspect, power, lighting, pitched roof for storage and single door to side aspect. To the front of the property is a block paved driveway providing parking for multiple vehicles. The driveway is bordered by a variety of mature shrub borders. External power points to the front.

**Established Rear Garden**

To the rear of the property is a raised patio area with steps leading to the remainder lawn with a variety of mature shrubs & trees. Two electric awnings are mounted to the rear of the property. Side access is granted via a timber gate with a paved pathway leading to the rear garden. The garden further benefits from external power points and tap.

- Five Double Bedrooms
- Detached Family Home
- Single Garage With Driveway Parking
- Established Rear Garden
- No Onward Chain
- Two Receptions
- Kitchen/Dining Room
- Utility Room & Cloakroom
- Two En-Suites & Family Bathroom
- Private Road Location

**Entrance Hall**

UPVC double glazed window to front aspect, solid wood flooring, radiator, power points, built-in storage cupboard, stairs rising to the first floor landing, doors to.

**Cloakroom**

UPVC double glazed opaque window to side aspect, W.C, wash hand basin with pedestal, radiator, tiled flooring.

**Living Room**

17'3" x 13'7" (5.26m x 4.14m)  
UPVC double glazed window to front aspect, feature fireplace with stone surround, solid wood flooring, one radiator, T.V point, power points, Bi-folding doors leading to the rear garden.

**Kitchen/Dining Room**

17'3" x 13' (5.26m x 3.96m)  
UPVC double glazed window to side aspect, base and eye level units with complimentary working surfaces over, five ring gas hob with extractor over, inset double oven, integrated dishwasher, space for American style fridge/freezer, inset sink with drainer unit, radiator, tiled flooring, power points, opening to.

**Utility Room**

71" x 7' (2.16m x 2.13m)  
UPVC double glazed window to rear aspect, base and eye level units with complimentary working surfaces over, space for washing machine, space for tumble dryer, space for wine cooler, tiled flooring, extractor fan, power points.

**Dining Room**

13'1" x 11'10" (3.99m x 3.61m)  
UPVC double glazed windows to multiple aspects, feature fireplace with stone surround and inset multifuel burning stove, radiator, power points, solid wood flooring.

**First Floor Landing**

UPVC double glazed window to rear aspect, radiator, power points, built-in airing cupboard, stairs rising to the first floor landing, doors to.







**Principal Bedroom**  
17' x 13'1" (5.18m x 3.99m)  
UPVC double glazed windows to multiple aspects, built-in wardrobes, exposed floorboards, radiator, power points, T.V point, door to.

**En-Suite**  
UPVC double glazed opaque window to side aspect, enclosed shower with glass enclosure, wash hand basin with pedestal, W.C, heated towel rail, fully tiled, extractor fan.

**Bedroom Two**  
17'4" x 13'7" (5.28m x 4.14m)  
UPVC double glazed windows to multiple aspects, built-in wardrobes, exposed floorboards, radiator, power points, T.V point, door to.

**En-Suite**  
UPVC double glazed opaque window to front aspect, enclosed shower cubicle with glass enclosure, W.C, wash hand basin with pedestal, heated towel rail, extractor fan.

**Bedroom Three**  
13' x 10' (3.96m x 3.05m)  
UPVC double glazed window to rear aspect, built-in wardrobes, radiator, power points, exposed floorboards.

**Family Bathroom**  
UPVC glazed Opaque window to side aspect, enclosed bath with mixer taps & shower attachment, enclosed shower with glass enclosure, W.C, wash hand basin with pedestal, part tiled walls, tiled flooring,

**Galleried Landing**  
Velux window to front aspect, built-in storage cupboard, power points, doors to.

**Bedroom Four**  
13'11" x 13'2" (4.24m x 4.01m)  
Two Velux windows to rear aspect, radiator, power points, exposed floorboards, door to.

