



Hartfield Road, SW19

£750,000

A three bedroom, two bathroom exceptionally well refurbished Victorian conversion. Occupying the entire ground floor, complete with super ceiling heights, a private south west facing rear garden with a shed and garden room.

Hartfield Road is centrally located in Wimbledon with immediate access to South West Rail, District Line and Northern Line links Wimbledon Broadway offers a wide range of bars, restaurants and shopping.

Features

- Three Double Bedrooms
- Two Bathrooms
- No Onward Chain
- Ground Floor Conversion
- Central Location
- Share Of Freehold

Hartfield Road,
London, SW19

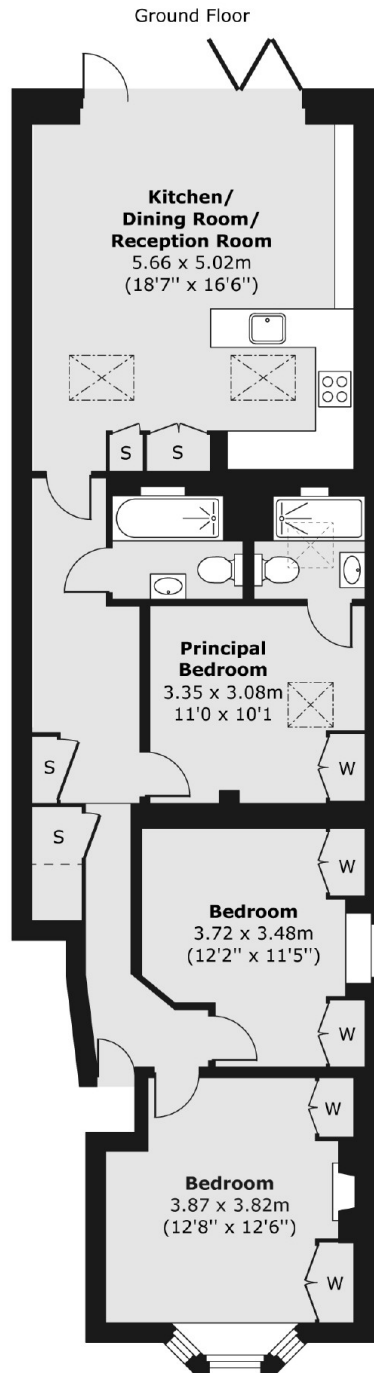

Total area (approx.) 88.15 sq. m (949 sq. ft)

Dexters

Wimbledon
12 The Broadway
London
SW19 1RF
Sales
020 8545 8580

Energy Rating: C. We aim to make our particulars both accurate and reliable. However they are not guaranteed; nor do they form part of an offer or contract. If you require clarification on any points then please contact us, especially if you're traveling some distance to view. Please note that appliances and heating systems have not been tested and therefore no warranties can be given as to their good working order.

 **RICS** | Regulated
Estate Agent
and Letting Agent

dexters.co.uk