



36 Birdwood Avenue, Dartford, DA1 5GB
£210,000



36 Birdwood Avenue, Dartford, DA1 5GB

£210,000

Nestled in the desirable area of Birdwood Avenue, Dartford, this purpose-built flat offers a perfect blend of modern living and convenience. Spanning an impressive 775 square feet, the property boasts a well-designed layout that includes one inviting reception room, two comfortable bedrooms, and two contemporary bathrooms, making it an ideal choice for couples, small families, or professionals seeking a stylish home.

Constructed in 2007, the flat benefits from modern fixtures and fittings, ensuring a comfortable and low-maintenance lifestyle. The spacious reception room serves as a welcoming area for relaxation and entertaining, while the two bedrooms provide ample space for rest and privacy. The presence of two bathrooms adds to the convenience, catering to the needs of busy households.

Additionally, the property includes parking for one vehicle.

This property will be legally prepared enabling any interested buyer to secure the property immediately once their bid/offer has been accepted. Ultimately a transparent process which provides speed, security and certainty for all parties.

Auctioneers Additional Comments

Description

Nestled in the desirable area of Birdwood Avenue, Dartford, this purpose-built flat offers a perfect blend of modern living and convenience. Spanning an impressive 775 square feet, the property boasts a well-designed layout that includes one inviting reception room, two comfortable bedrooms, and two contemporary bathrooms, making it an ideal choice for couples, small families, or professionals seeking a stylish home.

Constructed in 2007, the flat benefits from modern fixtures and fittings, ensuring a comfortable and low-maintenance lifestyle. The spacious reception room serves as a welcoming area for relaxation and entertaining, while the two bedrooms provide ample space for rest and privacy. The presence of two bathrooms adds to the convenience, catering to the needs of busy households.

Additionally, the property includes parking for one vehicle.

This flat on Birdwood Avenue is not just a place to live; it is a home that offers comfort, style, and practicality in a sought-after location. Whether you are looking to buy or rent, this property is sure to impress with its modern appeal and convenient features.

Situation

Both the Marketing Agent and The Auctioneer may believe necessary or beneficial to the customer to pass their details to third party service suppliers, from which a referral fee may be obtained. There is no requirement or indeed obligation to use these recommended suppliers or services.

A Legal Pack associated with this particular property is available to view upon request and contains details relevant to the legal documentation enabling all interested parties to make an informed decision prior to bidding. The Legal Pack will also outline the buyers' obligations and sellers' commitments. It is strongly advised that you seek the counsel of a solicitor prior to proceeding with any property and/or Land Title purchase.

null

Council Tax Band: D

Available:



Floor Plans

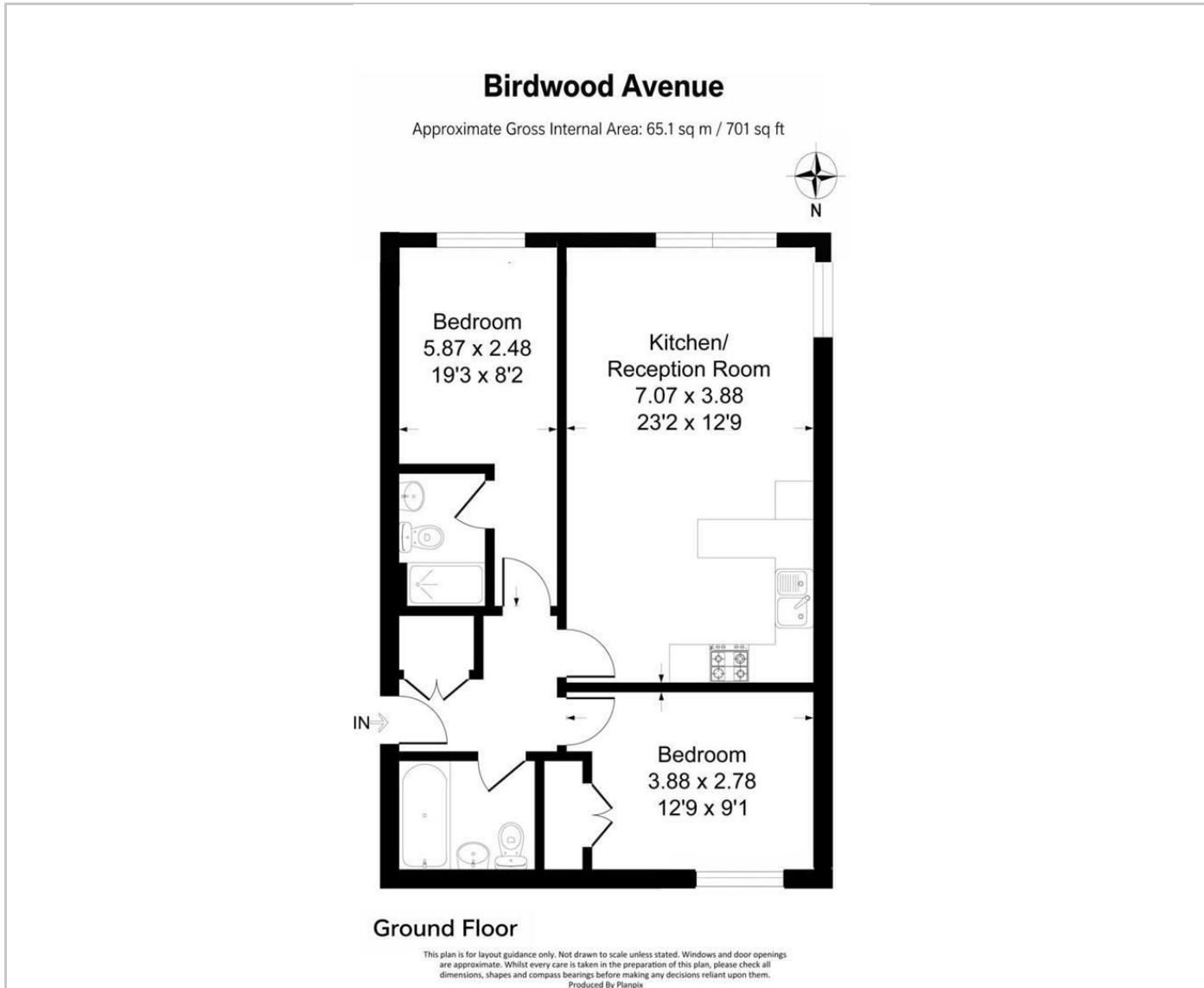

Area Map

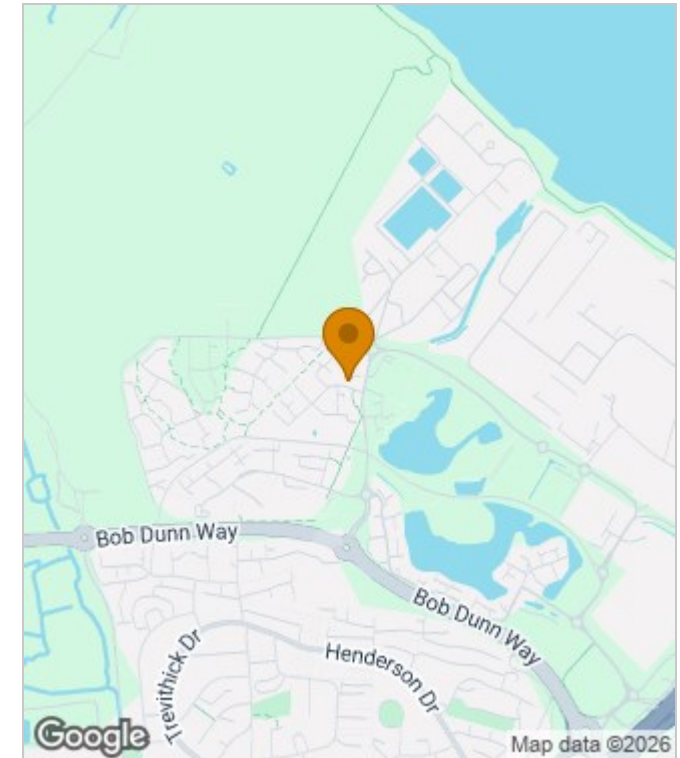

Energy Performance Graph

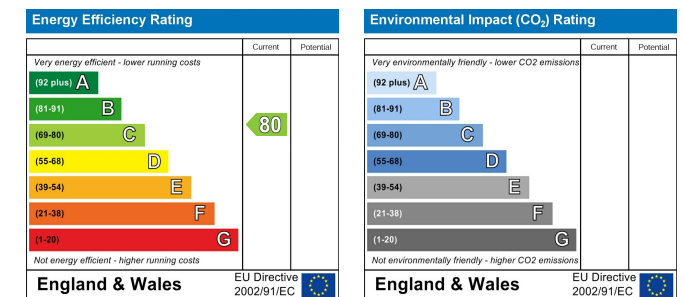

These particulars, whilst believed to be accurate are set out as a general outline only for guidance and do not constitute any part of an offer or contract. Intending purchasers should not rely on them as statements of representation of fact, but must satisfy themselves by inspection or otherwise as to their accuracy. No person in this firm's employment has the authority to make or give any representation or warranty in respect of the property.

The Nucleus Brunel Way, Dartford, Kent, DA1 5GA

Tel: 02081758868 Email: property@lyhpropertyconsultants.com www.lyhpropertyconsultants.com