



Kempsford Gardens, SW5

£2,500 Per calendar month

A spacious raised ground floor flat with a large private patio garden. The property benefits from wooden floors throughout, built in storage and a new kitchen.

Kempsford Gardens is well situated moments from the amenities of Old Brompton Road and Earls Court and within easy reach of the shops, bars and restaurants of Kensington High Street. Earls Court tube is located 0.1 miles away.

Features

- One Bedroom
- Private Patio
- Wooden Floors
- Built In Storage
- New Kitchen
- Raised Ground Floor

Kempsford Gardens, London, SW5

Ground Floor

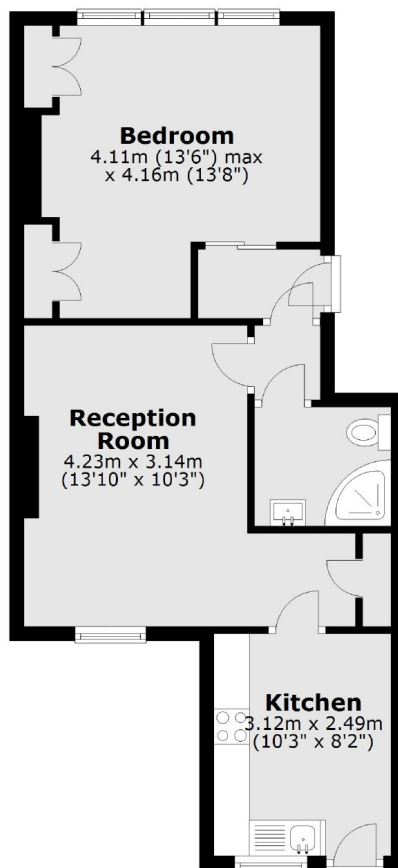

Total area: approx. 46.2 sq. metres (497.1 sq. feet)