



Chewton Street
Eastwood Nottingham

burchell
edwards



Property Description

Offered with no upward chain, this refurbished and fully rewired, two double bedroom semi-detached property is situated in the popular town of Eastwood and provides a blend of traditional features with modern finishes. Conveniently located close to a range of local amenities, the property would suit a variety of buyers.

The accommodation briefly comprises an entrance hall, lounge, dining room opening through to a fitted kitchen with integrated appliances and pantry. To the first floor are two well-proportioned double bedrooms, including a spacious principal bedroom with walk-in storage, and a family bathroom fitted with a modern suite.

Externally, the property benefits from a front lawned garden and driveway providing off-road parking, leading to a single garage. To the rear is a generous garden with patio area, useful outside WC, former coal store, greenhouse and timber sheds.

The property also offers potential to extend (subject to the necessary planning permissions), making it an ideal purchase for those looking to further enhance and add value.

Entrance Hall

Accessed via a part-glazed composite entrance door with glazed panel above, with staircase rising to the first floor and fitted radiator.

Living Room

Featuring a uPVC double glazed bay window with decorative leaded detailing, TV point, finished with oak-effect laminate flooring and two wall mounted radiators.

Dining Room

With laminate flooring in an oak finish, double panelled radiator, TV point, and uPVC double glazed French doors providing direct access to the rear garden.

Kitchen

Fitted with a selection of wall, base and drawer units incorporating work surfaces with inset single drainer sink and mixer tap. Integrated Lamona electric oven with induction hob and extractor above. Additional features include tiled splashbacks, a hardwired flame detector, ceiling spotlights, uPVC double glazed window and housing for the Worcester wall mounted combination boiler. A pantry offers additional storage, complete with power, lighting and window.

Landing

Carpeted with a uPVC double glazed window, and two smoke detectors, providing access to all first-floor accommodation.

Bedroom One

uPVC double glazed windows with leaded detailing, carpet flooring, wall mounted radiator, walk-in storage cupboard over the stairs and access to the loft space.

Bedroom Two

uPVC double glazed window enjoying open views towards Castle Donington, a double panelled radiator and finished with carpet floor.

Bathroom

Comprising a P-shaped bath with mixer shower and glazed screen, vanity wash hand basin and low flush WC. Finished with Aqua board walling, uPVC double glazed window, extractor fan, chrome heated towel rail, additional radiator and illuminated LED mirror.

Externals

To the front, a lawned garden is bordered by hedging, with a driveway to the side providing off-road parking and access to the garage and two timber sheds located behind.

Rear Garden – Incorporating a patio area with external WC fitted with wash hand basin and low-level WC, alongside a former coal store. Steps lead down to a good-sized lawned garden with greenhouse and a timber garden shed.

Garage

Detached garage accessed via timber doors.







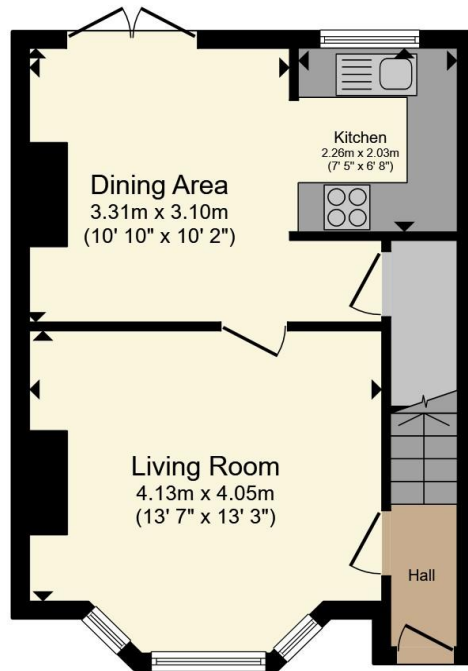

Ground Floor

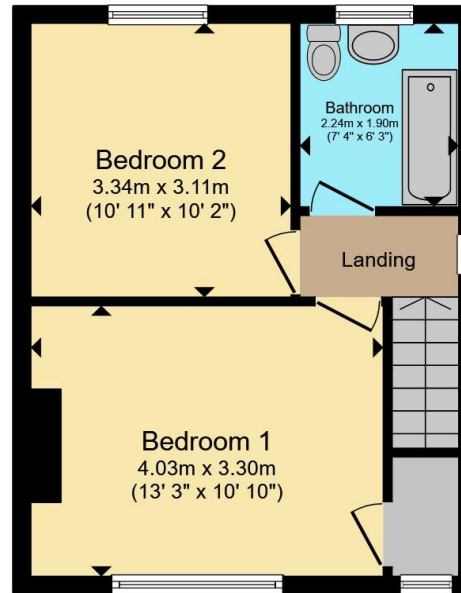

First Floor

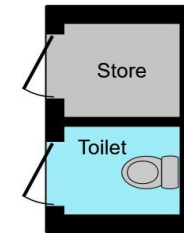

Outbuilding

Total floor area 74.0 m² (796 sq.ft.) approx

This floor plan is for illustrative purposes only. It is not drawn to scale. Any measurements, floor areas (including any total floor area), openings and orientation are approximate. No details are guaranteed, they cannot be relied upon for any purpose and they do not form part of any agreement. No liability is taken for any error, omission or misstatement. A party must rely upon its own inspection(s). Powered by www.propertybox.io



To view this property please contact Burchell Edwards on

T 01773 715454
E eastwood@burchelledwards.co.uk

134 Nottingham Road Eastwood
 NOTTINGHAM NG16 3GD

EPC Rating: D Council Tax
 Band: B

Tenure: Freehold

check out more properties at burchelledwards.co.uk



1. MONEY LAUNDERING REGULATIONS Intending purchasers will be asked to produce identification documentation at a later stage and we would ask for your co-operation in order that there will be no delay in agreeing the sale. 2. These particulars do not constitute part or all of an offer or contract. 3. The measurements indicated are supplied for guidance only and as such must be considered incorrect. Potential buyers are advised to recheck measurements before committing to any expense. 4. We have not tested any apparatus, equipment, fixtures, fittings or services and it is in the buyers interest to check the working condition of any appliances.

Burchell Edwards is a trading name of Connells Residential which is registered in England and Wales under company number 1489613, Registered Office is Cumbria House, 16-20 Hockliffe Street, Leighton Buzzard, Bedfordshire, LU7 1GN. VAT Registration Number is 500 2481 05.

See all our properties at www.burchelledwards.co.uk | www.rightmove.co.uk | www.zoopla.co.uk

Property Ref: EWD207487 - 0002