

*Franklyn
James*



Commercial Road, E14 7LF
£1,545 Per Calendar Month



Commercial Road, E14 7LF
£1,545 Per Calendar Month

- Situated on the top floor
- Offered furnished
- One bedroom apartment
- Open plan kitchen and bathroom
- Abundance of natural light
- Perfect for a single occupant or a couple
- Close to Limehouse DLR Station
- Easy access into the City

EPC rating- D
Tax band- B



A one bedroom, one bathroom apartment with semi-open plan reception room and fitted kitchen.

Located within close proximity to Limehouse DLR granting easy access into the City and Canary Wharf.

Commercial Road, E14
 Approx. Gross Internal Area 336 Sq Ft - 31.22 Sq M

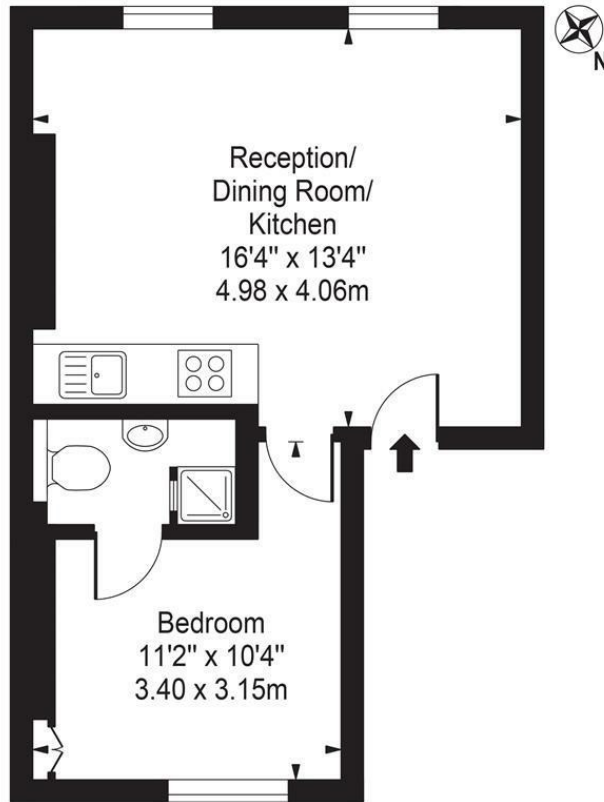

Second Floor

For Illustration Purposes Only - Not To Scale

This floor plan should be used as a general outline for guidance only and does not constitute in whole or in part an offer or contract. Any intending purchaser or lessee should satisfy themselves by inspection, searches, enquiries and full survey as to the correctness of each statement. Any areas, measurements or distances quoted are approximate and should not be used to value a property or be the basis of any sale or let.

Area Map

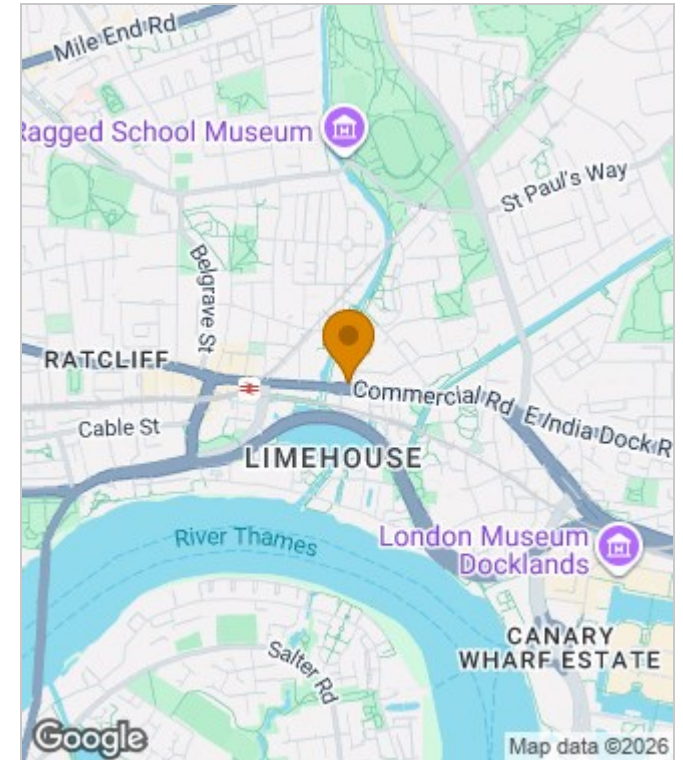

Energy Performance Graph

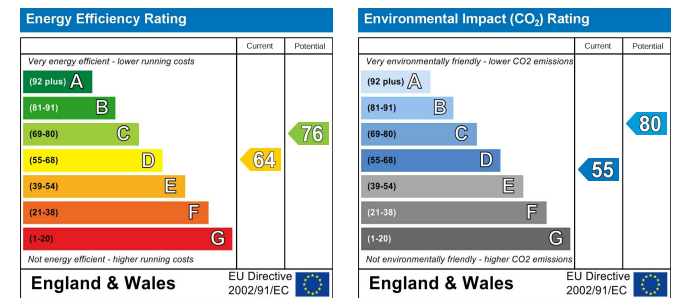

These particulars, whilst believed to be accurate are set out as a general outline only for guidance and do not constitute any part of an offer or contract. Intending purchasers should not rely on them as statements of representation of fact, but must satisfy themselves by inspection or otherwise as to their accuracy. No person in this firm's employment has the authority to make or give any representation or warranty in respect of the property.



29 Narrow Street, London, E14 8DP
 Tel: 02077911777 Email: lettings@franklynjames.co.uk <https://www.franklynjames.co.uk>