



Plot 24

Church Road | | Woodton | NR35 2NB

Guide Price **£375,000**

DURRANTS
SINCE 1853

Key features

- Individually styled three-bedroom detached bungalow
- Spacious kitchen / dining room ideal for entertaining and family living
- Bright and comfortable separate living room
- Principal bedroom with stylish en-suite shower room
- Two further versatile bedrooms
- Contemporary main bathroom
- Fully enclosed rear garden
- High quality specification with energy efficient features
- Custom Build Opportunity With This Plot

Description

Plot 24 - The Strumpshaw is an individually styled three-bedroom detached bungalow offering spacious and thoughtfully arranged accommodation, featuring a generous kitchen / dining room, bright living spaces and a well-appointed principal bedroom with en-suite, all finished to an excellent specification throughout.

Directions





Floor plans

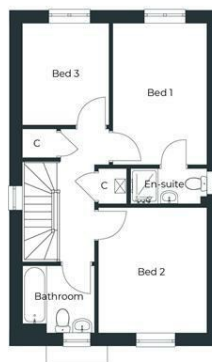

Energy Efficiency Rating		
	Current	Potential
<i>Very energy efficient - lower running costs</i>		
(92 plus) A		
(81-91) B		
(69-80) C		
(55-68) D		
(39-54) E		
(21-38) F		
(1-20) G		
<i>Not energy efficient - higher running costs</i>		
England & Wales	EU Directive 2002/91/EC	



32-34 The Thoroughfare
 Harleston
 Norfolk
 IP20 9AU
 01379 852217
 harleston@durrants.com
 https://durrants.com/