



**Price**  
**£325,000**

**Freehold**

2x  1x  1x 

**Plumtree Grove,  
Hempstead, Gillingham,  
Kent, ME7**

**OVER 60?**

Secure this property  
for up to **59% less!**

*Wards*  
Helping you move forwards





## Main features

- Beautiful first time buyers home
- Plenty of potential and well presented throughout
- Useful driveway and garden room
- Low maintenance rear garden
- Situated in a sought after location close to the shops, schools and amenities

## Accommodation

### GROUND FLOOR

Porch

Lounge: 17'1 x 12'11 (5.21m x 3.94m)

Kitchen/Diner: 12'10 x 8'11 (3.91m x 2.72m)

### FIRST FLOOR

Landing

Bedroom 1 : 13'11 x 12'11 (4.24m x 3.94m)

Bedroom 2 : 13'7 x 9'1 (4.14m x 2.77m)

Bathroom

### OUTSIDE

Front Garden

Rear Garden

Garden Room: 16'1 x 7'4 (4.91m x 2.24m)

Driveway

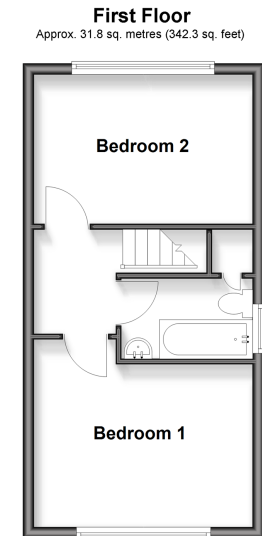
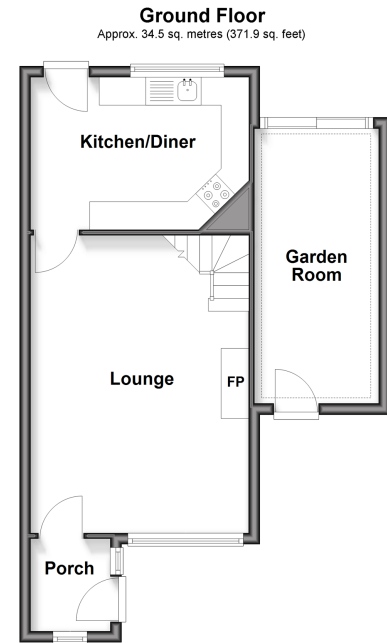

**Call Rainham - 01634 373531 ■ [wardsofkent.co.uk](http://wardsofkent.co.uk)**

- If buying to let, the energy rating will need to be improved to at least 'E' rating before you can let the property
- Legal advice should be taken to verify fixtures/fittings, planning, alterations and/or lease details
- Appliances & services are untested, dimensions are approximate and floor plans are not to scale
- Through a Homewise Home For Life Plan people aged 60+ can secure this property for up to 59% less, by purchasing a Lifetime Lease.



11338903/20250804/CW/NJ