

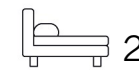

Living
made
better

Manchester Court
Custom House, E16 3GZ



Asking Price £318,000

Manchester Court, Custom House, E16 3GZ

Madison Brook

Property Summary

A well-presented two-bedroom first floor apartment extending to approximately 554 sq.ft., offered chain free with allocated off-road parking. Ideally located moments from Custom House DLR and the Elizabeth Line, the property represents an excellent first-time purchase or investment opportunity.

Service Charge: £2,725.32 pa | Ground Rent: £300 pa | Lease Remaining: 973 years

Floorplan

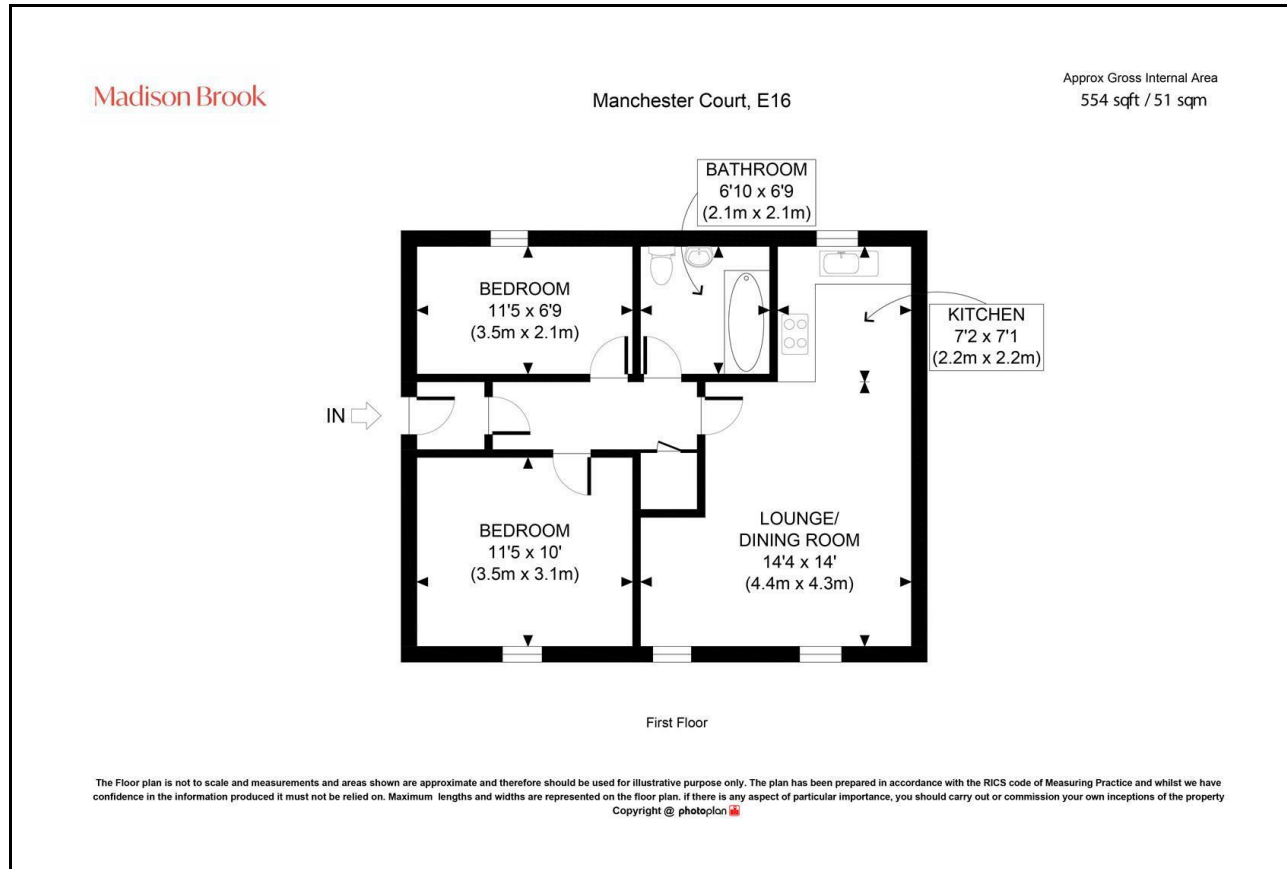

Area Map

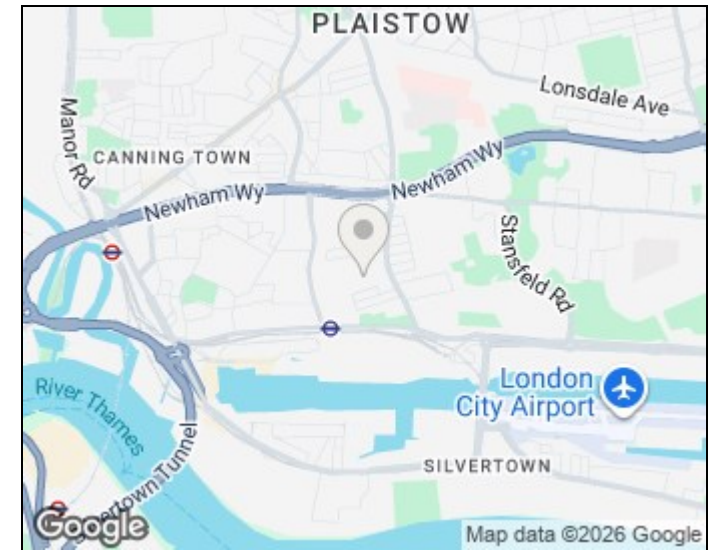

Energy Efficiency Graph

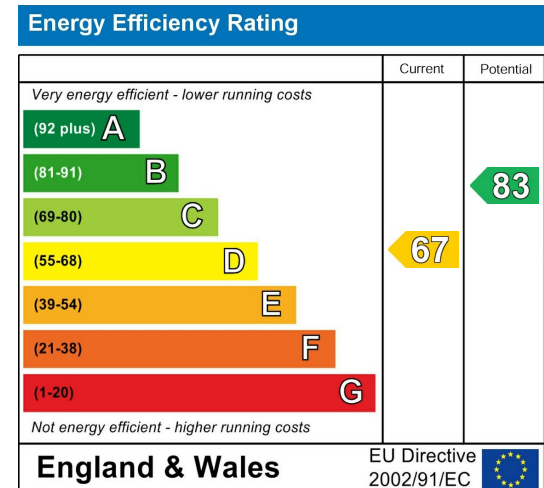

These particulars, whilst believed to be accurate are set out as a general outline only for guidance and do not constitute any part of an offer or contract. Intending purchasers should not rely on them as statements of representation of fact, but must satisfy themselves by inspection or otherwise as to their accuracy. No person in this firm's employment has the authority to make or give any representation or warranty in respect of the property.

Unit B 20 Western Gateway, Royal Victoria
Dock, London, E16 1BS
Tel: 020 3946 6000 Email:
docklands@madisonbrook.com
<https://madisonbrook.com/>