



LANDCROFT ROAD, SE22

£1,250,000

Four bedroom house
Two reception rooms
Gorgeous 25' lounge
Two bathrooms
Beautifully refurbished
Energy rating: D

@marshandparsons
marshandparsons.co.uk

MARSH &
PARSONS



ABOUT THE PROPERTY

A truly stunning property that has been created with flair, that now offers a unique, stylish family home arranged over three substantial levels.

Landcroft Road is found in central East Dulwich, close to to an ample choice of independent shops, bars, cafés & bistros on Lordship Lane.

For those thinking of schools, there are both Good & Outstanding nearby - according to Ofsted. Your attention to view this incredible home is highly recommended.



STEP INSIDE LANDCROFT ROAD

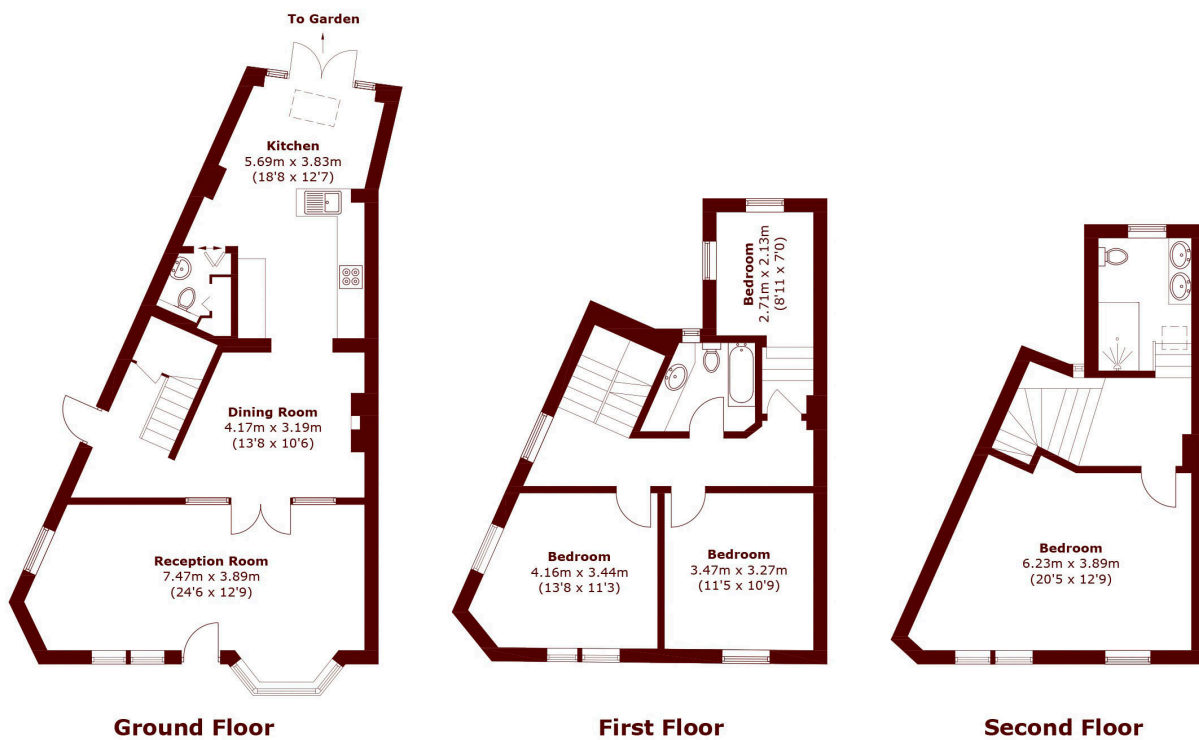

Total area (approx.) 155.7 Sq.m (1676 Sq.ft)

Brockley
020 8629 8164

Energy Rating: D We aim to make our particulars both accurate and reliable. However, they are not guaranteed; nor do they form part of an offer or contract. If you require clarification on any points then please contact us, especially if you're traveling some distance to view. Please note that appliances and heating systems have not been tested and therefore no warranties can be given as to their good working order

**MARSH &
PARSONS**