



Keith
Ashton

Blackmore Road, Kelvedon Hatch
Brentwood



55 BLACKMORE ROAD

Kelvedon Hatch Brentwood, CM15 0BE

£490,000

Well-presented throughout and benefitting from a lovely, landscaped garden and plenty of off-street parking which includes a detached garage with EV charging point, is this three-bedroom, semi-detached family home. Located in the popular village of Kelvedon Hatch, you will find that the property is within walking distance of Kelvedon Hatch Primary School, village shops and The Shepherd country pub. The property is also within easy reach of surrounding villages, along with Brentwood and Shenfield town centres, where you have mainline train services into London and high street shopping.

THREE GOOD-SIZED BEDROOMS
EXCELLENT OFF STREET PARKING &
DETACHED GARAGE

SEMI-DETACHED FAMILY HOME
KITCHEN / DINER

POPULAR VILLAGE LOCATION
SEPARATE LOUNGE

WELL-PRESENTED THROUGHOUT
GROUND FLOOR W.C.



Description

Entering the property at the side of the house you find yourself in a bright hallway with stairs rising to the first floor. There are doors into the living room, kitchen/diner and into a modern ground floor cloakroom with w.c. and wash hand basin. The living room at the front of the property is a spacious room with a large bay window to the front aspect, allowing for lots of natural lighting. At the rear of the property, you have a lovely kitchen / diner with French doors which open onto the rear garden. The kitchen has been fitted in a modern range of white gloss, wall and base units with contrasting work surface over. Integrated appliances to include double oven, hob with extractor above and a built-in wine cooler. There is ample space for any further free-standing appliances, including a double fronted fridge/freezer.

Rising to the first floor a spacious landing has doors to all rooms and a useful airing/storage cupboard. There are three good-sized bedrooms with the master bedroom having a range of fitted wardrobes to one wall. The modern family bathroom is fully tiled and includes a panelled bath with shower over, and a wash hand basin and w.c. set into a modern unit.

The rear garden has been beautifully designed with neat lawns, painted fencing, and flowerbeds with a selection of small plants/shrubs. There is a raised decking area to the immediate rear of the house and a further seating area located at the bottom of the garden to the rear of the garage, providing a lovely private spot to sit and relax. Arriving at the property you cannot fail to notice the spacious driveway which leads to the side of the house and provides off street parking for several vehicles. There is also a detached garage to the side which has a pedestrian door which gives access to the rear garden and an EV charging point to the front.





GROUND FLOOR
657 sq.ft. (61.0 sq.m.) approx.

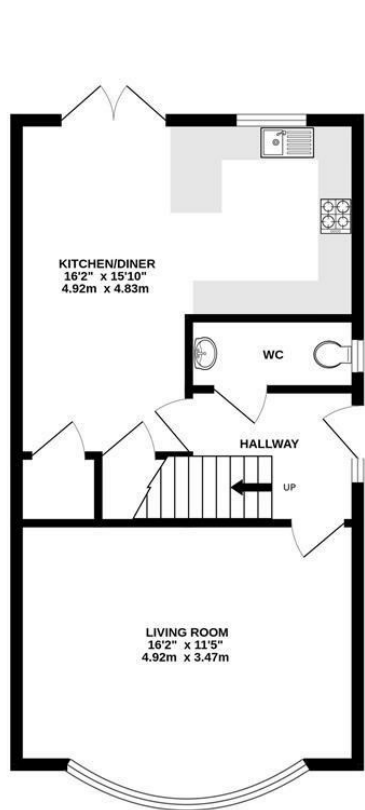

1ST FLOOR
506 sq.ft. (47.0 sq.m.) approx.

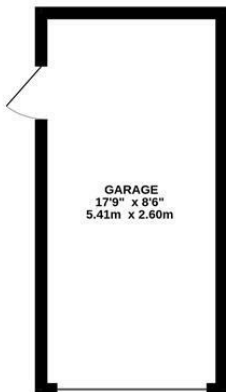

TOTAL FLOOR AREA : 1163 sq.ft. (108.0 sq.m.) approx.
Measurements are approximate. Not to scale. Illustrative purposes only
Made with Metropix ©2025

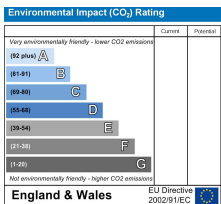
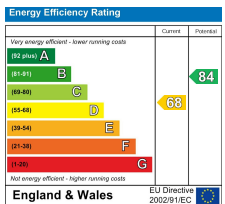

SERVICES:
Local Authority: Brentwood
Council tax band: D
Post Code: CM15 0BE

VIEWING:
Strictly by prior arrangement with Keith Ashton Estate Agents

MORTGAGE INFORMATION: We offer the additional facility of an in-house Independent Financial Adviser who will access all mortgage lenders with the purpose of providing you with the benefit of choice. For quotations or comparables please call 01277 375757 or visit our interactive website at www.mortgagebusiness.net

We the Agent have not tested any apparatus, fittings or services for this property. The plot size is intended merely as a guide and has not been officially measured or verified by the Agent. Photographs are for illustration only and may depict items which are not for sale or included in the sale of the property. As part of the service we offer we may recommend ancillary services to you which we believe may help you with your property transaction. We wish to make you aware, that should you decide to use these services we will receive a referral fee. For full and detailed information please visit 'terms and conditions' on our website www.keithashton.co.uk

