



Disraeli Road, SW15

£349,950

Set within an attractive period conversion on Disraeli Road, this bright and well-proportioned one-bedroom flat with a triple aspect and view over the communal garden. Offering nearly 348 sq ft of internal space. The property features a generous, light, and airy reception room with high ceilings, large sash windows, and statement parquet flooring. A separate, double bedroom overlooks a shared garden.

Disraeli Road is just off Putney High Street, between the station, River Thames and Wandsworth Park. Just moments from East Putney Tube and Putney station.

Features

- One Bedroom
- One Bathroom
- Share Of Freehold
- Top Floor
- Communal Garden
- Central Putney Location

Disraeli Road, London, SW15

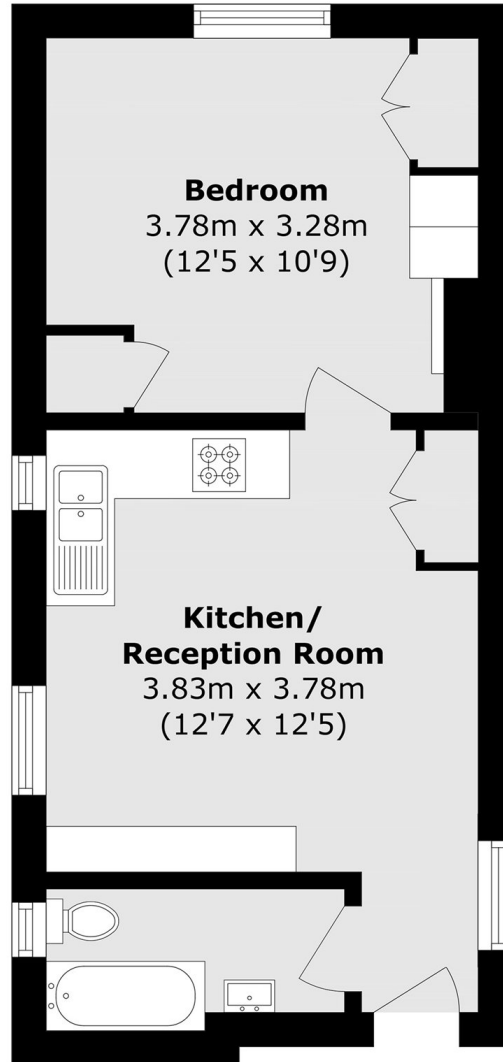

Total area (approx.): 32.4 sq. m (348.7 sq. ft)