



New Cross Road, SE14

£400,000

Located in the heart of vibrant New Cross, this beautifully presented two-bedroom upper floor flat of an attractive Victorian converted house, seamlessly blending classic period charm with sleek, contemporary interiors.

Step inside to discover a bright and spacious living space, enhanced by tall ceilings and large sash windows that flood the property with natural light. The home features two well-proportioned bedrooms, ideal for sharers, a couple, or a professional needing a home office. The standout feature is the modern and refurbished bathroom, designed with clean lines and high-end fixtures—a perfect place to unwind after a long day.

Perfectly located on New Cross Road, this home is just moments from the vibrant heart of New Cross and Deptford High Street, with a wide array of pubs, restaurants and independent coffee shops on your doorstep including Urban Barista, The Rose and The New Cross House which has amazing food, drinks and most importantly a beer garden. Deptford Market Yard and Brockley Farmers Market host everything you could need. Jazu Bar, Villages Brewery, Sodo or Watergate in Deptford for cocktails. Local beauty spots: See the views of London from Telegraph Hill, walk to the Thames to see the Cutty Sark via Deptford and Twinkle Park (20 minutes). Alternatively, Blackheath and Greenwich Park are 35 minutes walk away. Fordham Park is situated nearby with basketball courts, outdoor table tennis, climbing frames and field for picnics and games. London Bridge can be reached by train in approx 5 minutes, and Shoreditch in around 15 minutes.

Features

- Two Double Bedrooms
- Modern Bathroom
- Victorian Conversion
- Excellent Location For Transport Links
- Long Lease
- Period Features

New Cross Road, London, SE14

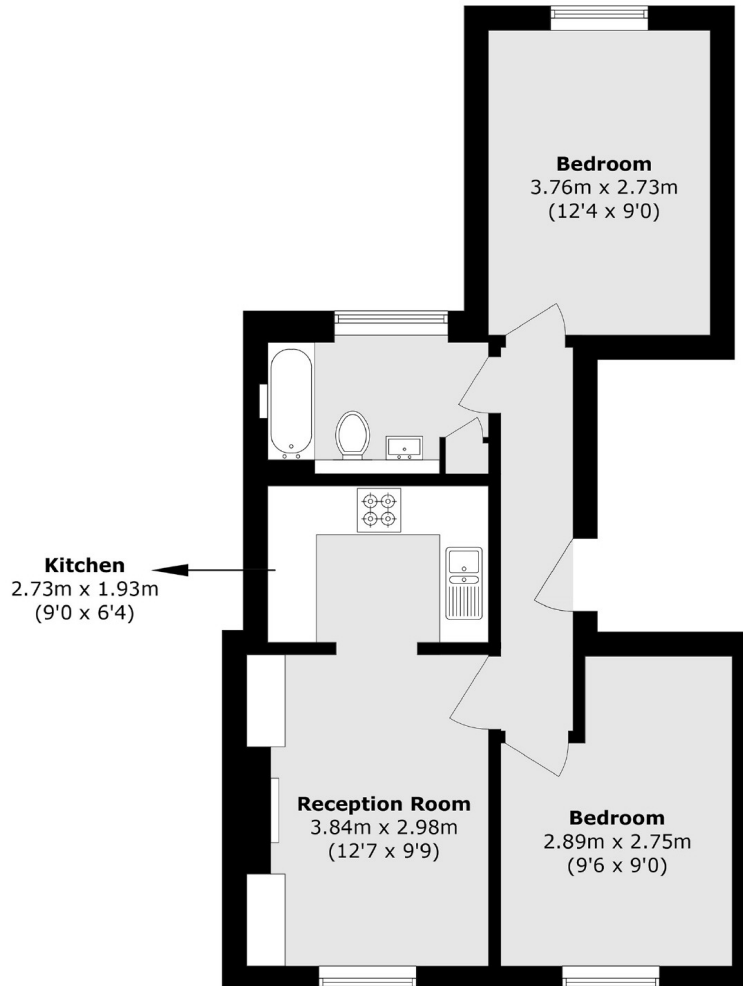

Total area (approx.): 48.0 sq. m (516.7 sq. ft)