

White Horse Lane, E1

£2,500 Per calendar month

A two double bedroom apartment on the third floor of this secure development, This property has a large open plan living and kitchen area with access to a private balcony, the building also has lift access and secure entry system. An ideal property for a couple or professional sharers looking to be a close to the City.

White Horse Lane is within walking distance to the shops, bars and restaurants of Limehouse Docklands Light Rail.

Features

- Two Double Bedrooms
- Secure Development
- Lift Access
- Wooden flooring
- Furnished
- Private Balcony

White Horse Lane, London, E1

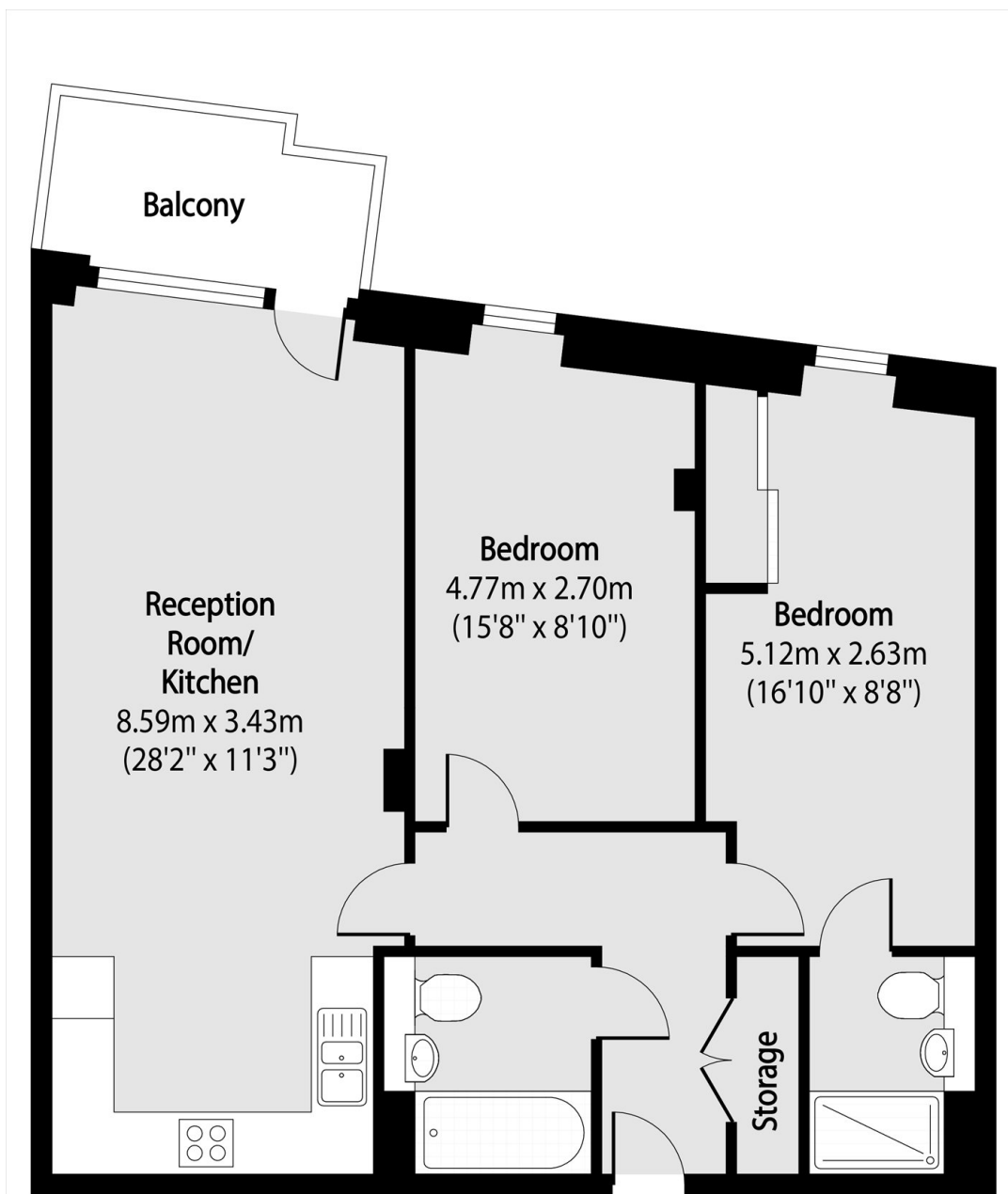

Total area (approx): 70.71 sq m (761 sq. ft)

Balcony total area (approx): 4.63 sq m (50 sq. ft)