

## South Quay Square, E14

£576 Per week

A one-bedroom apartment in the Discovery Dock development, comprising an open-plan kitchen and living area, a double bedroom, and access to a residents' concierge service.

Discovery Dock is within easy reach of South Quay DLR and Canary Wharf Underground Station, providing excellent access to the City.

### Features

- Dockside Development
- Double Bedroom
- Open-Plan Kitchen
- Concierge Service
- Contemporary Fittings
- Furnished

# South Quay Square, London, E14

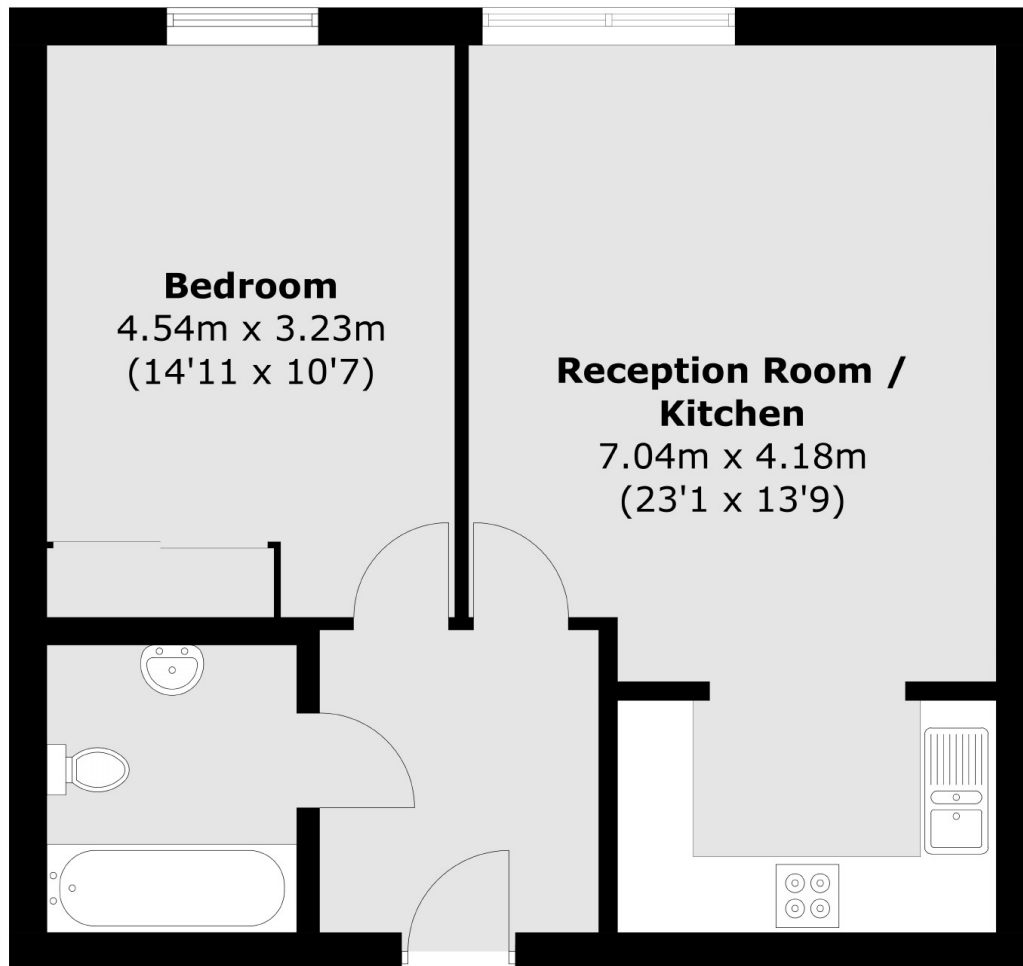

Total area (approx.): 53.0 sq. m (570.5 sq. ft)

**Dexters**

Canary Wharf  
39 Westferry Road  
London  
E14 8JH  
Lettings  
0207 517 1190

Energy Rating: C. We aim to make our particulars both accurate and reliable. However they are not guaranteed; nor do they form part of an offer or contract. If you require clarification on any points then please contact us, especially if you're traveling some distance to view. Please note that appliances and heating systems have not been tested and therefore no warranties can be given as to their good working order.

 **RICS** | Regulated  
Estate Agent  
and Letting Agent

[dexters.co.uk](http://dexters.co.uk)