



26 Kiers Court, Horwich

Offers Over £135,000

Miller Metcalfe
Every step of the way

26 Kiers Court

Horwich, Bolton

STUNNING 2 BEDROOM APARTMENTPOPULAR HORWICH LOCATION***ALLOCATED COVERED PARKING*** This impressive two bedroom apartment is located in an historic Grade II Listed Building which has been converted residential apartments, which still maintains the industrial character of the building. The home has been well looked after and is ideal for first time buyers or BTL investors. Arcon Village is a Grade II listed award-winning development of a former bleaching works by Redrow Homes. It is a unique development within the Wallsuchers Conservation Area with a strong community of residents. There is a pleasant communal garden area together with superb access towards Wilderswood and the West Pennine Moors. Footpaths lead directly from the development to Rivington and the countryside beyond, as well as into Horwich town centre. Horwich provides access to an excellent transport infrastructure combining road transport with easy access to Junction 6, M61 and mainline train links.

Council Tax band: C

Tenure: Leasehold

EPC Energy Efficiency Rating: C

EPC Environmental Impact Rating: D









GROUND FLOOR
687 sq.ft. (63.8 sq.m.) approx.

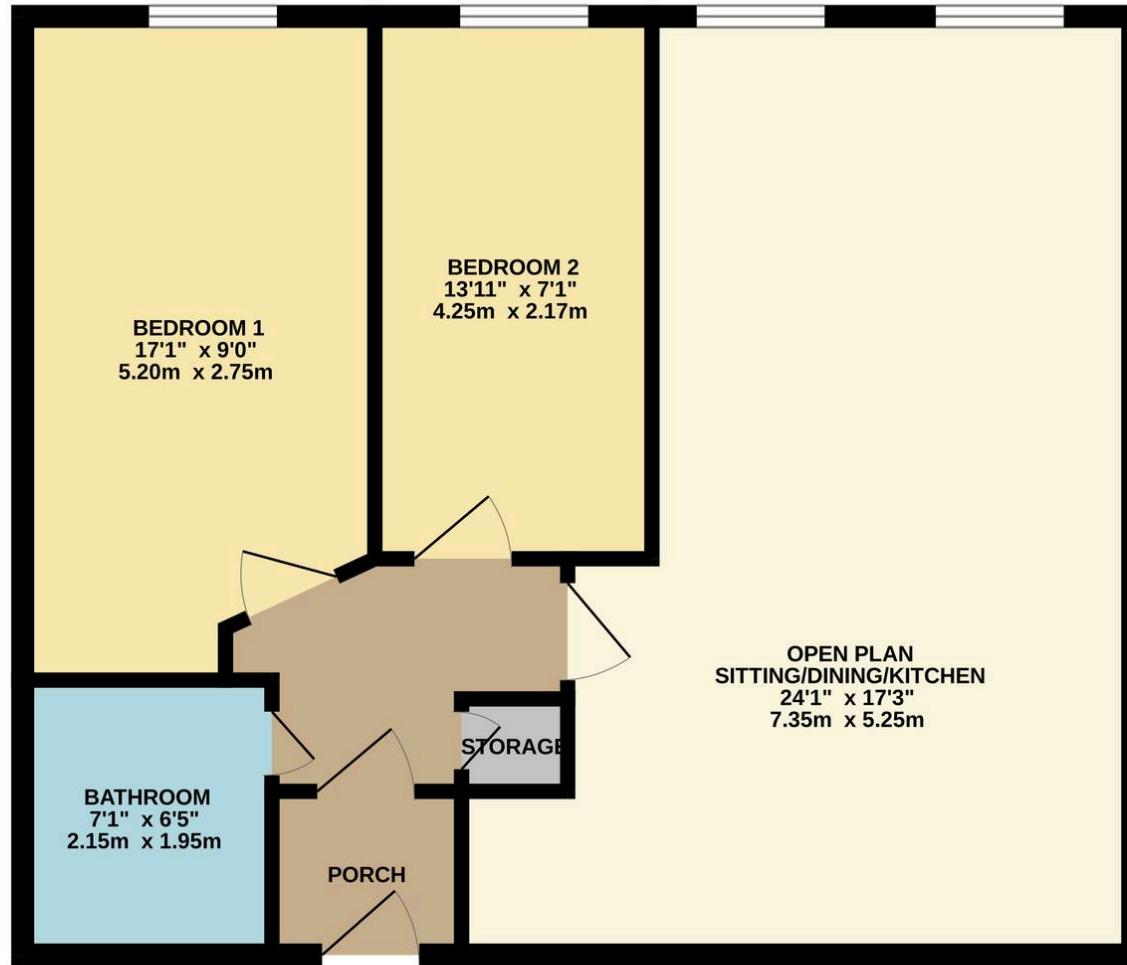

TOTAL FLOOR AREA : 687 sq.ft. (63.8 sq.m.) approx.

Whilst every attempt has been made to ensure the accuracy of the floorplan contained here, measurements of doors, windows, rooms and any other items are approximate and no responsibility is taken for any error, omission or mis-statement. This plan is for illustrative purposes only and should be used as such by any prospective purchaser. The services, systems and appliances shown have not been tested and no guarantee as to their operability or efficiency can be given.
Made with Metropix ©2025



Miller Metcalfe - Bolton

Miller Metcalfe, 2-10 Bradshawgate - BL1 1DG

01204 535353 • bolton@millermetcalfe.co.uk • millermetcalfe.co.uk/

Miller Metcalfe
Every step of the way