



Luscombe Maye

Since 1873

Corner Cottage, Stokenham

Guide Price £275,000

🛏️ 3 🚿 1 🚗 1



- Three Bedrooms
- Grade II Listed
- Outbuilding
- Thatched Cottage
- En-Suite
- Log Burner
- Carport Parking
- No Chain
- Fox Roof Detail



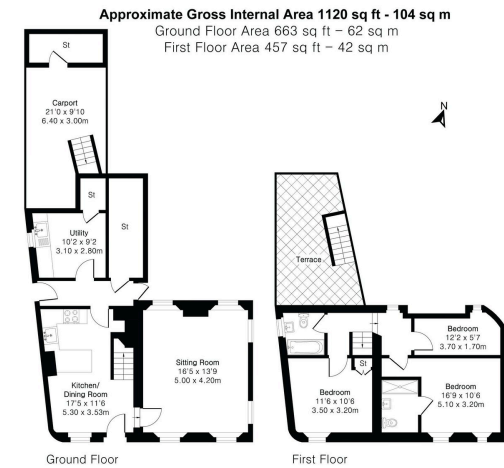

PINK PLAN

Luscombe Maye

Charming three bedroom semi-detached thatched cottage dating in part back to the 14th century, offering a wealth of character features together with a terrace garden, carport parking, useful outbuilding and no onward chain.

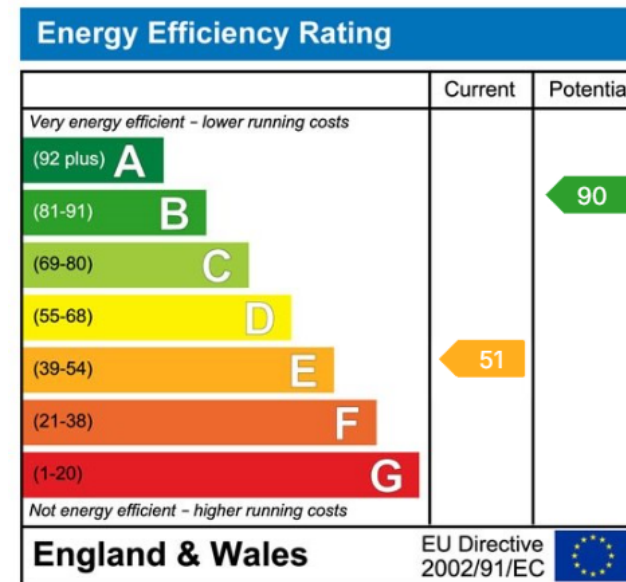

Important Notice: Luscombe Maye gives notice that: 1. These particulars do not constitute an offer or contract or part thereof. 2. All descriptions, photographs and plans are for guidance only and should not be relied upon as statements or representations of fact. All measurements are approximate and not necessarily to scale. Any prospective purchaser must satisfy themselves of the correctness of the information within the particulars by inspection or otherwise. 3. Luscombe Maye does not have any authority to give any representations or warranties whatsoever in relation to this property (including but not limited to planning/building regulations), nor can it enter into any contract on behalf of the Vendor.

Luscombe Maye
 Since 1873

Kingsbridge:
 62 Fore Street, Kingsbridge TQ7 1PP
 01548 857474
 kingsbridge@luscombemaye.com
 www.luscombemaye.com