



WESTBOURNE TERRACE, W2

£595,000

Lovely building
Lift access
Stunning high ceilings
Excellent reception space
Superb transport links
EPC- C

@marshandparsons
marshandparsons.co.uk

MARSH &
PARSONS

ABOUT THE PROPERTY

A wonderfully spacious one bedroom third floor apartment (with lift) within this stunning white stucco fronted period building.

The property is wonderfully located, set back from the road on Westbourne Terrace, just a short stroll from the vast green open spaces of Hyde Park. There are excellent transport links very close by accessed from Paddington which includes the Elizabeth line, in addition to the Heathrow Express, whilst easy access to the central line is provided from the underground at Lancaster Gate. Further adding to its appeal is the rejuvenated Queensway, with its various new facilities which are also within close proximity.







FURTHER DETAILS

Boasting high ceilings and large windows, the accommodation features an impressive reception room with excellent dining space, a generous separate kitchen, large principal bedroom, bathroom with a bath and shower, and a second bedroom/study.



STEP INSIDE WESTBOURNE TERRACE

Westbourne Terrace, W2

APPROX GROSS INTERNAL AREA
763 SQ FT / 70.9 SQ M

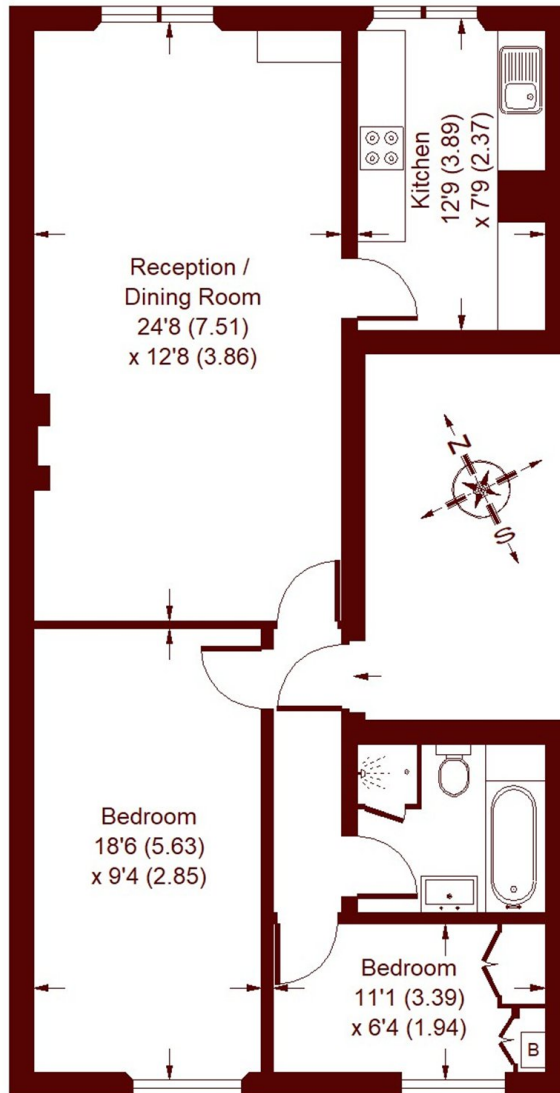

Whilst every attempt has been made to ensure the accuracy of the floor plan, measurements are approximate and not to scale.
No guarantee is given on the total square footage of the property quoted on the plan. Figures given are for guidance.
Plan is for illustration purposes only, not to be used for valuations.

Notting Hill
020 7313 2890

Energy Rating: C We aim to make our particulars both accurate and reliable. However, they are not guaranteed; nor do they form part of an offer or contract. If you require clarification on any points then please contact us, especially if you're traveling some distance to view. Please note that appliances and heating systems have not been tested and therefore no warranties can be given as to their good working order

MARSH &
PARSONS