



Atherstone Court

Delamere Terrace, W2

Offers in excess of £425,000

A large two bedroom apartment with west facing balcony spanning over 700 sqft. Situated on the first floor of a purpose built block the property consists of two large bedrooms with ample storage, a well sized eat in kitchen, a separate w/c and bathroom and a large and bright living room with direct access to the balcony.

Delamere Terrace is well located moments from transport links including Warwick avenue underground station (Bakerloo Line) and close to all the wonderful amenities Little Venice have to offer.

CHESTERTONS



Atherstone Court

Delamere Terrace, W2

- Balcony
- Over 700 sqft
- Large double bedrooms
- Moments from the canal



Tenure: Leasehold 81 years 3 months
Service Charge: £1,447.09 pa
Ground Rent: £10 pa
Local Authority: City of Westminster
Council Tax Band: C

Score	Energy rating	Current	Potential
92+	A		
81-91	B		
69-80	C	78 C	78 C
55-68	D		
39-54	E		
21-38	F		
1-20	G		

Chestertons Little Venice Sales

26 Clifton Road
Maida Vale
London
W9 1SX
littlevenice@chestertons.co.uk
020 7286 4632
chestertons.co.uk

Atherstone Court,
Delamere Terrace, W2



○ - Ceiling Height

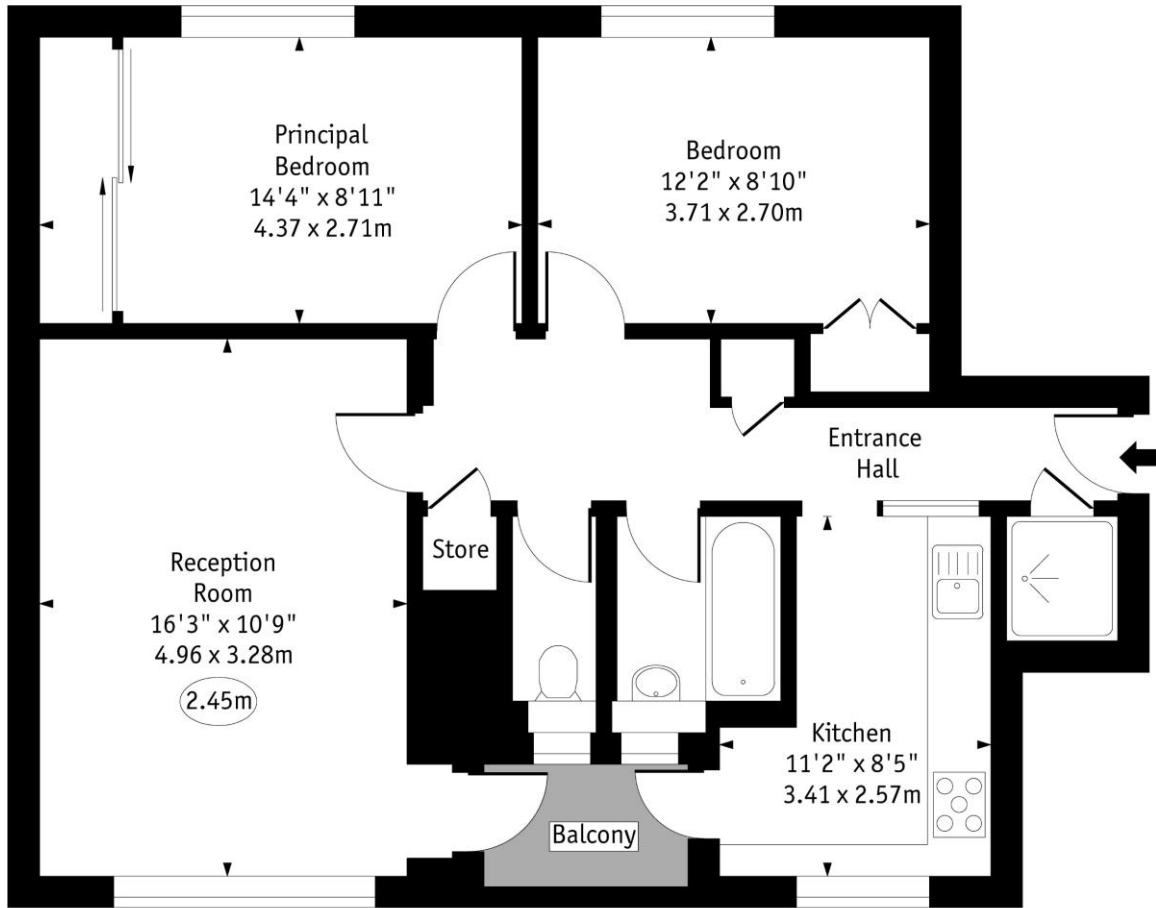

First Floor

Approx Gross Internal Area 740 Sq Ft - 68.73 Sq M

Every attempt has been made to ensure the accuracy of the floor plan shown. However, all measurements, fixtures, fittings, and data shown are approximate interpretations and for illustrative purposes only. Measured according to the RICS. Not To Scale.

www.goldlens.co.uk

Ref. No. 029181DH