

Apartment 15 Lido Grange, Sandy Lane, Prestatyn, Denbighshire LL19 7AX

Shared Ownership £156,500

🛏️ 2 🍽️ 1 🚗 1



PETER LARGE
ESTATE AGENTS



PETER LARGE



PETER LARGE



PETER LARGE

SHARED OWNERSHIP optional - Located on the first floor is this spacious and well presented two bedroom apartment with a good size lounge, fitted kitchen, modern shower room and allocated parking. Having use of the communal lounge & facilities this is an ideal retirement location. Enjoying views towards the Prestatyn Hillside early viewing is highly recommended.

DIRECTIONS From the Prestatyn office turn left and at the mini roundabout turn right onto Ffordd Pendyfryn and continue past the bus station and on the railway bridge turn left onto Sandy Lane where the property will be seen on the left hand side.

Key Features

- RESTRICTED TO OVER 60'S
- WELL PRESENTED THROUGHOUT
- TWO DOUBLE BEDROOMS
- FITTED KITCHEN
- LEASEHOLD
- FIRST FLOOR APARTMENT
- ALLOCATED PARKING
- SHOWER ROOM
- USE OF COMMUNAL AREA & LIFT
- EPC - COUNCIL TAX - C

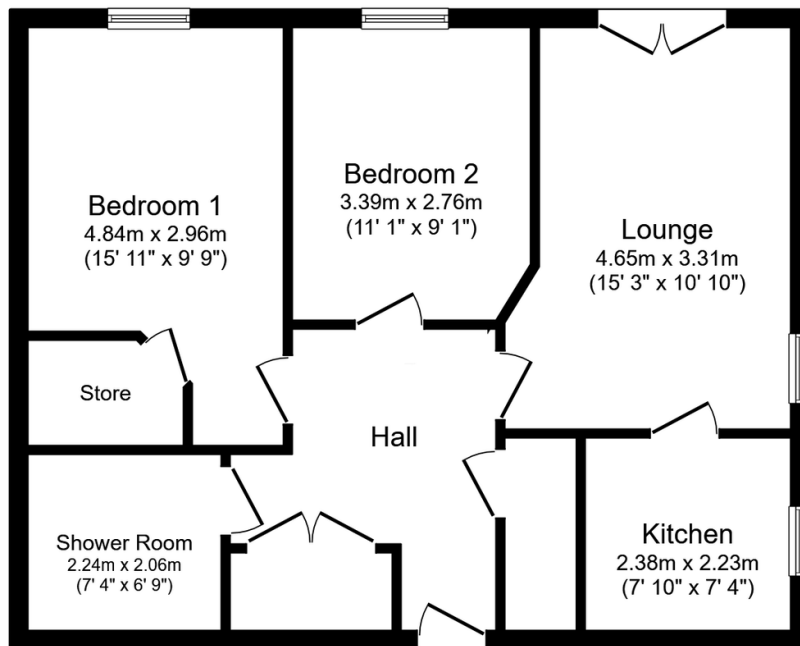

Floor Plan

Floor area 61.6 m² (663 sq.ft.)

TOTAL: 61.6 m² (663 sq.ft.)

This floor plan is for illustrative purposes only. It is not drawn to scale. Any measurements, floor areas (including any total floor area), openings and orientations are approximate. No details are guaranteed, they cannot be relied upon for any purpose and do not form any part of any agreement. No liability is taken for any error, omission or misstatement. A party must rely upon its own inspection(s). Powered by www.Propertybox.io