



## Coupsals Close, Haverhill, Suffolk, CB9 7UT

Rent - £850 PCM

Deposit - £980

A well-presented one-bedroom flat that benefits from a newly fitted modern kitchen, offering a fresh and stylish space ideal for cooking and entertaining. The flat features a bright and comfortable living area, a generously sized bedroom, and a well-maintained bathroom. Situated in a convenient residential location, the property is within easy reach of local amenities and shops making it an excellent choice for professionals or couples.

- FIRST FLOOR APARTMENT
- 1 BEDROOM
- MODERN KITCHEN
- COUNCIL TAX BAND - B
- OFF ROAD PARKING
- CLOSE TO TOWN CENTRE
- ELECTRIC HEATING & ENERGY RATING - D
- APPROXIMATE SIZE - 441 SQFT
- FAMILY BATHROOM
- AVAILABLE NOW



GROUND FLOOR  
37.5 sq.m. (404 sq.ft.) approx.

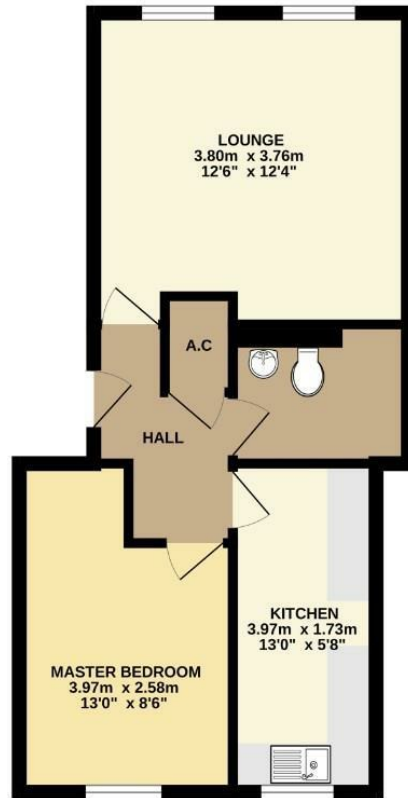

TOTAL FLOOR AREA: 37.5 sq.m. (404 sq.ft.) approx.

Whilst every attempt has been made to ensure the accuracy of the description contained here, measurements of doors, windows, rooms and any other items are approximate and no responsibility is taken for any error, omission or misstatement. This plan is for illustrative purposes only and should be used as such by any prospective purchaser. The services, systems and appliances shown have not been tested and no guarantee as to their operability or efficiency can be given.  
Made well, Meropex ©2025

