



EDWARDS  
ESTATE AGENTS

CASTLE STREET  
CRANBORNE, BH21 5QA



# GUIDE PRICE £500,000

---

- SEMI-DETACHED FAMILY HOME
- POPULAR VILLAGE LOCATION
- THREE BEDROOMS
- OPEN PLAN KITCHEN/DINING/LIVING ROOM WITH CONSERVATORY
- STUDY AND ADJOINING WC/UTILITY ROOM
- POTENTIAL FOR ANNEX (STPP)
- DOUBLE GARAGE
- CORNER PLOT WITH GARDENS TO FRONT AND REAR

Occupying a corner plot in the heart of this desirable village location, this three bedroom semi-detached family home offers opportunity to extend (STPP). The property is approached across a walled front garden to a storm porch and front door leading to a welcoming hallway.

The hub of this delightful property is undoubtedly the open plan kitchen/dining/living room which has French doors opening to the front garden as well as double opening doors to an adjoining conservatory overlooking the rear garden. The stylishly fitted kitchen with Rangemaster cooker has a distinct cottagey feel and the fitted woodburner in the living area further enhances the cosy ambience.

The study has a door directly to the rear garden as well as a useful storage cupboard and pedestrian door to the double garage and a separate utility/cloakroom has a window overlooking the rear garden.

On the first floor, the three bedrooms are served by a family bathroom fitted with a traditional bath, wash hand basin and WC, with shower screen above the bath.



Outside the delightful cottage gardens are laid to lawn with planted flower, fruit and vegetable beds. The rear garden enjoys a good degree of privacy with fencing to boundaries. Laid mainly to lawn there is also a greenhouse and garden shed.

#### Additional Information

Energy Performance Rating: D

Council Tax Band: C

Tenure: Freehold

Accessibility / Adaptations:

Flood Risk: Very low but refer to gov.uk, check long term flood risk

Flooded in the last 5 years: No

Conservation area: AONB - Dark Sky Reserve

Listed building: No

Tree Preservation Order: No

Parking: Private driveway & integral double garage

Utilities: Mains electricity, mains water

Heating: Oil fired central heating - woodburning stove

Drainage: Mains sewerage

Broadband: Refer to Ofcom website

Mobile Signal: Refer to Ofcom website

NB: We are advised that any change to external appearance requires permission from the Cranborne Estate.



GROUND FLOOR

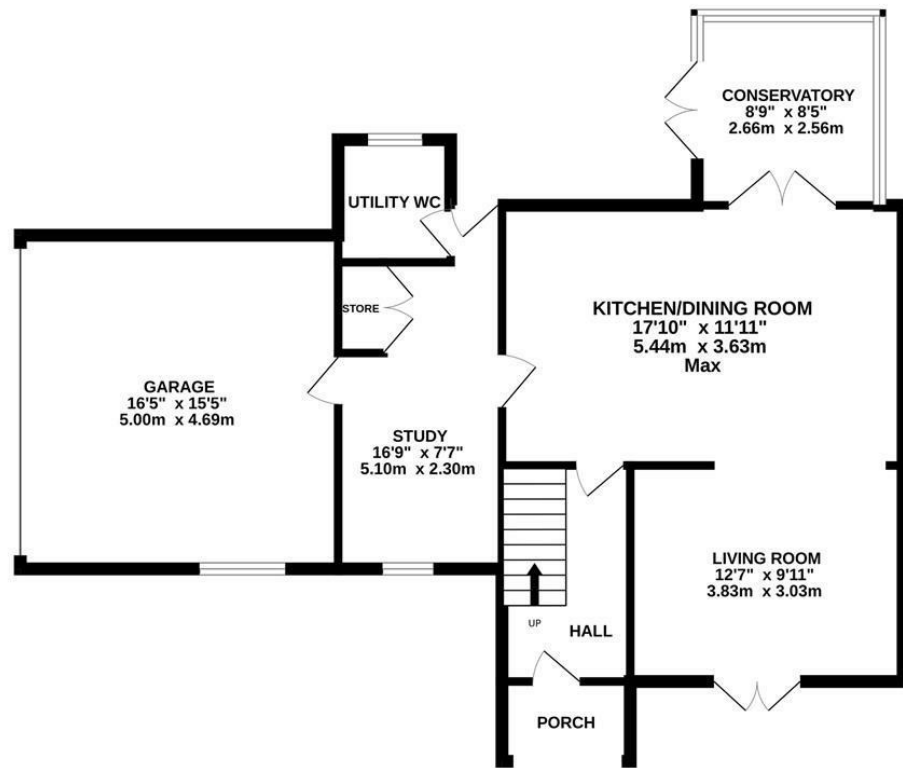

1ST FLOOR

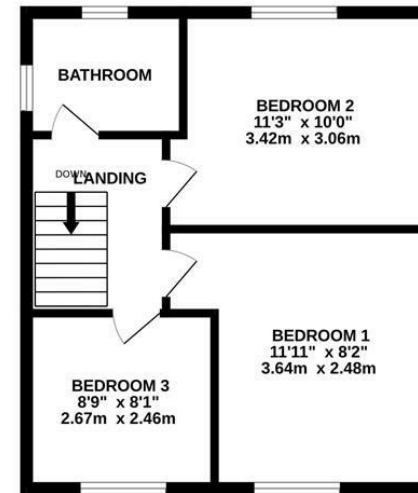

Whilst every attempt has been made to ensure the accuracy of the floorplan contained here, measurements of doors, windows, rooms and any other items are approximate and no responsibility is taken for any error, omission or mis-statement. This plan is for illustrative purposes only and should be used as such by any prospective purchaser. The services, systems and appliances shown have not been tested and no guarantee as to their operability or efficiency can be given.  
Made with Metropix ©2026

These particulars are believed to be correct but their accuracy is not guaranteed and they do not form part of any contract. Whilst every effort is made to ensure the accuracy of these details, it should be noted that the above measurements are approximate only. Floorplans are for representation purposes only and prepared according to the RICS Code of Measuring Practice by our floorplan provider. Therefore, the layout of doors, windows and rooms are approximate and should be regarded as such by any prospective purchaser. Any internal photographs are intended as a guide only and it should not be assumed that any of the furniture/ fittings are included in any sale. Where shown, details of lease, ground rent and service charge are provided by the vendor and their accuracy cannot be guaranteed, as the information may not have been verified and further checks should be made either through your solicitor/conveyancer or by referring to the home information pack for this property. Where appliances, including central heating, are mentioned, it cannot be assumed that they are in working order, as they have not been tested. Please also note that wiring, plumbing and drains have not been checked.

Ferndown Office

404 Ringwood Road, Ferndown, Dorset, BH22 9AU • [www.edwardstates.com](http://www.edwardstates.com)  
01202 855595