



4 Arden Place, Luton, LU2 7YE

Two Bedroom Park Facing Apartment – Available Now

This well presented two bedroom apartment in Luton is available to rent immediately and would make an ideal home for a couple, small family or professional tenants.

The property offers two double bedrooms, a bright lounge with large windows, a refitted kitchen with pleasant views over People's Park and a modern bathroom. The main bedroom benefits from fitted wardrobes, while the spacious lounge/diner provides plenty of natural light and an attractive outlook.

The kitchen includes an integrated cooker, electric hob, sink/drain, plumbing for a washing machine, space for a dishwasher and fridge-freezer and a window overlooking the park. The bathroom is fitted with a bath with shower over, wash basin with vanity unit, W.C. heated

- Nova Estate Agents
- Press Play Button For 360° Walkaround Tour
- Spacious Apartment
- Walking Distance to Train Station
- Views Over People's Park
- Garage & Allocated Parking
- Available Now!

£1,200 Per month

Approx Gross Internal Area
56 sq m / 606 sq ft

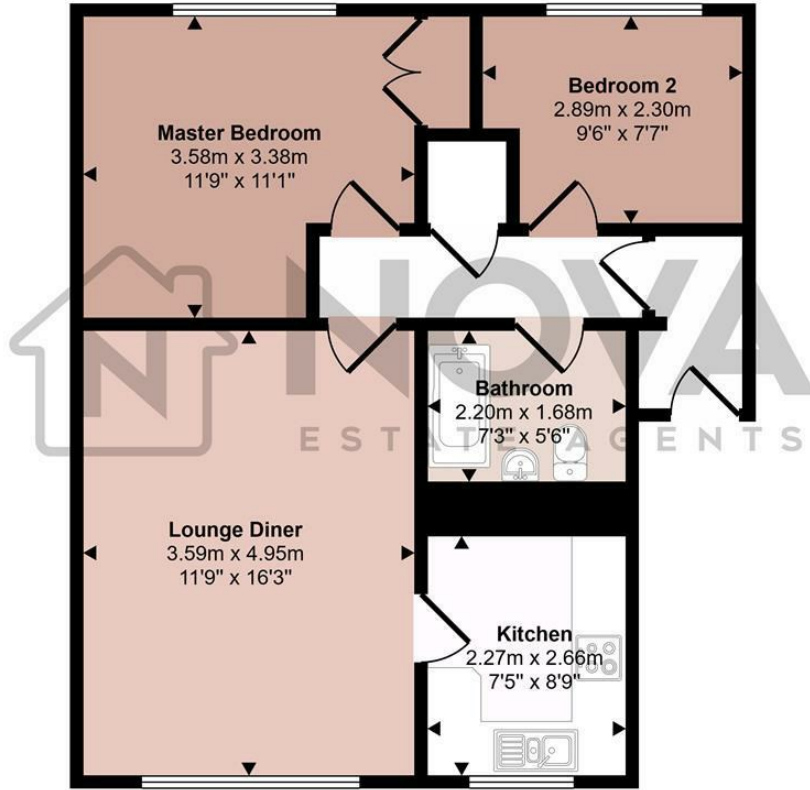

Floorplan

This floorplan is only for illustrative purposes and is not to scale. Measurements of rooms, doors, windows, and any items are approximate and no responsibility is taken for any error, omission or mis-statement. Icons of items such as bathroom suites are representations only and may not look like the real items. Made with Made Snappy 360.

Energy Efficiency Rating		Current	Potential
Very energy efficient - lower running costs			
(92 plus) A			
(81-91) B			
(69-80) C			79
(55-68) D	62		
(39-54) E			
(21-38) F			
(1-20) G			
Not energy efficient - higher running costs			
England & Wales	EU Directive 2002/91/EC		