

This floorplan is only for illustrative purposes and is not to scale. Measurements of rooms, doors, windows, and any items are approximate and no responsibility is taken for any error, omission or mis-statement. Icons of items such as bathroom suites are representations only and may not look like the real items. Made with Made Snappy 360.

Floorplan

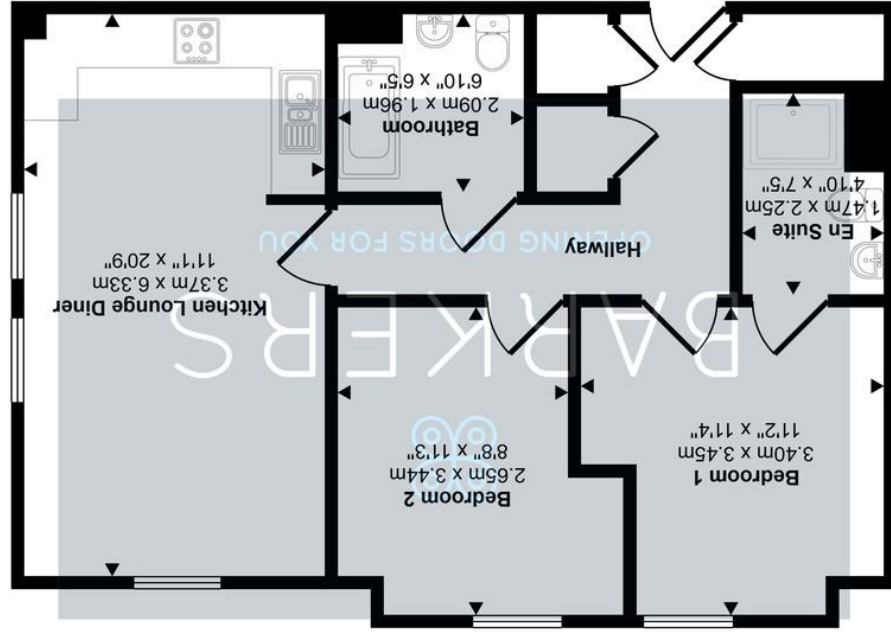

84 B	82+	A
84 B	81-91	B
	69-80	C
	55-68	D
	39-54	E
	21-38	F
	1-20	G



14 Heathfield Lane

Birkenshaw, BD11 2DP

Asking Price £94,150

- FIRST FLOOR APARTMENT
- TWO DOUBLE BEDROOMS
- EN SUITE SHOWER ROOM
- BATHROOM
- PARKING SPACE
- GAS CENTRAL HEATING
- UPVC DOUBLE GLAZING
- CONVENIENT LOCATION
- TERMS & CONDITIONS APPLY



Full Description

FORMING PART OF THE QUALIFYING PERSON CRITERIA, Terms and Conditions apply.

Immaculate two bedroomed first floor apartment, which must be viewed to be appreciated. Ideally situated within easy reach of local amenities, bus routes, local shops and the M62 motorway network. The property benefits from uPVC double glazing and gas fired central heating. The property comprises: entrance hall with intercom entry, lounge/kitchen, two double bedrooms, en suite shower room, house bathroom, private parking space.

Forming part of the Qualifying Person criteria, Terms and Conditions apply.

ENTRANCE HALL

Access to the property via communal entrance, intercom entry. The property is located on the middle floor. Door to hall and 3 x storage cupboards, one with plumbing for washing machine.

KITCHEN/LOUNGE/DINER

11' 0" x 20' 9" (3.37m x 6.33m)

Spacious light and airy living/dining area, featuring 3 x windows providing lots of natural light. Kitchen area fitted with a range of modern cream wall and base units with complementary worktops, electric oven and gas hob, stainless steel sink with mixer tap and drainer, space for fridge freezer. Vinyl floor.

BEDROOM ONE

11' 1" x 11' 3" (3.40m x 3.45m)

Double bedroom. Door to en suite.

EN SUITE

4' 9" x 7' 4" (1.47m x 2.25m)

Featuring a double shower cubicle with electric shower, WC and wash hand basin. Vinyl floor. Part tiled walls. Heated towel rail.

BEDROOM TWO

8' 8" x 11' 3" (2.65m x 3.44m)

Double bedroom.

BATHROOM

6' 10" x 6' 5" (2.09m x 1.96m)

Featuring a three piece white suite of bath, WC and wash hand basin. Heated towel rail. Part tiled walls. Vinyl floor.

OUTSIDE

Private parking space.



ADDITIONAL INFORMATION

Tenure: Leasehold

Council Tax Band: A

Ground Rent: £49 pa

Service charges are approx. £750 bi annually

Forming part of the Qualifying Person criteria, Terms and Conditions apply.

DIRECTIONS

From our Birkenshaw office head south east on Old Lane towards Royds Walk turn right on Whitehall Road/(A58) at the roundabout take the first exit onto Heathfield Lane where the property will be identified on the right.

