

# Alderney Avenue

BRISLINGTON

APPROXIMATE FLOOR AREA  
69.0 SQM / 742 SQFT



GROUND FLOOR



FIRST FLOOR

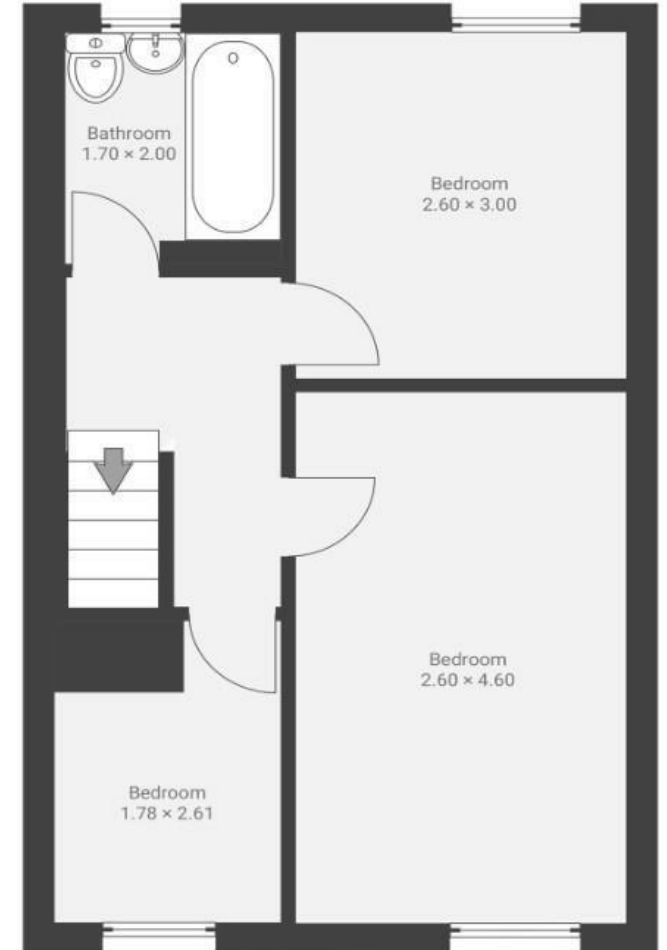

Illustrations are for reference purposes only, measurements are approximate, not to scale.

**Boardwalk**

# Alderney Avenue

BRISLINGTON, BRISTOL



£300,000



3 Bedrooms



BS4 4SF



2 Bathrooms

*"I love living in a detached house at the end of quiet cul-de-sac in Brislington. It's great being able to take daily walks to Nightingale valley and Eastwood farm, and it's a really calm location to live and work from home. But since it's also so close to the co-op, and just a short bus ride to the city centre, it feels like a great balance between quietness while still being really connected to the rest of the city."*

