



Williams Way, Manea PE15 0HU

welcome to
Williams Way, Manea

**** Calling All First Time Buyers / Investors **** Village Life for You ! Two Bedroom Semi Detached House **
NO ONWARD CHAIN ** Village of Manea - Enclosed Rear Garden with Field Views - Side Drive for Off Road Parking



Entrance Door
to

Hall
Stairs leading off.

Lounge
15' 7" plus recess x 8' 9" (4.75m plus recess x 2.67m)
Window to front. Electric radiator. Understairs storage cupboard. Laminate flooring. TV and telephone point.

Kitchen
12' x 8' 1" (3.66m x 2.46m)
Window to rear. Door to rear. Range of wall cupboards and base units with tiled splashbacks. Single drainer sink with mixer taps. Free standing over with cooker hood above. Laminate flooring. Free standing appliances.

Stairs To First Floor Landing

Bedroom One

12' x 7' 8" (3.66m x 2.34m)
Window to front. Storage cupboard housing hot water cylinder.

Bedroom Two

11' 11" x 9' 1" max (3.63m x 2.77m max)
(8ft 11ins min) Window to rear.

Bathroom

Window to side. Panelled bath with mixer taps and electric shower over. Tiled around. Low level wc. Pedestal wash hand basin. Tiled floor. Shaver point.

Outside

Front garden has side driveway for off road parking. Gravelled area and path to front door .

Rear garden is enclosed with patio seating areas. Outside tap. Gated side access and mostly laid to grass.

Agents Note

Heating to the property is served by Electric, Please contact the branch for more details.



view this property online williamhbrown.co.uk/Property/MCH113937



welcome to

Williams Way, Manea

- Semi Detached House
- Two Bedrooms
- Double Glazed Windows
- Electric Heating
- Village Location
- Off Road Parking
- Field Views
- NO ONWARD CHAIN

Tenure: Freehold EPC Rating: D
Council Tax Band: B

offers in excess of

£160,000

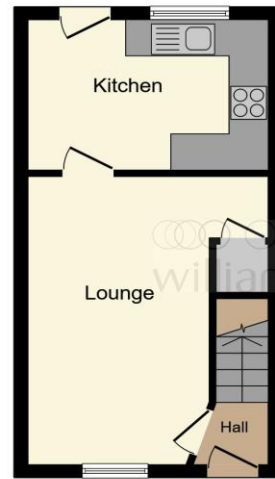

Ground Floor

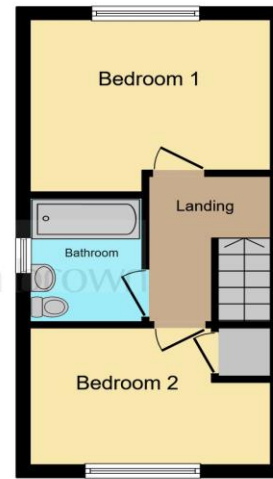

First Floor

This floor plan is for illustrative purposes only. It is not drawn to scale. Any measurements, floor areas (including any total floor area), openings and orientation are approximate. No details are guaranteed, they cannot be relied upon for any purpose and they do not form part of any agreement. No liability is taken for any error, omission or misstatement. A party must rely upon its own inspection(s). Powered by www.focalagent.com



Please note the marker reflects the
postcode not the actual property

view this property online williamhbrown.co.uk/Property/MCH113937



Property Ref:
MCH113937 - 0004

1. MONEY LAUNDERING REGULATIONS Intending purchasers will be asked to produce identification documentation at a later stage and we would ask for your co-operation in order that there is no delay in agreeing the sale. 2. These particulars do not constitute part or all of an offer or contract. 3. The measurements indicated are supplied for guidance only and as such must be considered incorrect. Potential buyers are advised to recheck measurements before committing to any expense. 4. We have not tested any apparatus, equipment, fixtures or services and it is in the buyers interest to check the working condition of any appliances. 5. Where an EPC, or a Home Report (Scotland only) is held for this property, it is available for inspection at the branch by appointment. If you require a printed version of a Home Report, you will need to pay a reasonable production charge reflecting printing and other costs. 6. We are not able to offer an opinion either written or verbal on the content of these reports and this must be obtained from your legal representative. 7. Whilst we take care in preparing these reports, a buyer should ensure that his/her legal representative confirms as soon as possible all matters relating to title including the extent and boundaries of the property and other important matters before exchange of contracts.

William H Brown is a trading name of Sequence (UK) Limited which is registered in England and Wales under company number 4268443, Registered Office is Cumbria House, 16-20 Hockliffe Street, Leighton Buzzard, Bedfordshire, LU7 1GN. VAT Registration Number is 500 2481 05.



william h brown



01354 654545



march@williamhbrown.co.uk



34 High Street, MARCH, Cambridgeshire, PE15 9JR



williamhbrown.co.uk