



## 143 Sovereign Road, Coventry, CV5 6JB

\*\*\* AVAILABLE NOW \*\*\* This well-presented two-bedroom terraced home is located on Sovereign Road in the highly sought-after area of Earlsdon, Coventry, offering excellent access to local amenities, schools, and Coventry City Centre.

The property comprises a bright front living room, a second reception/dining room, and a modern fitted kitchen with oven and hob. Upstairs offers two well-proportioned bedrooms and a contemporary family bathroom with bath, shower over, WC and sink.

Externally, the property benefits from a private rear garden and on-street parking.

Offered UNFURNISHED. Council Tax Band D. Energy Rating A.

- Available Now
- Earlsdon, Coventry
- Terraced House
- Two Bedrooms
- Modern Kitchen
- On Street Parking
- Council Tax Band A
- Energy Rating D

**£850 PCM**

## Ground Floor

Approx. 37.7 sq. metres (406.2 sq. feet)

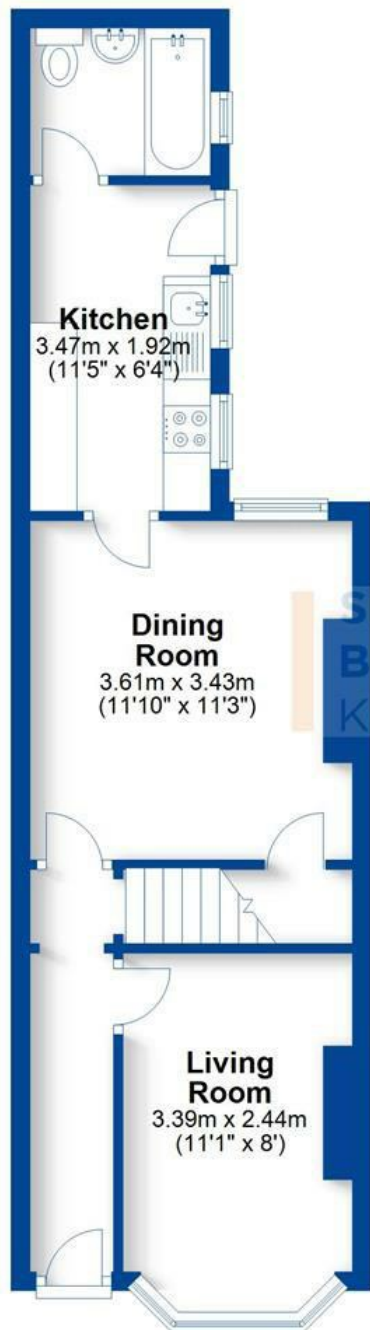

## First Floor

Approx. 27.4 sq. metres (295.0 sq. feet)



Total area: approx. 65.1 sq. metres (701.2 sq. feet)

This plan is for illustration purposes only and should not be relied upon as a statement of fact

Energy Efficiency Rating		Current	Potential
Very energy efficient - lower running costs			
(92 plus) <b>A</b>			
(81-91) <b>B</b>			
(69-80) <b>C</b>			
(55-68) <b>D</b>			
(39-54) <b>E</b>			
(21-38) <b>F</b>			
(1-20) <b>G</b>			
Not energy efficient - higher running costs			
England & Wales		59	80
EU Directive 2002/91/EC			

Environmental Impact (CO <sub>2</sub> ) Rating		Current	Potential
Very environmentally friendly - lower CO <sub>2</sub> emissions			
(92 plus) <b>A</b>			
(81-91) <b>B</b>			
(69-80) <b>C</b>			
(55-68) <b>D</b>			
(39-54) <b>E</b>			
(21-38) <b>F</b>			
(1-20) <b>G</b>			
Not environmentally friendly - higher CO <sub>2</sub> emissions			
England & Wales			
EU Directive 2002/91/EC			



**SCAN HERE TO REGISTER YOUR INTEREST**



29 Warwick Row, Coventry, West Midlands, CV1 1DY  
Tel: 02476 635555 Email: coventry@sbklettings.co.uk



- RURAL
- SALES
- LETTINGS
- PLANNING & ARCHITECTURAL
- COMMERCIAL
- SURVEYS & VALUATIONS
- NEW HOMES
- BLOCK MANAGEMENT