



Connells

Queensgate
Aylesbury



Property Description

Connells are delighted to present this beautifully re-decorated, chain-free mid-terraced home, located in the highly sought-after Fairford Leys village.

The property has been freshly updated throughout, boasting new carpets and vinyl flooring, giving it a bright and modern feel.

Inside, the home offers a spacious reception room, a well-appointed fitted kitchen, two double bedrooms, and a family bathroom suite. Additional benefits include a boarded loft, a landscaped rear garden, one allocated parking space, and unrestricted on-street parking for visitors.

Ideally positioned, the property is just moments from St Mary's Primary School, Bright Stars Nursery, Hampden Square, and a wide selection of local amenities.

This chain-free property is ready to move straight into.

For more information or to arrange a viewing, please contact Connells today.

Entrance

Front door into living room,

Living Room

15' 9" MAX x 11' 6" MAX (4.80m MAX x 3.51m MAX)

Window to front aspect, television point, telephone point, stairs to first floor landing, radiator.

Kitchen

11' 6" x 8' 10" (3.51m x 2.69m)

Fitted kitchen comprised of wall and base units, window to rear aspect, sink with drainer, electric oven, gas hob with extractor hood, plumbing for washing machine and dishwasher, space for under-counter fridge/freezer, door to rear garden.

First Floor Landing

Access to boarded loft.

Bedroom One

11' 6" x 9' 2" (3.51m x 2.79m)

Two windows to rear aspect, radiator.

Bedroom Two

11' 6" x 7' 3" (3.51m x 2.21m)

Two windows to front aspect, radiator.

Bathroom

Bath with mixer taps and overhead shower, WC, wash hand basin, heated towel rail, cupboard housing boiler/storage.

Outside

Parking

One allocated parking space.

Rear Garden

Landscaped rear garden, recently updated decking area, artificial grass, rear access, shed.







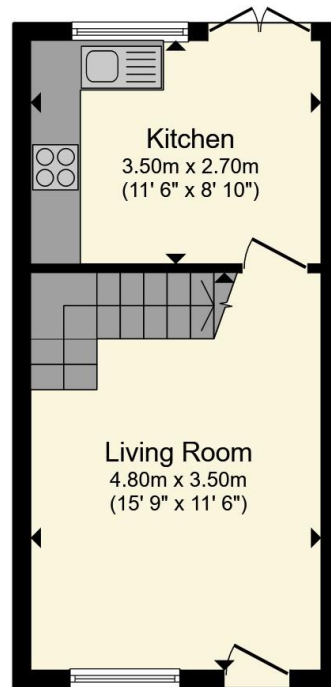

Ground Floor

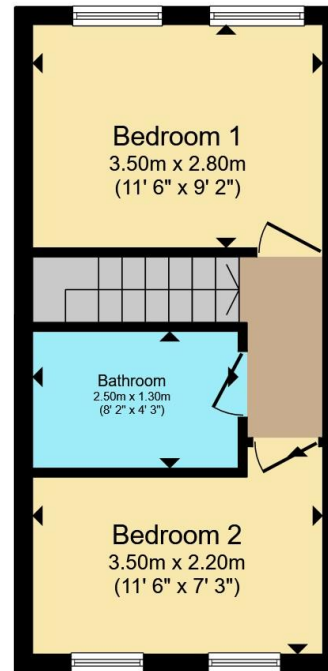

First Floor

Total floor area 53.2 m² (573 sq.ft.) approx

This floor plan is for illustrative purposes only. It is not drawn to scale. Any measurements, floor areas (including any total floor area), openings and orientation are approximate. No details are guaranteed, they cannot be relied upon for any purpose and they do not form part of any agreement. No liability is taken for any error, omission or misstatement. A party must rely upon its own inspection(s). Powered by www.propertybox.io



To view this property please contact Connells on

T 01296 395710
E fairfordleys@connells.co.uk

6 Hampden Square
 AYLESBURY HP19 7HT

EPC Rating: C Council Tax Band: C

Tenure: Freehold

view this property online connells.co.uk/Property/LEY304652



1. MONEY LAUNDERING REGULATIONS Intending purchasers will be asked to produce identification documentation at a later stage and we would ask for your co-operation in order that there will be no delay in agreeing the sale. 2. These particulars do not constitute part or all of an offer or contract. 3. The measurements indicated are supplied for guidance only and as such must be considered incorrect. Potential buyers are advised to recheck measurements before committing to any expense. 4. We have not tested any apparatus, equipment, fixtures, fittings or services and it is in the buyers interest to check the working condition of any appliances.

Connells Residential is registered in England and Wales under company number 1489613, Registered Office is Cumbria House, 16-20 Hockliffe Street, Leighton Buzzard, Bedfordshire, LU7 1GN. VAT Registration Number is 500 2481 05.

See all our properties at www.connells.co.uk | www.rightmove.co.uk | www.zoopla.co.uk

Property Ref: LEY304652 - 0008