



Bankside Close, TW7

£530 pw (£2,400 pcm)

Situated within a sought-after private development between Isleworth and Twickenham, this well-presented three-bedroom home offers bright, well-proportioned accommodation throughout. The property features a spacious reception room, modern kitchen with access to a large private garden, and a convenient downstairs WC. Upstairs are three bedrooms and a family bathroom



The house benefits from a downstairs WC, three bedrooms on the first floor, private garage and space for two further cars in the driveway. Further benefits include a private garage and driveway parking for two cars.

Ideally located just off Twickenham Road, with easy access to the amenities of Isleworth and St Margarets

- Three Bedroom House • Large Private Garden • Separate Living Room •
- Eat In Kitchen • Private Garage • Driveway Parking •



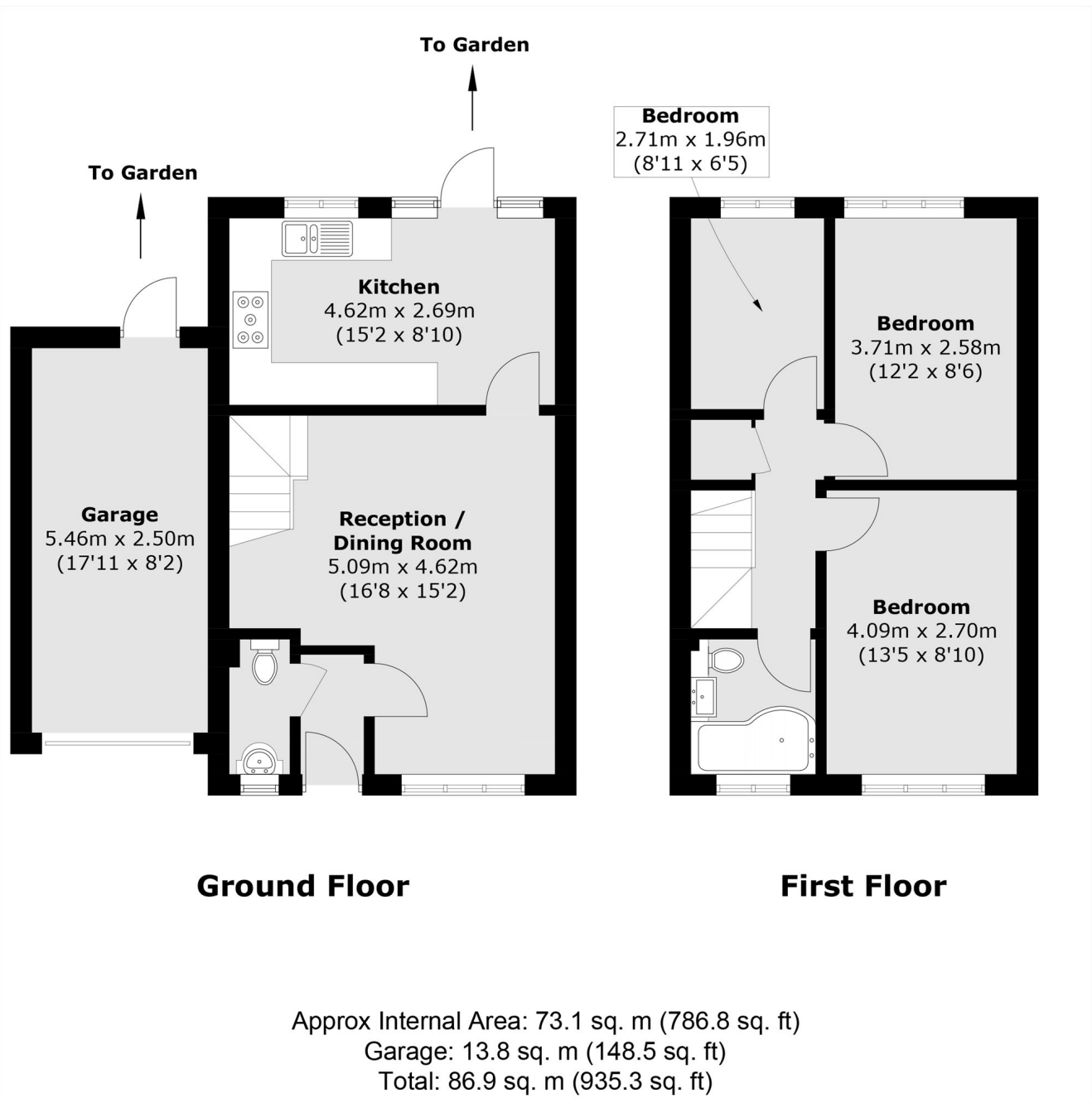

Robertson Smith & Kempson Acton Lettings
137 High Street,
Acton, London, W3
020 8896 3967
actonlettings@robertsonsmithandkempson.co.uk

Energy Rating: . We aim to make our particulars both accurate and reliable. However they are not guaranteed; nor do they form part of an offer or contract. If you require clarification on any points then please contact us, especially if you're traveling some distance to view. Please note that appliances and heating systems have not been tested and therefore no warranties can be given as to their good working order.