



## Chelsea Cloisters, SW3

£225,000

A studio apartment located within a portered building. This property is positioned on the eighth floor (with lift) and would work very well as a rental investment or London base.

Chelsea Cloisters is located between Sloane Square and South Kensington tube stations. The world famous shops and restaurants the King's Road have to offer are also within walking distance.

### Features

- Studio Apartment
- Leasehold
- Porters
- Popular Location
- Lift
- Ideal Rental Investment

# Chelsea Cloisters, London, SW3

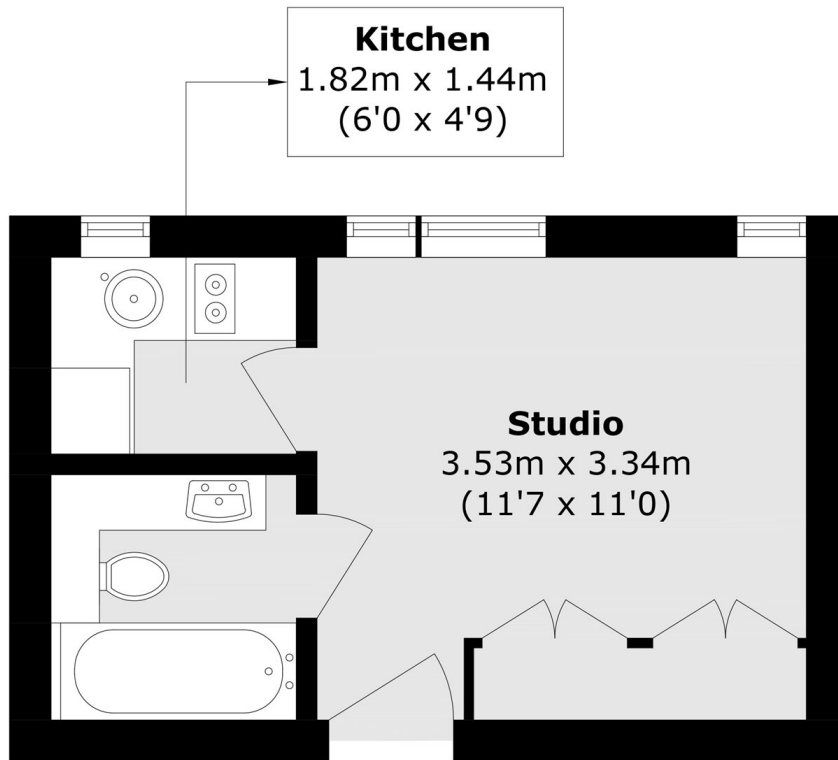

## Eighth Floor

Total area (approx.): 18.2 sq. m (195.9 sq. ft)