



TO
LET

91 St. Pauls Road, Hemel Hempstead
£1,650 pcm

squire | estates

91 St. Pauls Road

Hemel Hempstead, Hemel Hempstead

Modern two bedroom semi-detached house near town centre with spacious lounge, stylish kitchen, family bathroom, gas central heating, and double glazing. Ideal for first-time buyers.

Council Tax band: C

EPC Energy Efficiency Rating: D

EPC Environmental Impact Rating: D

- Two Bedroom Semi Detached House
- Gas Central Heating & Double Glazing
- Modern Kitchen Incl. Appliances
- Private Rear Garden
- Close to Town Centre.



squire | estates

67 Marlowes, Hemel Hempstead
Hertfordshire HP1 1LE
t. 01442 233533

www.squireestates.co.uk

Ground Floor

Approx. 28.4 sq. metres (305.3 sq. feet)

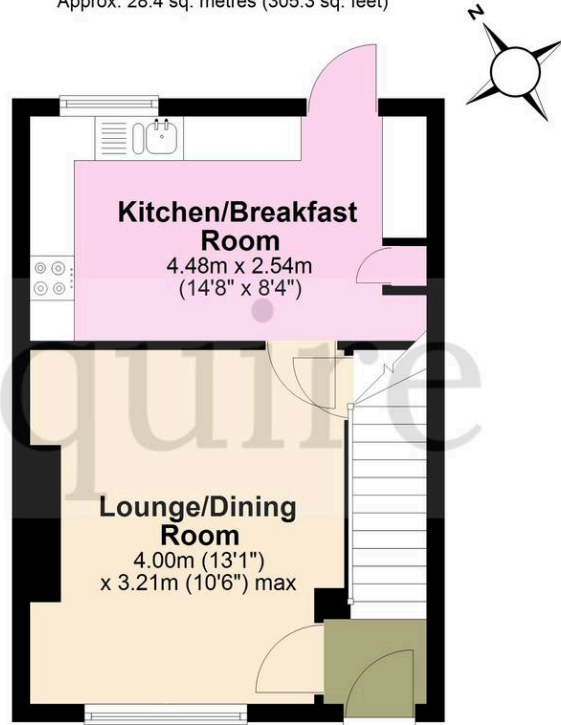

First Floor

Approx. 29.7 sq. metres (319.8 sq. feet)

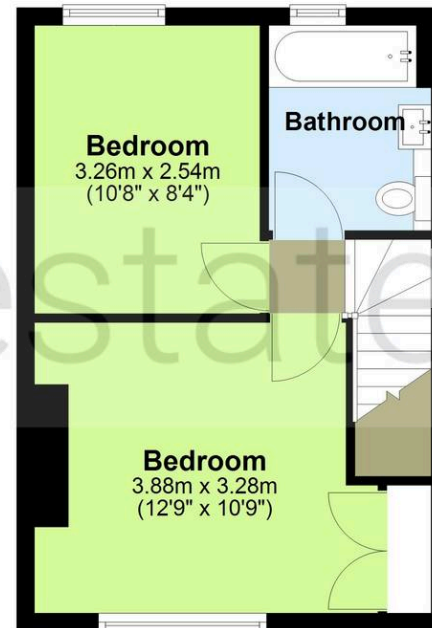

Total area: approx. 58.1 sq. metres (625.1 sq. feet)

The Floor Plan is not to Scale and measurements and areas shown are approximate and therefore should be used for illustrative purposes only. The plan has been prepared with due diligence and whilst we have confidence in the information produced it should not be relied upon. Maximum lengths and widths are represented on the plan. If there are any aspects of particular importance, you should carry out or commission your own inspection of the property. Copyright © SKMSTUDIO
Plan produced using PlanUp.□