



7, Burberry Court Burberry Court
Littleport, Littleport, CB6 1GZ
£895 Per annum

7, Burberry Court Burberry Court, Littleport, Littleport, CB6 1GZ

Two story one-bedroom house available exclusively with OpenArch! Forming part of the Burberry Court development, this property has its own private entrance and is one of only two terraced houses attached to this development.

Inside you'll find vintage style windows coupled with exposed beams in the lounge adding to its rustic charm! The skylight windows in the kitchen add a touch of modernity and bring in more natural lighting, brightening and opening up the space!

This property comes with one allocated parking space within the gated parking area accessible only to tenants via a key fob entry system.

This property is unfurnished, allowing its new tenant to add their own unique style and personalized touches. For ease, white goods are included in the rent.

Contact OpenArch to arrange a viewing.



Credit References and Deposit

Prospective tenants will be required to complete a credit referencing application payable whether successful or not. Prior to taking occupation of the property you will be required to pay a deposit of 1½ times the monthly rent, the first months rent in advance and an administration fee.

The Grange Market Street, Swavesey, Cambridgeshire, CB24 4QG
Tel: 01223 664200 Email: enquiries@openarch.co.uk www.openarch.co.uk

Area Map



Floor Plan

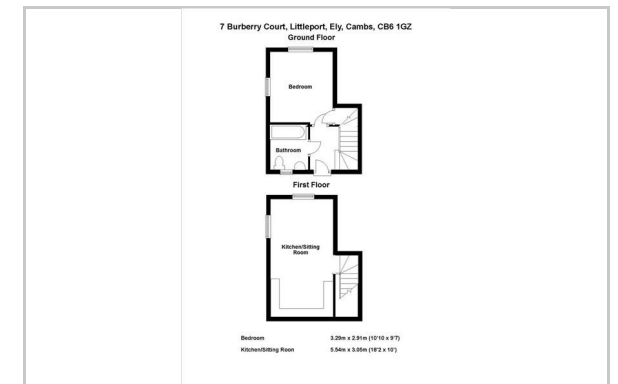

Energy Efficiency Graph

