

JENNIE JONES

EST. 1993

ESTATE AGENTS



POST OFFICE ROAD

Knodishall | Suffolk

£165,000

2 POST OFFICE ROAD, KNODISHALL, SAXMUNDHAM, IP17 1UG

A CHARMING SUFFOLK COTTAGE WITH HUGE POTENTIAL

Saxmundham - 4 miles
Aldeburgh - 4 miles
Sizewell - 3 miles

- Sitting Room
- Kitchen
- One Bedroom
- Family Bathroom
- Enclosed Garden
- Small Outbuilding





The Property

A charming one-bedroom cottage offering an exciting opportunity for renovation and improvement, tucked away within the popular village of Knodishall.

The accommodation comprises a sitting room to the front aspect, leading through to a kitchen/dining room overlooking the rear garden. To the first floor is a generous double bedroom and bathroom accessed from the landing.

Outside, the property enjoys both front and rear gardens, with the rear courtyard garden benefiting from a useful brick built shed/store. The cottage now offers purchasers the chance to update and personalise the accommodation to their own tastes and requirements.



Further benefits include oil-fired central heating via radiators.

Location

Knodishall is a highly regarded Suffolk village situated close to the Heritage Coast, offering a wonderful balance of countryside surroundings and convenient access to nearby coastal towns. The village itself benefits from a popular public house, village hall and strong sense of community, while nearby Aldeburgh, Leiston and Saxmundham provide a wider range of amenities and transport links.

Services

Mains water, drainage and electricity.
Oil fired central heating via radiators.

Local Authority and Council Tax Band

East Suffolk Council - Council Tax Band A

EPC Rating

D



Ground Floor

Approx. 23.1 sq. metres (248.3 sq. feet)

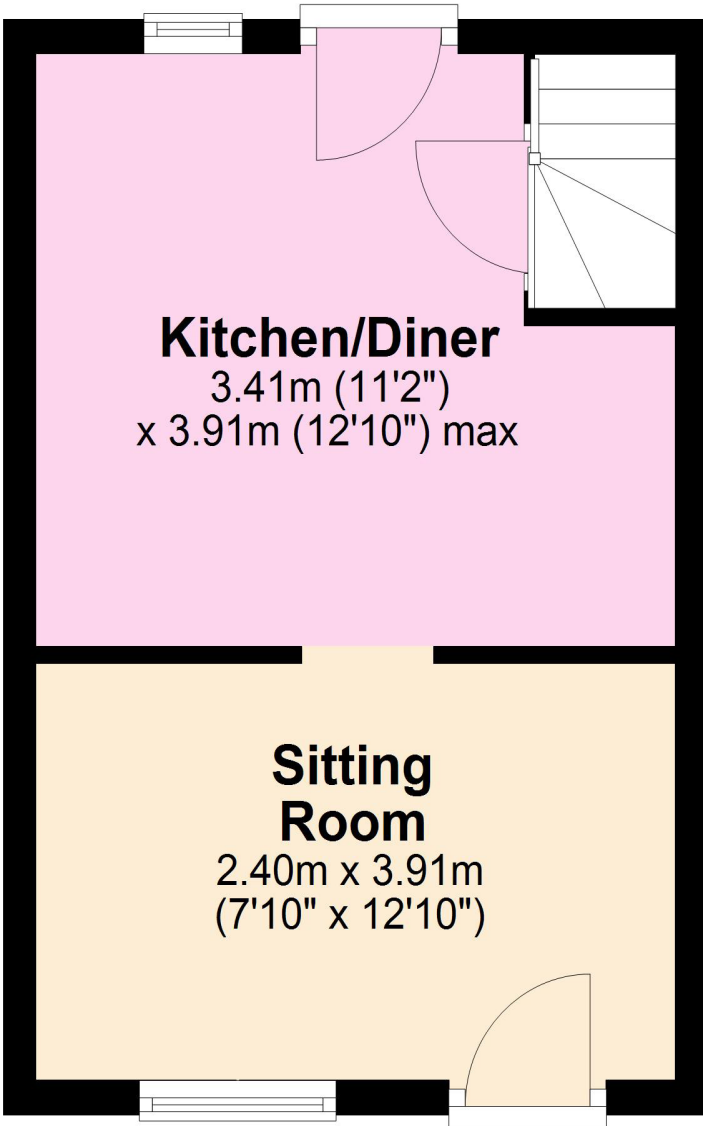
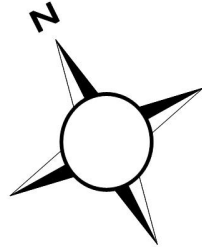

First Floor

Approx. 23.1 sq. metres (248.3 sq. feet)

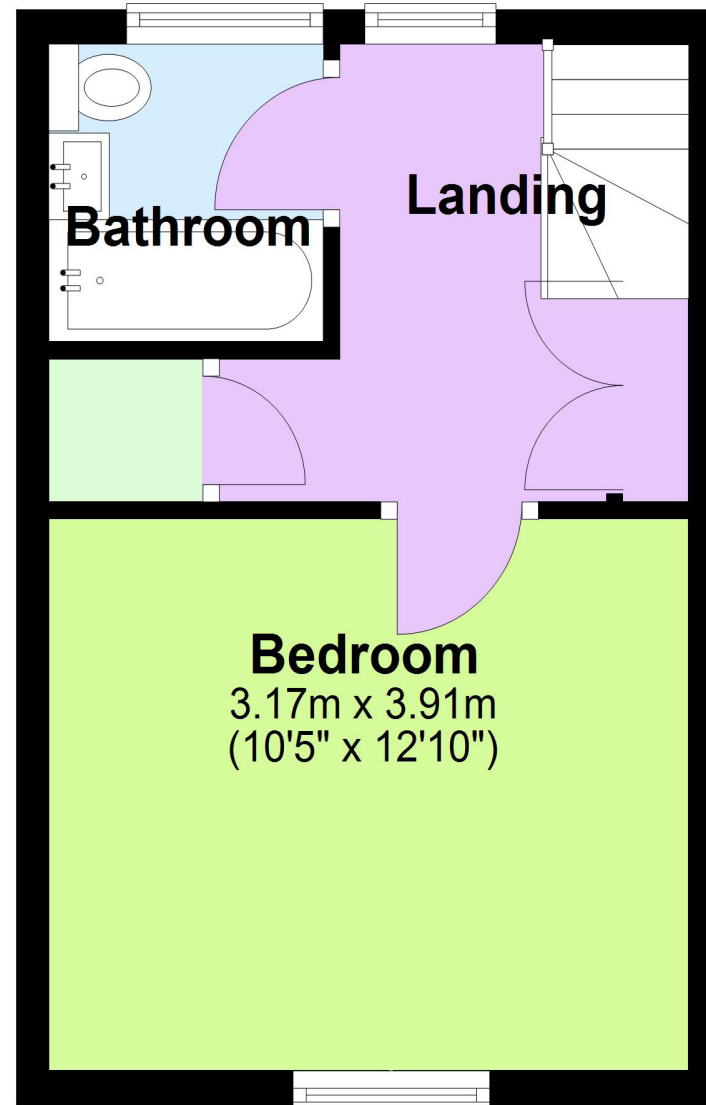

Jennie Jones

26 High Street
Saxmundham
Suffolk
IP17 1AB

www.jennie-jones.com

01728 605511

All enquiries:

saxmundham@jennie-jones.com



Scan the QR code to
visit our website

rightmove

OnTheMarket



Total area: approx. 46.1 sq. metres (496.6 sq. feet)