

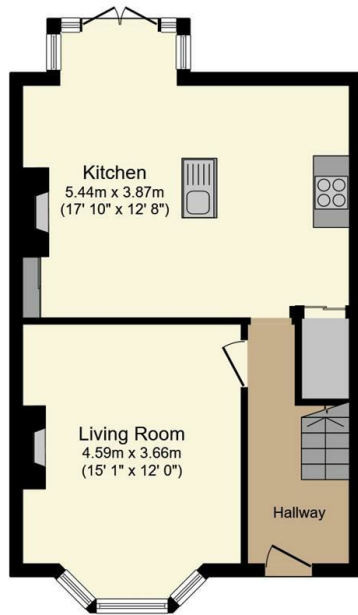

8 Greenhill Road, Sheffield, S8 0BA

Offers Over £300,000

- Unique mid-terrace
- Entrance hallway
- Quiet location
- In the catchment area for good schools
- Stunning open plan dining kitchen
- Three bedrooms
- Short walk to local shops, cafes, pubs and restaurants
- Cosy living room
- Enclosed south-west facing rear garden
- Easy access to the city centre and M1 via A61



Ground Floor
Floor area 46.1 sq.m. (496 sq.ft.)

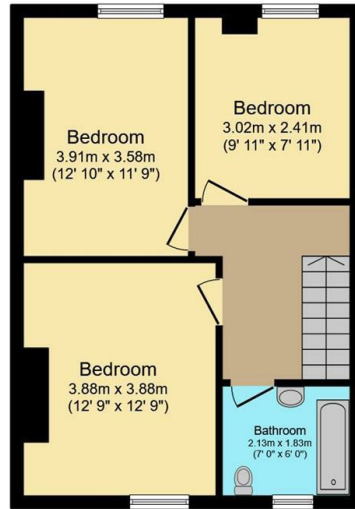

First Floor
Floor area 43.3 sq.m. (466 sq.ft.)

Total floor area: 89.4 sq.m. (963 sq.ft.)

This floor plan is for illustrative purposes only. It is not drawn to scale. Any measurements, floor areas (including any total floor area), openings and orientations are approximate. No details are guaranteed, they cannot be relied upon for any purpose and do not form any part of any agreement. No liability is taken for any error, omission or misstatement. A party must rely upon its own inspection(s). Powered by www.Propertybox.io

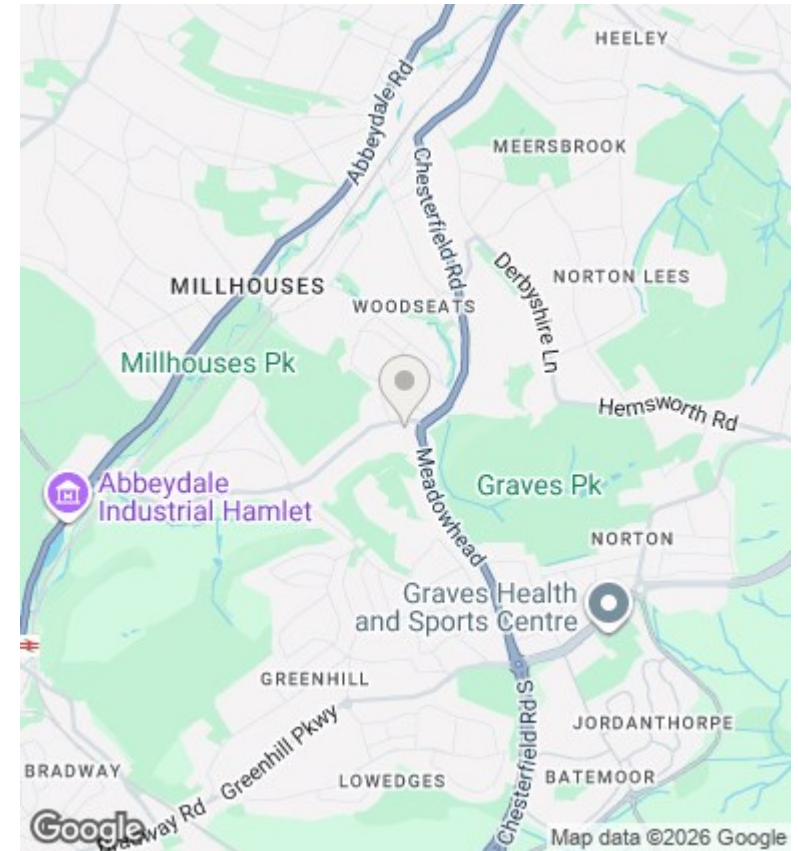

Directions

Viewings

Viewings by arrangement only. Call 01142 687777 to make an appointment.

Council Tax Band

C

EPC Rating:

D

Energy Efficiency Rating		Current	Potential
<i>Very energy efficient - lower running costs</i>			
(92 plus) A			
(81-91) B			
(69-80) C			77
(55-68) D		56	
(39-54) E			
(21-38) F			
(1-20) G			
<i>Not energy efficient - higher running costs</i>			
England & Wales		EU Directive 2002/91/EC	