



JOSHUA JAMES

ESTATE AGENTS

Rowan Gardens, Gamlingay SG19 3LU

Asking Price £325,000

 2  1  1

- Semi Detached Bungalow
- Large L Shaped Lounge / Dining Room
- Fitted Kitchen
- Two Double Bedrooms
- Fully Tiled Shower Room
- Ample Storage Throughout
- Enclosed Private Rear Garden • Driveway / Carport Parking
- Single Garage with Electric Roller Door
- No Forward Chain



Discover this beautifully presented two-bedroom semi detached bungalow, perfectly situated to enjoy both comfort and convenience. The property boasts a spacious L-shaped lounge/dining room, a well-appointed kitchen, two comfortable bedrooms, and a modern shower room, all maintained to a high standard.

The exterior offers a delightful rear garden with a patio and lawn, providing a private outdoor space, while the front features a neat lawn and a driveway leading to a covered carport and a single garage, ensuring ample off-street parking.

Located on the popular Green Acres development in Gamlingay, the property benefits from easy access to local amenities and offers excellent transport links, making it an ideal home for a discerning buyer.





GROUND FLOOR
760 sq. ft. (70.6 sq.m.) approx.

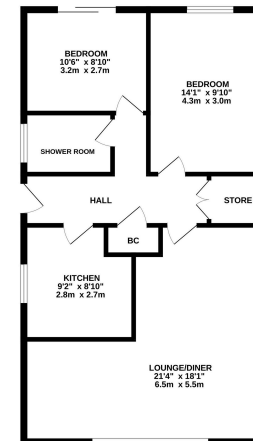

TOTAL FLOOR AREA: 760 sq.ft. (70.6 sq.m.) approx.
We warrant that the information contained in this floor plan is a true and accurate representation of the property as it exists at the time of completion of the contract. We do not warrant that the information contained in this floor plan is a true and accurate representation of the property as it exists at the time of completion of the contract. We do not warrant that the information contained in this floor plan is a true and accurate representation of the property as it exists at the time of completion of the contract.