

TAYLOR
MICHAEL

SALES & LETTINGS



1 Bed
Flat - Purpose Built
located in

£1,250 Per month



TAYLOR
MICHAEL

Totland Road, Brighton, BN2 3EN

Approximate Gross Internal Area = 37.0 sq m / 398 sq ft

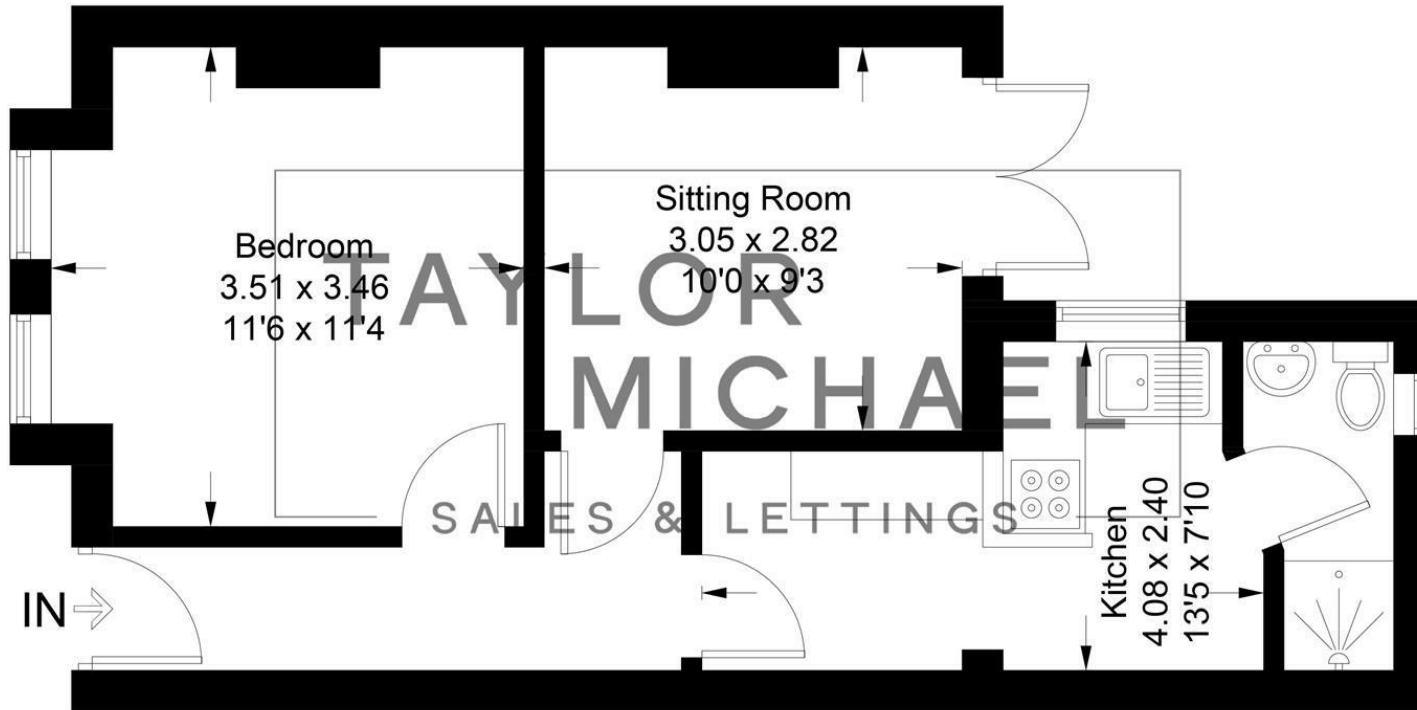

Lower Ground Floor

Illustration for identification purposes only, measurements are approximate, not to scale.
Imageplansurveys @ 2026

Energy Efficiency Rating		
	Current	Potential
Very energy efficient - lower running costs		
(92 plus) A		
(81-91) B		
(69-80) C		75
(55-68) D	60	
(39-54) E		
(21-38) F		
(1-20) G		
Not energy efficient - higher running costs		
England & Wales	EU Directive 2002/91/EC	

DIRECTIONS

CONTACT

62 Church Road
Hove
East Sussex
BN3 2FP

E: lettings@taylormichael.agency
T: 01273 600100
<https://taylormichael.agency/>

TAYLOR MICHAEL