







## 15 Romney Drive

Dronfield • Derbyshire • S18 1QQ

Guide Price £425,000 - £450,000

Tucked away at the foot of a quiet cul-de-sac on Romney Drive, Dronfield, within a highly sought-after residential development, this beautifully extended five-bedroom freehold bungalow offers bright, contemporary living perfectly suited to modern family life. Benefitting from a newly installed kitchen, wraparound garden, garage, and a generous driveway providing ample off-street parking, the property combines style, space, and practicality in an ideal family setting. The property is entered via a UPVC front door into a practical WC cloakroom—ideal for coats and everyday storage. From here, you are welcomed into a versatile and stylish family room, finished in bold contemporary décor with wood-effect flooring and a generous front-facing window that fills the space with natural light. Steps lead down to a cosy, sunken living area featuring dual-aspect windows, soft neutral tones, and a plush light grey carpet. Sliding patio doors open directly onto the rear garden, creating a seamless indoor-outdoor flow and allowing sunlight to pour into the room. The recently installed kitchen boasts a sleek, modern design, fitted within the space, while a side access door provides convenient entry to the garden and garage. An inner hallway leads to the sleeping accommodation, comprising four well-proportioned double bedrooms and a fifth single bedroom—ideal for a child's room or home office. Each bedroom enjoys a pleasant outlook over the surrounding garden and is decorated in neutral tones. The main bedroom is particularly spacious, benefitting from the rear extension. The family bathroom is fully tiled and fitted with a modern white suite, including twin hand wash basins and a shower over the bath. A useful storage cupboard houses the Vaillant boiler, and there is additional access to a fully insulated and boarded loft, providing excellent storage space. Externally, a block-paved driveway provides ample off-street parking. Secure gates lead to a wraparound garden, providing a high degree of privacy and a safe, enclosed environment for families. The garden features a generous garage, lawned areas with planted borders, and a paved patio complete with a pergola and attractive planting—perfect for relaxing or entertaining. Romney Drive is ideally located within the desirable town of Dronfield, renowned for its strong community feel and excellent local amenities. The area is particularly popular with families due to its well-regarded schools, convenient transport links to Sheffield and Chesterfield, and easy access to the nearby Peak District. Residents benefit from a variety of shops, supermarkets, parks, and leisure facilities, making this an attractive location for both families and professionals alike.





- Extended Detached Bungalow
- Quiet Cul-de-Sac Location
- 5 Bedrooms & Modern Bathroom
- Recently Installed Fitted Kitchen
- Flexible Open Plan Living Areas

- Popular Residential Area in S18
- Wraparound Enclosed Garden
- Driveway & Detached Garage
- Freehold
- Council Tax Band D, EPC Rating D





# 15 ROMNEY DRIVE

APPROXIMATE GROSS INTERNAL AREA = 113.2 SQ M / 1218 SQ FT

OUTBUILDING = 21.4 SQ M / 230 SQ FT

TOTAL = 134.6 SQ M / 1448 SQ FT

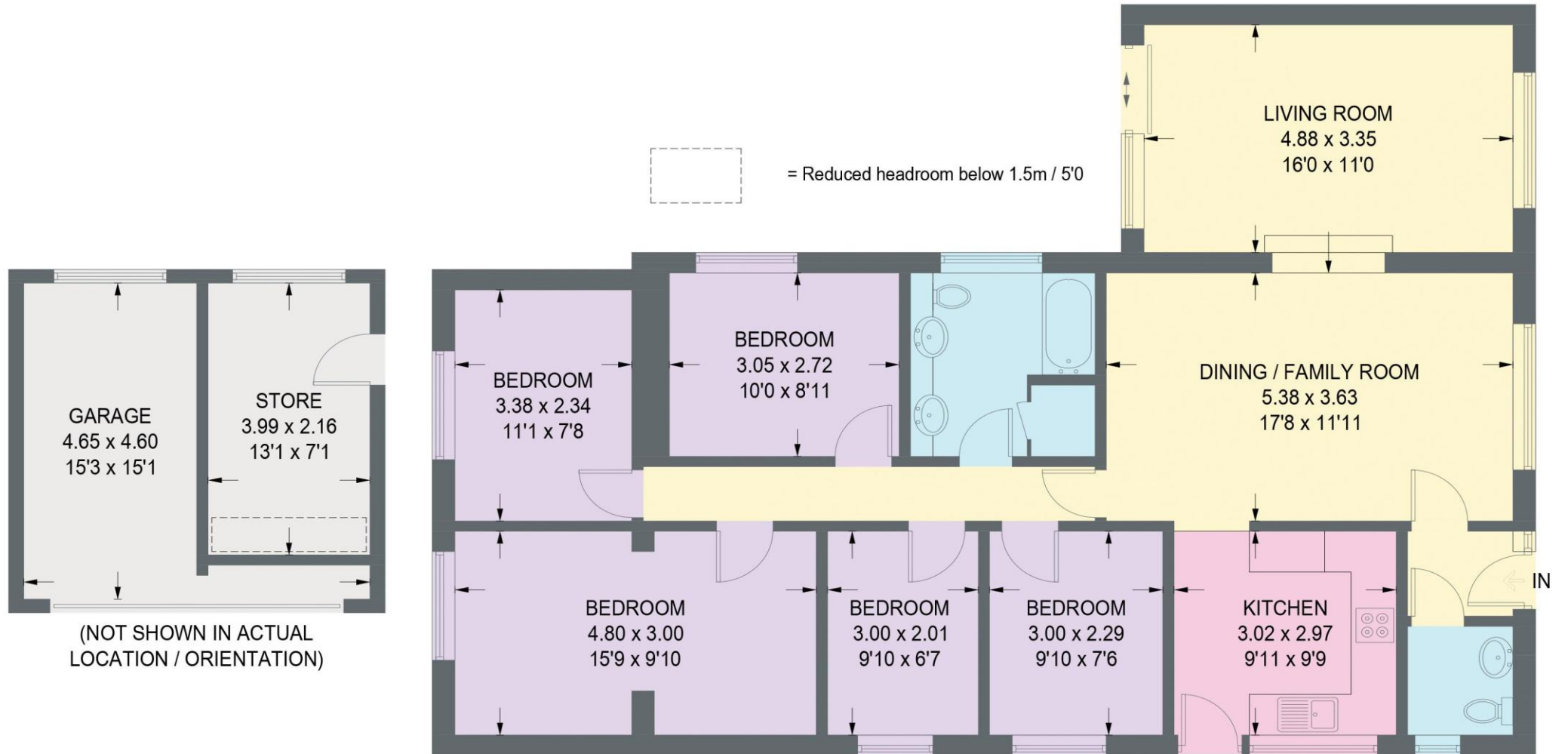

## GROUND FLOOR

Illustration for identification purposes only.  
measurements are approximate, not to scale.



**haus**

West Bar House, 137 West Bar, Sheffield, S3 8PU  
[hello@haushomes.co.uk](mailto:hello@haushomes.co.uk) [haushomes.co.uk](https://www.haushomes.co.uk)

0114 276 8868