

Dumpling House Dumpling Bridge Lane - £1,305 PCM

Lakenheath Brandon IP27 9JU

shires

Estate & Letting Agents



"Consistently providing outstanding service to our clients"

£1,305 PCM

The Property

Detached three bedroom spacious home located within the popular village of Lakenheath. The home is within walking distance of the local amenities and benefits from spacious accommodation throughout. Property has off road parking and a garage.

Features

- DETACHED HOUSE
- CLOSE TO RAF BASES
- 3 BEDROOMS
- OIL HEATING & ENERGY RATING - D
- SPACIOUS BEDROOM
- APPROXIMATE SIZE - 914 SQFT
- FAMILY BATHROOM & UTILITY
- COUNCIL TAX BAND - C
- GARAGE, PARKING & REAR GARDEN
- AVAILABLE LATE APRIL





These sales particulars have been produced as a general guide only and we would draw to your attention that we have not carried out a detailed Survey of the property nor have we tested services, appliances or specific fittings. Whilst measurements and statements given within the details are provided in good faith, their accuracy should not be relied upon. If there are any points about which you may be uncertain or would like further clarification, we would suggest that you telephone this office and speak to our staff who will endeavour to assist you.

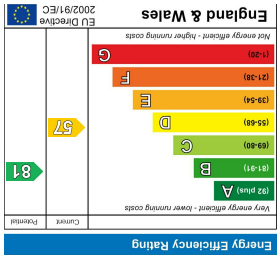

Whilst every attempt has been made to ensure the accuracy of the floorplan contained here, measurements of doors, windows, rooms and any other items are approximate and no responsibility is taken for any error, omission or mis-statement. This plan is for illustrative purposes only and should be used as such by any prospective purchaser. The services, systems and appliances shown have not been tested and no guarantee as to their operability or efficiency can be given.
 Made with Metropix ©2026

TOTAL FLOOR AREA: 75.6 sq.m. (814 sq.ft.) approx.



GROUND FLOOR 34.9 sq.m. (376 sq.ft.) approx.

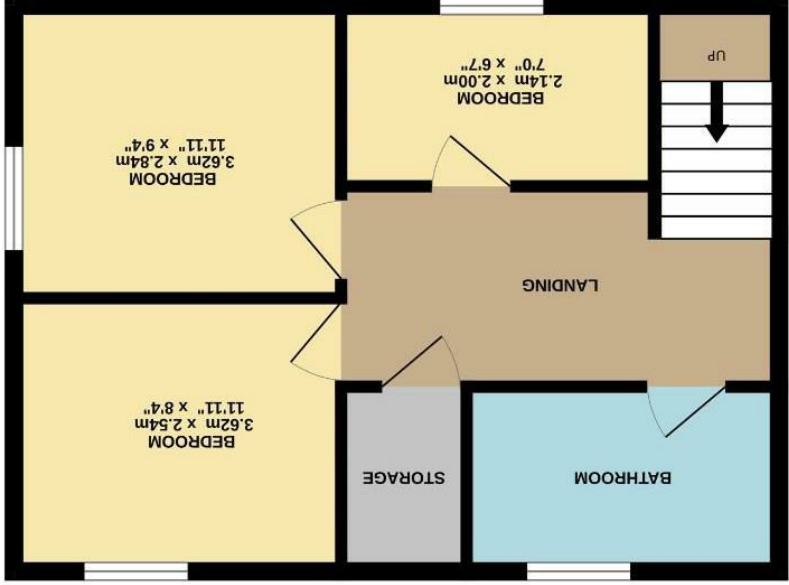

1ST FLOOR 40.8 sq.m. (439 sq.ft.) approx.