

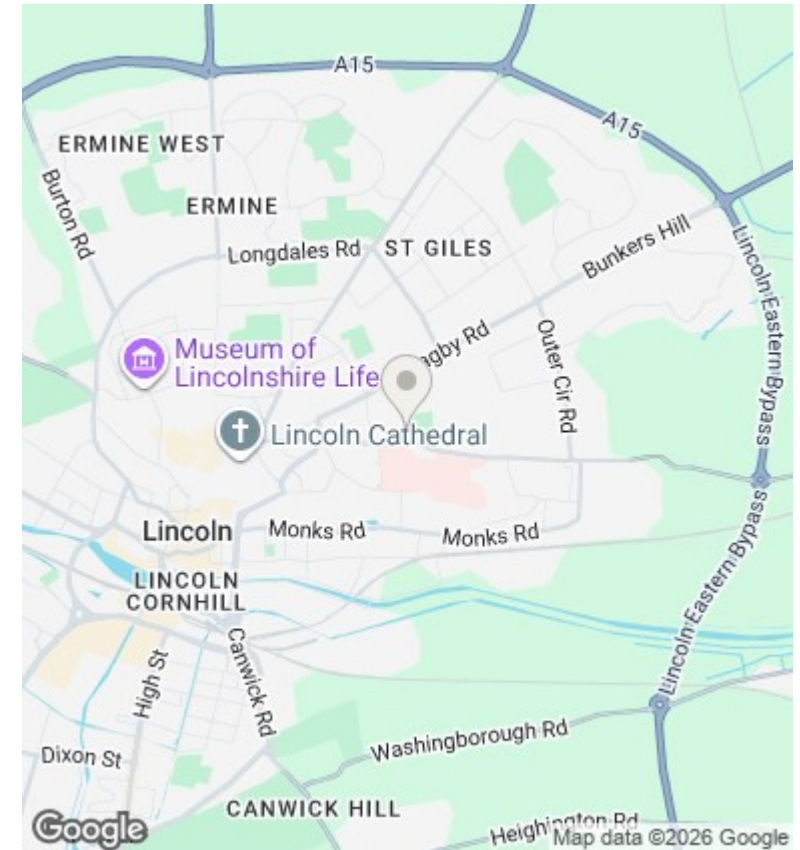

68-70 Greetwell Close, Lincoln, LN2 4BA

Asking Price £1,950,000

- Investment Opportunity
- Newly developed throughout
- All Flats EPC Rating C
- No onward Chain
- 11 x Fully Let Flats
- Allocated parking
- Close to Hospital and Uphill Lincoln
- Total gross rental income approx £124k
- Separate services for each flat
- 9 x 2 Beds and 2 x 1 Bed Flats

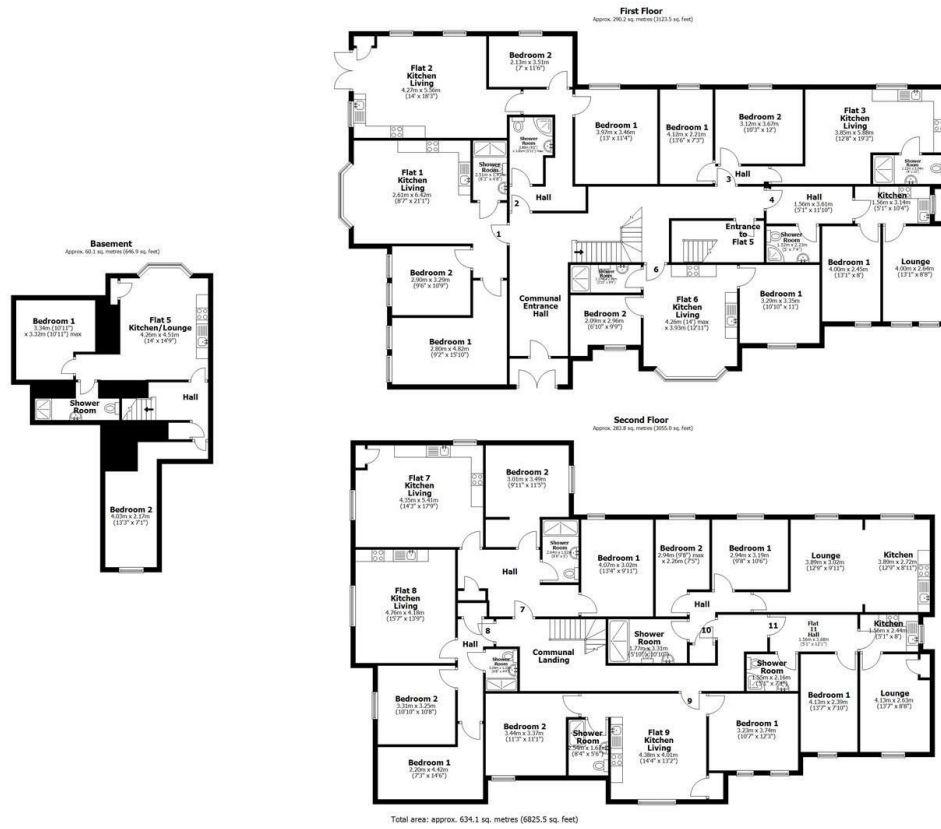

Directions

Viewings

Viewings by arrangement only. Call 01522 396059 to make an appointment.

Council Tax Band

EPC Rating:

Energy Efficiency Rating		Current	Potential
<i>Very energy efficient - lower running costs</i>			
(92 plus) A			
(81-91) B			
(69-80) C			
(55-68) D			
(39-54) E			
(21-38) F			
(1-20) G			
<i>Not energy efficient - higher running costs</i>			
England & Wales	EU Directive 2002/91/EC		