

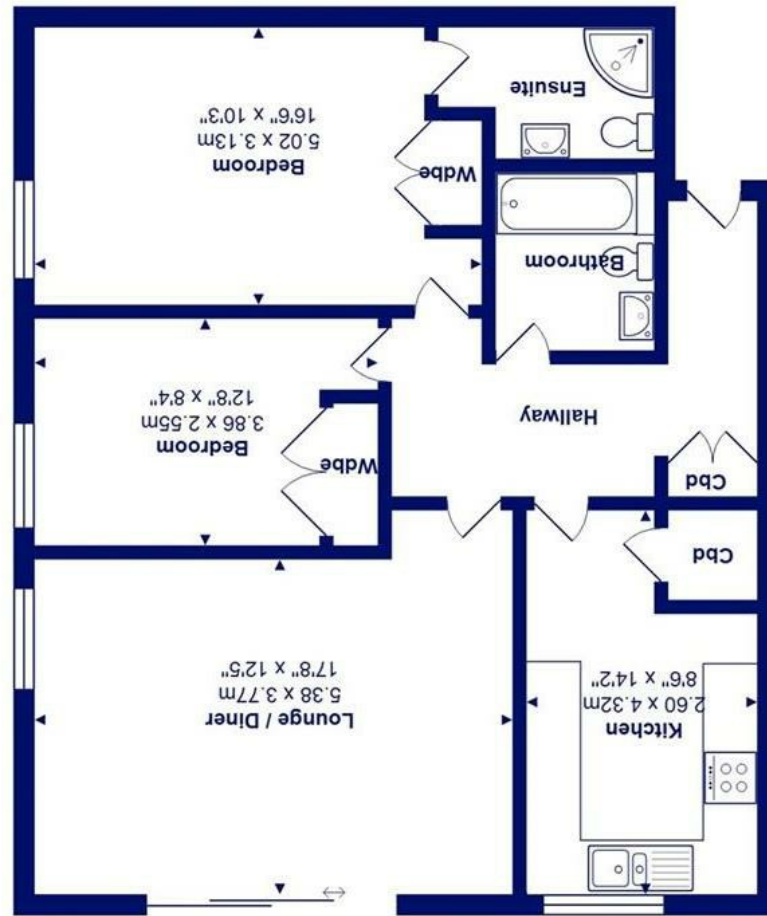

Total Area: 77.2 m<sup>2</sup> ... 831 ft<sup>2</sup>  
All measurements are approximate and for display purposes only



*58 Montagu Park Waterford Place, Highcliffe On Sea BH23* *£249,950*

**Mitchells**  
1963 — TODAY

This two double bedroom apartment is located on the forever sought after Montagu Park development, superb location within a short level walk of both Highcliffe beach and the high street. This property includes a spacious garage, located near your front door.

The property is very nicely presented throughout, with bright and airy rooms, situated on the first floor with south and westerly aspects overlooking the pleasant communal gardens. Offered for sale with a share in the freehold and no forward chain.

- Well presented throughout and kept immaculately
- Two double bedroom first floor apartment
- Two bathrooms, including an en-suite to the master bedroom
- Large lounge with south facing Juliette balcony
- Lots of storage including built in wardrobes in both bedrooms
- Allocated garage and additional communal parking bays
- Short walk to the beach and the shops
- Southerly outlook over the pleasant communal gardens from the principal rooms
- Share of freehold, thus no ground payable
- Maintenance approx £1600pa

EPC Rating Band: C  
Council Tax Band: C

